



£200,000



One Bedroom Flat

- Modern First Floor "Town Style" Flat
- One Bedroom
- Above Commercial Premises on Station Road
- No Onward Chain
- Double Glazing
- Electric Heating
- Entry Phone System
- Fitted Kitchen with oven & hob and washing machine
- Bathroom in white
- Very Convenient for Norwood Junction BR/Overground Station

Clock Tower Place, Station Road , South Norwood , SE25 5AJ

IN OUR OPINION IDEAL FOR TODAY'S MODERN LIVING A CONTEMPORARY FIRST FLOOR "TOWN" FLAT the property has ONE BEDROOM and is situated above commercial premises and very conveniently situated in Station Road with its eclectic mix of shops and cafe etc and of course Norwood Junction BR/Overground Station with its frequent trains to London being a few moments away. Brief benefits include DOUBLE GLAZING AND ENTRY PHONE SYSTEM also the added benefit of no onward chain. FITTED KITCHEN with oven, hob and washing machine along with a BATHROOM IN WHITE. This flat really must be viewed internally to be appreciated.

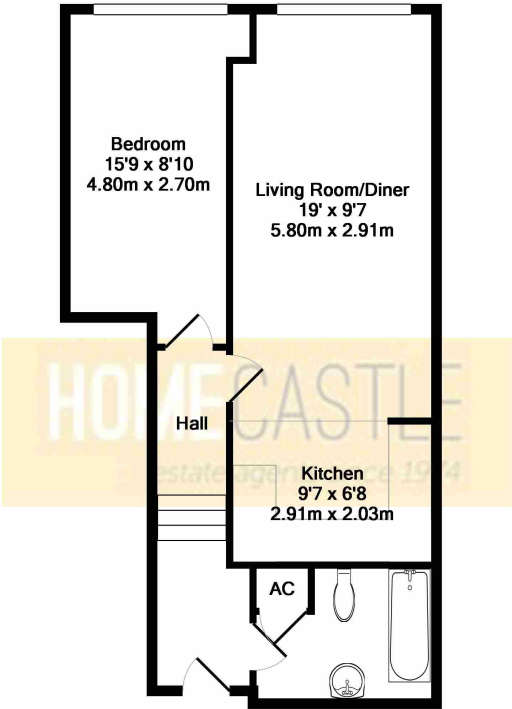

Total Approx. Floor Area 475 Sq.Ft. (44.2 Sq.M.)

Whilst every attempt has been made to ensure the accuracy of the floor plan contained here, measurements of doors, windows, rooms and any other items are approximate and no responsibility is taken for any error, omission, or mis-statement. This plan is for illustrative purposes only and should be used as such by any prospective purchaser. The services, systems and appliances shown have not been tested and no guarantee as to their operability or efficiency can be given
Made with Metropix ©2017

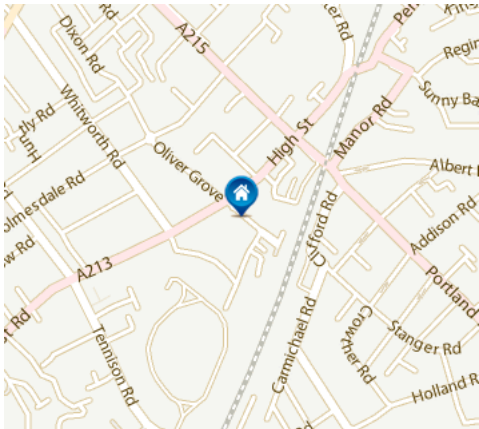
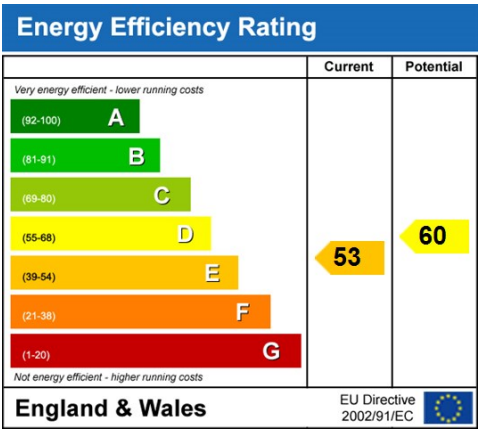

If you require clarification on any point please contact us particularly if travelling some distance to view. All services appliances, fittings and central heating etc (if applicable) have not been tested by our company. Measurements are taken by laser tape to the widest point of the room, are approximate and may be subject to a margin of error. Lease, ground rent, maintenance and garden details (if applicable) cannot at present be relied upon as being correct. We are awaiting clarification from the vendor's solicitors. The description of this property is only the opinion of our Company.