

FLETCHERS

ESTATE AGENTS



Saville Road, W4

£1,025,000

A beautifully presented four bedroom Victorian home with a large through reception room, two bath/shower rooms, one en suite to the master bedroom, an extended kitchen/dining room and to the rear of the property is an attractive garden.

Saville Road is a quiet residential road located off Acton Lane within a quarter of a mile from Chiswick Park and half a mile from Turnham Green underground stations.

• Four Bedrooms • Victorian • Extended Kitchen • Large Reception Room • Two Bath/ Shower Rooms • Attractive Garden • •

FLETCHERS

ESTATE AGENTS

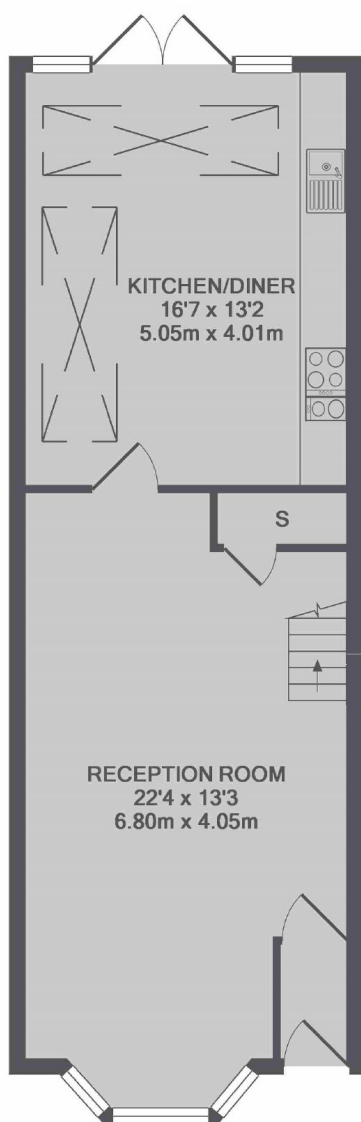

GROUND FLOOR



1ST FLOOR



2ND FLOOR

TOTAL APPROX. FLOOR AREA 1224 SQ.FT. (113.7 SQ.M.)

Fletchers Chiswick Turnham Green
Terrace Sales
58 Turnham Green Terrace, London,
W4 1QP
020 8987 3000

Energy Rating: C. We aim to make our particulars both accurate and reliable. However they are not guaranteed; nor do they form part of an offer or contract. If you require clarification on any points then please contact us, especially if you're traveling some distance to view. Please note that appliances and heating systems have not been tested and therefore no warranties can be given as to their good working order.