

SNELLERS

ESTATE AGENTS



Halliford Road, TW16

£1,100,000

A beautifully presented five bedroom, three bathroom, semi-detached Victorian home with large south west facing landscaped garden.



This impressive characterful semi-detached family home has been fantastically modernised throughout but not at the expense of its period features that makes this house a home. The ground floor has been extended to create a bright and airy kitchen/dining room, with bi-folding doors that open out onto the patio area of the rear garden making this property ideal for entertaining.

The first floor offers three double bedrooms. The master bedroom has built in storage, a modern en suite and a bay window overlooking the fields. The second floor continues to impress and could be used for an au pair or a lodger being virtually self-contained. It comprises; two bedrooms, kitchenette, shower room and plenty of built in storage.

Externally the house has a large driveway with off street parking and side access leading to the rear of the property. The rear south westerly facing garden is approx. 200ft long with a mature landscaped lawn and a patio area. At the end of the lawn is a large outbuilding, perfect for a studio/gym or home office.

Halliford Road is sought after location within half a mile of the local village shops, Sunbury Park, the River Thames and the riverside pubs.

- Impressive Family Home • Five Bedrooms • Three Bathrooms •
- Period Features • Off Street Parking • Large Rear Garden •



SNELLERS

ESTATE AGENTS

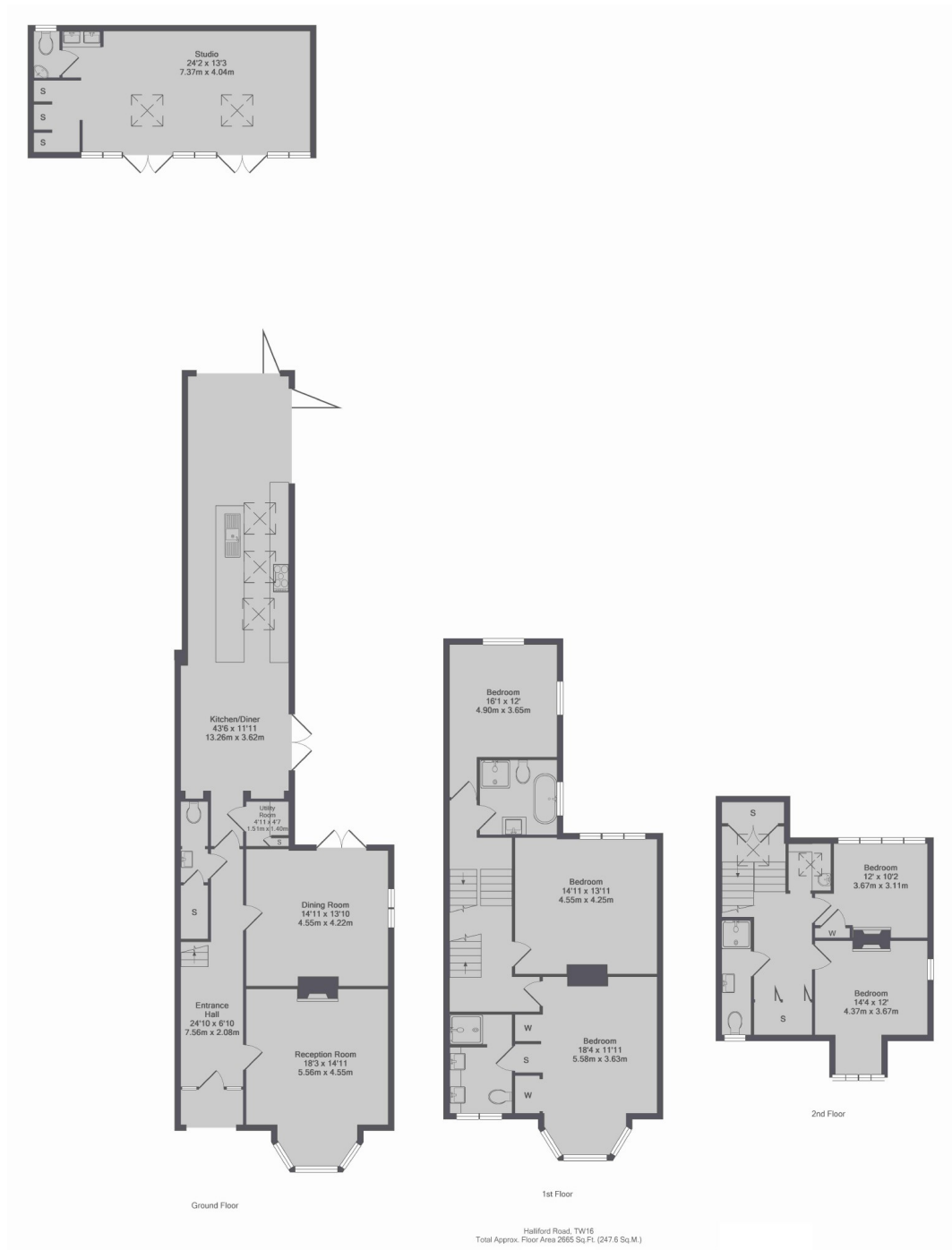

Snellers Hampton Hill Sales
197-201 High Street
Hampton Hill
TW12 1NL
020 8783 0083
hamptonsales@snellers.co.uk

Energy Rating: D We aim to make our particulars both accurate and reliable. However they are not guaranteed; nor do they form part of an offer or contract. If you require clarification on any points then please contact us, especially if you're traveling some distance to view. Please note that appliances and heating systems have not been tested and therefore no warranties can be given as to their good working order