

1,365 SQ FT (126.81 SQ M)
PROMINENT OFFICE BUILDING, CLOSE TO
LEWES TOWN CENTRE
TO LET



CAUSEWAY HOUSE, 48 MALLING STREET (A26)
EAST SUSSEX, LEWES BN7 2RH

LOCATION

Located approximately 7 miles to the north of Newhaven and a similar distance north east of Brighton, Lewes is the historic County town serving East Sussex. Malling Street (A26) is the link road to Uckfield and A22. The A27 with its fast road links to the A23/M23 is situated to the immediate south via Cuilfail Tunnel. The town centre is situated approximately ½ a mile to the southwest. Lewes Train Station where there are regular services to Brighton (16 minutes) and London Victoria (60 minutes) lies within a short walking distance south of the High Street. A street view of Malling Street can be viewed through Google Maps by typing in the property's postcode BN7 2RH

DESCRIPTION

Causeway House is a three storey office building fronting Mallong Street with dedicated parking at the rear.

ACCOMMODATION (net internal area)

Ground Floor:

Office and storage 401 sq ft (37.25 sq m)

First Floor:

Offices (3x rooms) and kitchen 498 sq ft (46.26 sq m)

Second Floor:

Offices (3x rooms) and storage 466 sq ft (43.29 sq m)

Total Accommodation

1,365 sq ft (126.81 sq m)

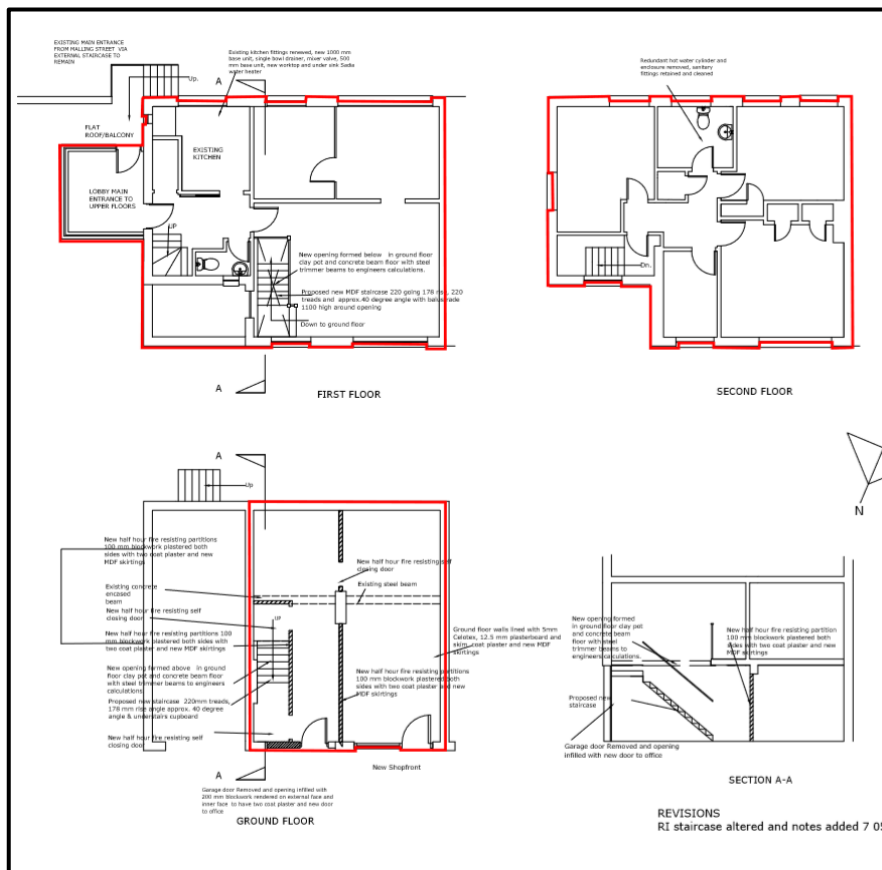

FEATURES

- Two entrances
- 5 allocated parking spaces
- Gas central heating
- Cat 5 telecom points
- BT phone points
- Cat II lighting
- Male & female toilets
- Kitchen

TERMS

The property is available to let upon a new effective full repairing and insuring lease for a term to be agreed. A rental deposit and references will be required.

RENT

£2,000 per calendar month exclusive, payable quarterly in-advance.

EPC

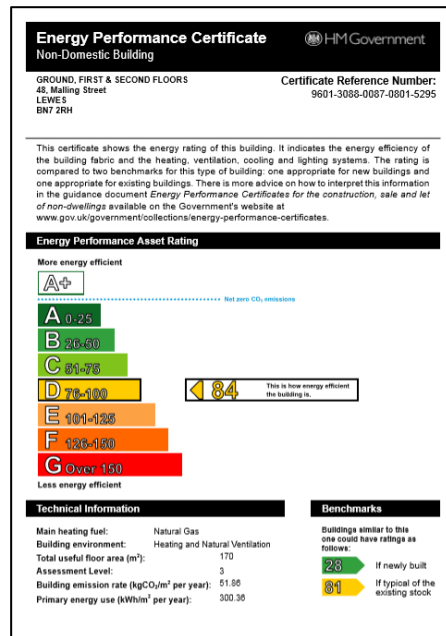

VAT

We understand the property has not been elected for VAT.

SERVICE CHARGE

There is a quarterly service charge of £450 payable to the Landlord for the building's upkeep and maintenance of common areas. The charge principally covers external maintenance, gardening, maintenance of car parking area and management services.

LEGAL COSTS

Each party to be responsible for payment of their own legal costs.

BUSINESS RATES (2018/2019 FINANCIAL YEAR)

The current Rateable Value advertised online by Gov.UK is £14,500. The Uniform Business Rate for 2018/2019 is 0.48p in the £ making the Rates Payable £6,960.

Interested parties are advised to contact Lewes District Council Rates Department on 01273 484149 to verify the above.

VIEWING ARRANGEMENTS

By appointment with letting agents Clifford Dann and Henry Adams Commercial

CONTACTS

Giles Maude
Clifford Dann LLP
01273 407 470
gmaude@clifforddann.co.uk

Andrew Mark Algar
Henry Adams Commercial
01403 282 519
andrew.algar@henryadams.co.uk

LOCATION MAP - NOT TO SCALE

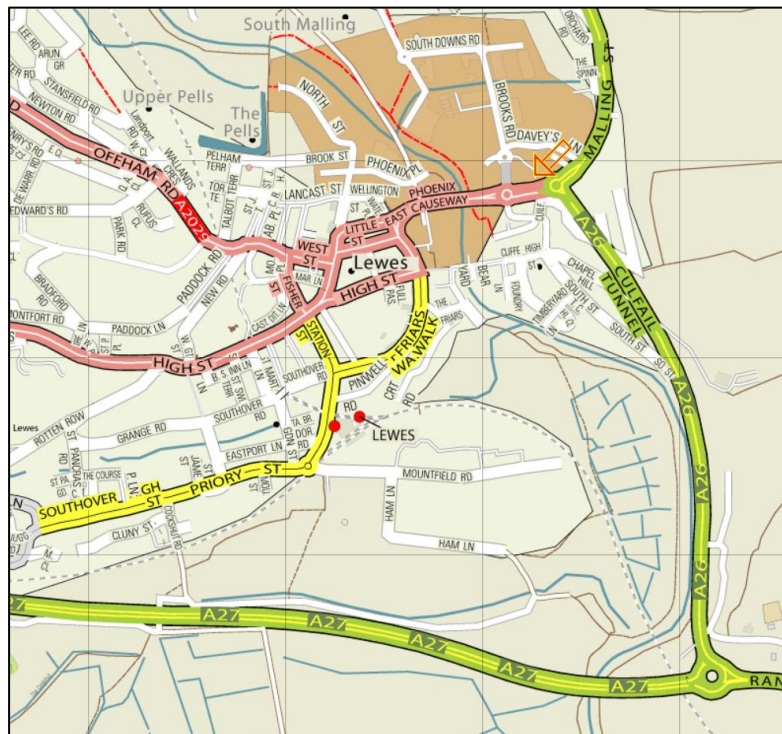

Clifford Dann

Clifford Dann LLP
Albion Street
Lewes
East Sussex BN7 2NF
Tel: 01273 477022
E-mail: lewes@clifforddann.co.uk

www.clifforddann.co.uk



Henry Adams (Horsham) LLP
50 Carfax
Horsham
West Sussex RH12 1BP
Tel: 01403 282519
E-mail: horsham@henryadams.co.uk

www.henryadams.co.uk

Agent's Notice - We endeavour to make our particulars as accurate and reliable as possible. They are for guidance only and are intended to give a fair overall summary of the property. They do not form part of any contract or offer and should not be relied upon as a statement or representation of fact. Measurements, areas, plans and distances are approximate only. Photographs and computer generated images show only certain parts and aspects of the property at the time they were taken or created. Neither Clifford Dann LLP or Henry Adams Horsham LLP nor any of its employees has any authority to make or give any representation or warranty whatsoever in relation to the property. No undertaking is given as to the structural condition of the property or any necessary consents or the operating ability or efficiency of any service system or appliance. Intending purchasers or lessees must satisfy themselves with regard to each of these points. Unless otherwise stated, all prices and rents are quoted exclusive of VAT. Any intending purchasers or lessees must satisfy themselves as to the incidence of VAT in respect of any transaction.