



Radbourne Road, SW12

£645,000

A ground floor Victorian maisonette tastefully decorated throughout, located on the Hyde Farm Estate. It has two double bedrooms and a spacious kitchen/dining area leading out to a private west facing garden.

- Two Double Bedrooms
- Ground Floor
- Victorian Maisonette
- Hyde Farm Estate
- Private Garden
- Close Proximity To Telferscot Primary

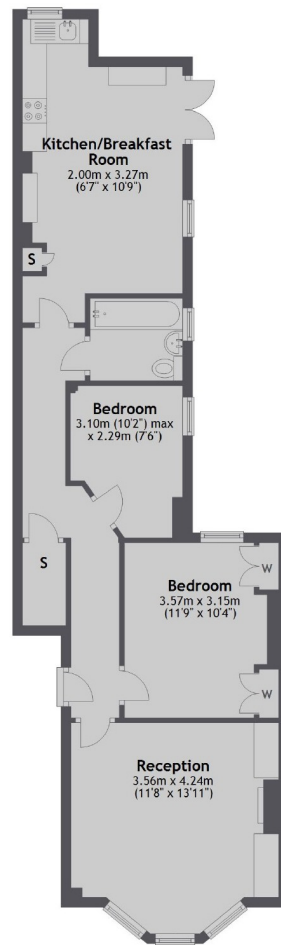

Ground Floor

Total area: approx. 66.7 sq. metres (718.5 sq. feet)

Jacksons Balham
8-11 Balham Station Road
London
SW12 9SG
020 8675 6565
balham.sales@jacksonsestateagents.com

Energy Rating: D We aim to make our particulars both accurate and reliable. However they are not guaranteed; nor do they form part of an offer or contract. If you require clarification on any points then please contact us, especially if you're traveling some distance to view. Please note that appliances and heating systems have not been tested and therefore no warranties can be given as to their good working order.