

ROKSTONE



St George`s Wharf Nine Elms

This spectacular three bedroom apartment is located on the 29th floor of this highly sought after new development on the banks of the River Thames, with direct views of the river and breathtaking view of the London skyline. This sophisticated apartment offers 3 double bedrooms, 2 bathrooms, open plan kitchen which has been finished to the highest specification including a wine cooler and coffee machine and further benefits from full width floor to ceiling windows in all rooms, boasting with the fantastic views and ample of natural light. Further features are: Comfort cooling, under flooring heating and an Opus touch screen control panel operating the lighting, heating. The Tower is one of Europe`s tallest solely residential buildings and boasts exceptional interior design, sophisticated exteriors, a well-equipped leisure suite with a small swimming pool, treatment rooms, a business suite as well as a 24 hour concierge and valet parking service.

Price £2,850,000



5 Dorset Street London W1U 6QJ
Tel: 020 7580 2030 | Email: enquiries@rokstone.com
<http://www.rokstone.com>

ROKSTONE

St. George's Wharf

Approx. Gross Internal Area 1407 Sq Ft - 130.71 Sq M

(Including Winter Garden)

Approx. Gross Internal Area Of Winter Garden 68 Sq Ft - 6.32 Sq M

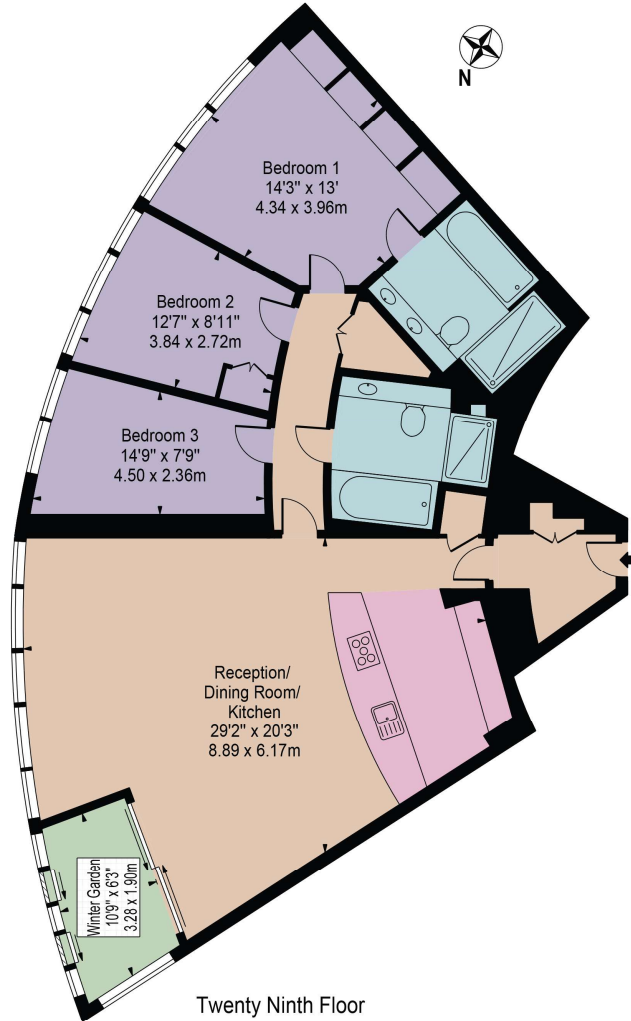

For Illustration Purposes Only - Not To Scale

This floor plan should be used as a general outline for guidance only and does not constitute in whole or in part an offer or contract. Any intending purchaser or lessee should satisfy themselves by inspection, searches, enquiries and full survey as to the correctness of each statement. Any areas, measurements or distances quoted are approximate and should not be used to value a property or be the basis of any sale or let.

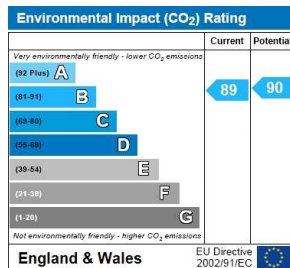
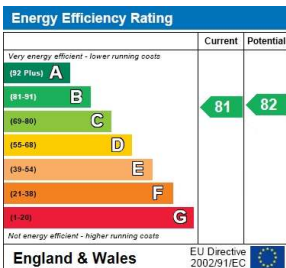

Terms

Local Authority: London Borough Of Lambeth

Tenure: Leasehold

Service Charge: £14,521.74PA

5 Dorset Street London W1U 6QJ

Tel: 020 7580 2030 | Email: enquiries@rokstone.com

http://www.rokstone.com