

EADON LOCKWOOD & RIDDLE
SALES • LETTINGS • SURVEYS



Edge House, The Square, Eyam, Hope Valley, Derbyshire, S32 5RB

The Square,

Eyam, Hope Valley, S32 5RB

A deceptively spacious stone built three bedroomed semi-detached family home located in the heart of Eyam, overlooking the Square with many period features and delightful, easily maintained garden. Built around the 1920's this wonderful home has been beautifully maintained throughout retaining many features including original fireplaces, high ceilings and solid wood flooring.

At the side of the property the front door opens to an entrance hall with doors to all accommodation and stairs rising to the first floor landing. To the left is a spacious front facing sitting room with solid wood flooring and ornate Victorian fireplace. This room has particularly high ceilings and there are attractive views across the village square. At the heart of the property is a spacious dining room with solid wood flooring, fireplace with as living gas flame fire and original fitted cupboards. This attractive room has a rear facing aspect overlooking the garden and convenient under stairs storage. Accessed from the dining room is a contemporary style fitted kitchen with Shaker units comprising of four burner hob with extractor over, oven, microwave and stainless steel Franke sink and drainer. There is space for a Gorenje fridge/freezer (available by separate negotiation) and a stable door provides access to the garden.

From the entrance hall stairs rise to the first floor landing with solid wood balustrade and panelled doors to all rooms. To the left is a very spacious master bedroom with feature fireplace, fitted storage cupboard and lovely views across the square. Bedroom three is a rear facing double bedroom with pleasant view of Eyam Edge. The first floor accommodation is completed by a luxury shower room comprising of fitted cabinet top wash hand basin, w.c, shower enclosure and heated towel rail.

From the landing stairs rise to the top floor triple aspect bedroom with dormer window, superb village views and eaves storage.

Outside to the rear of the property is an easily maintained patio garden with seating areas, patio and gravelled area. There are two external stores ideal for storage, a pedestrian gate and timber fencing/trellis.

- Three bedroomed stone built semi-detached in the heart of Eyam
- Sitting room with high ceilings and ornate fireplace
- Contemporary styled recently fitted kitchen
- Lovely easily maintained garden
- Spacious dining room with garden aspect
- Three double bedrooms all with superb village views
- Luxury shower room
- Many original features alongside Art Deco styling
- Two external stores
- Highly regarded school catchment





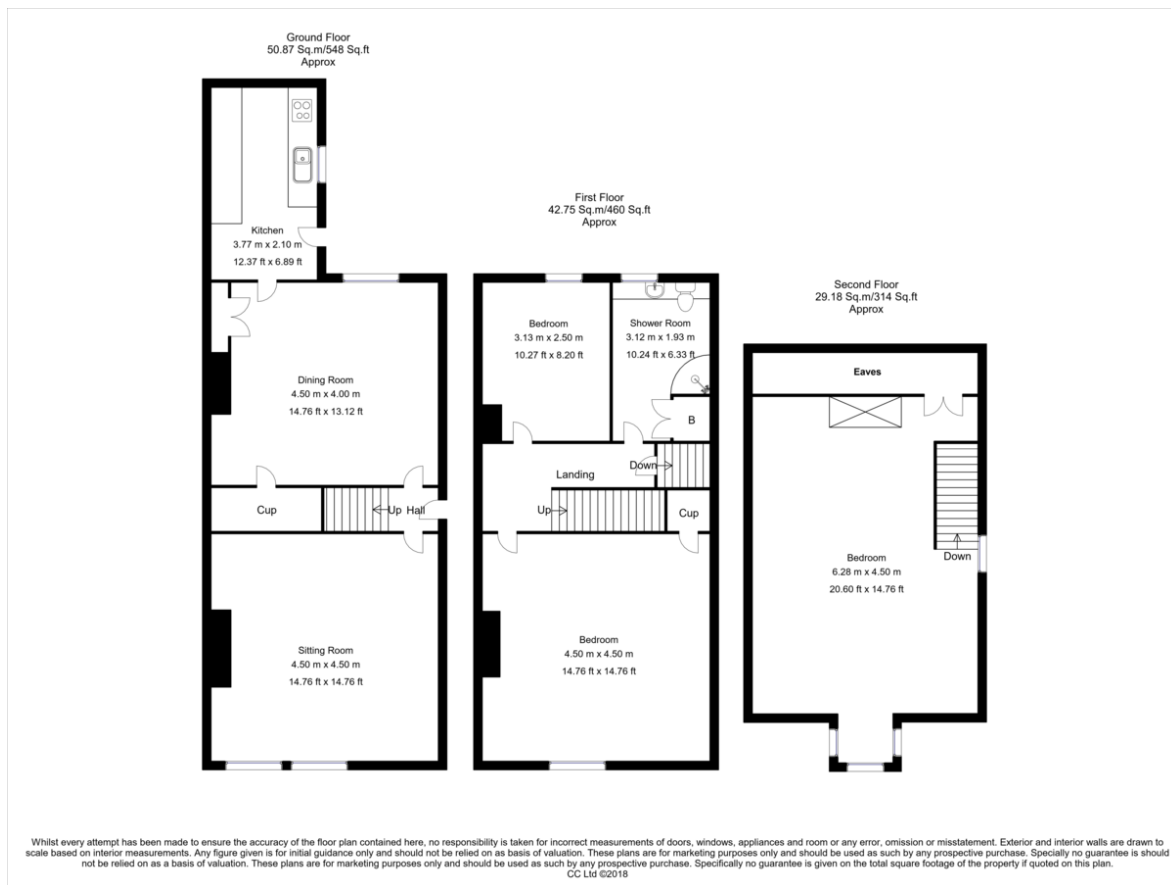

Bakewell

3 Royal Oak Place
Matlock Street
Bakewell DE45 1HD
T: 01629 700699
E: bakewell@elr.co.uk

Banner Cross

888 Ecclesall Road
Banner Cross
Sheffield S11 8TP
T: 01142 683388
E: bannercross@elr.co.uk

Dore

33 Townhead Road
Sheffield
S17 3GD
T: 0114 2362420
E: dore@elr.co.uk

Hathersage

Main Road, Hathersage
Hope Valley
Derbyshire S32 1BB
T: 01433 651888
E: peakdistrict@elr.co.uk

Rotherham

149 Bawtry Road
Wickersley
Rotherham S66 2BW
T: 01709 917676
E: wickersley@elr.co.uk



EADON LOCKWOOD & RIDDLE
SALES • LETTINGS • SURVEYS

All rooms have been measured with electronic laser and are approximate measurements only. None of the services to the above property have been tested by ourselves, and we cannot guarantee that the installations described in the details are in perfect working order. Eadon Lockwood & Riddle for themselves, and for the vendors or lessors, produce these brochures in good faith, and are a guideline only. They do not constitute any part of a contract and are correct to the best of our knowledge at the time of going to press.