

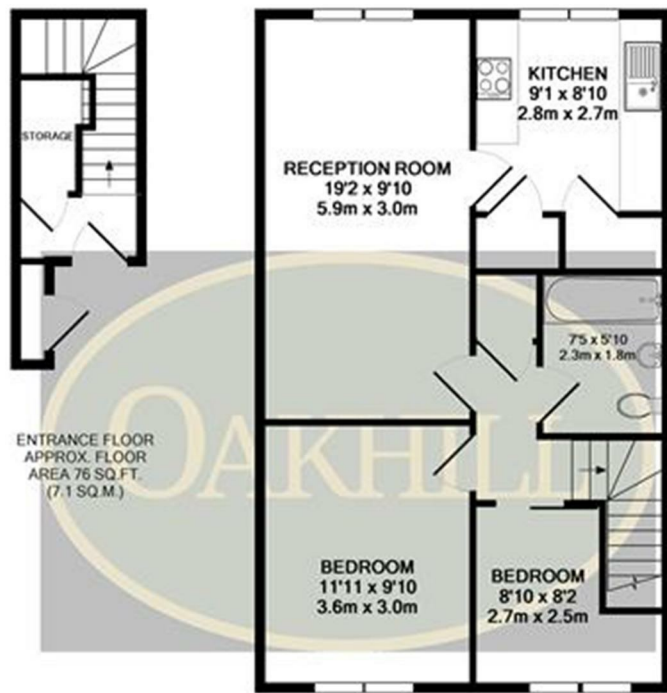

Beechen Cliff Way, Isleworth, Middlesex TW7 5DF

Situated in a cul-de-sac next to Isleworth station and local amenities, this two bedroom first floor maisonette with private entrance is offered to the market immediately, on an unfurnished basis. With access to communal gardens and residents parking area, the property further features a spacious reception room, modern fitted kitchen with two large storage cupboards, bathroom, good size master bedroom and a further bedroom. There is also access to loft space, under stairs storage ideal for bikes, gas central heating, and external storage.

£1,300 PER MONTH



ENTRANCE FLOOR
APPROX. FLOOR
AREA 76 SQ.FT.
(7.1 SQ.M.)

1ST FLOOR
APPROX. FLOOR
AREA 606 SQ.FT.
(56.3 SQ.M.)

TOTAL APPROX. FLOOR AREA 682 SQ.FT. (63.3 SQ.M.)

Whilst every attempt has been made to ensure the accuracy of the floor plan contained here, measurements of doors, windows, rooms and any other items are approximate and no responsibility is taken for any error, omission, or mis-statement. This plan is for illustrative purposes only and should be used as such by any prospective purchaser. The services, systems and appliances shown have not been tested and no guarantee as to their operability or efficiency can be given

Made with Metropix ©2018

Energy Efficiency Rating

	Current	Potential
Very energy efficient - lower running costs		
(92 plus) A		
(81-91) B		
(69-80) C		
(55-68) D		
(39-54) E		
(21-38) F		
(1-20) G		
Not energy efficient - higher running costs		
England & Wales	EU Directive 2002/91/EC	

79 82

Environmental Impact (CO₂) Rating

	Current	Potential
Very environmentally friendly - lower CO ₂ emissions		
(92 plus) A		
(81-91) B		
(69-80) C		
(55-68) D		
(39-54) E		
(21-38) F		
(1-20) G		
Not environmentally friendly - higher CO ₂ emissions		
England & Wales	EU Directive 2002/91/EC	

77 80

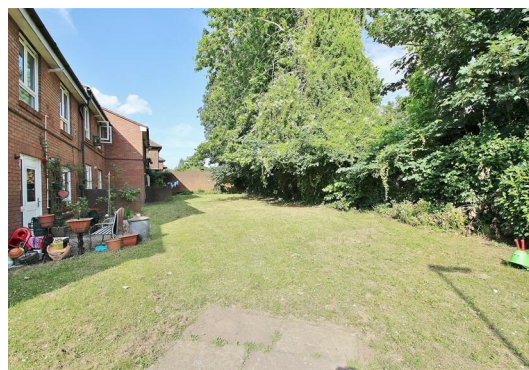

6 South Street, Isleworth, TW7 7BG
Tel: 0208 568 4433
info@oakhillagents.co.uk
www.oakhillagents.co.uk

OAKHILL