



Shilling Place, W7

£275,000

OFFERS IN EXCESS OFThis one double bedroom first floor flat built in 1996 with well proportioned layout and offered onto the market with no onward chain, long lease and allocated parking.

Within a mile of Boston Manor tube (Piccadilly), West Ealing and Hanwell station (Crossrail), and varied and frequent buses to Ealing/Acton & Northfields.

First Floor

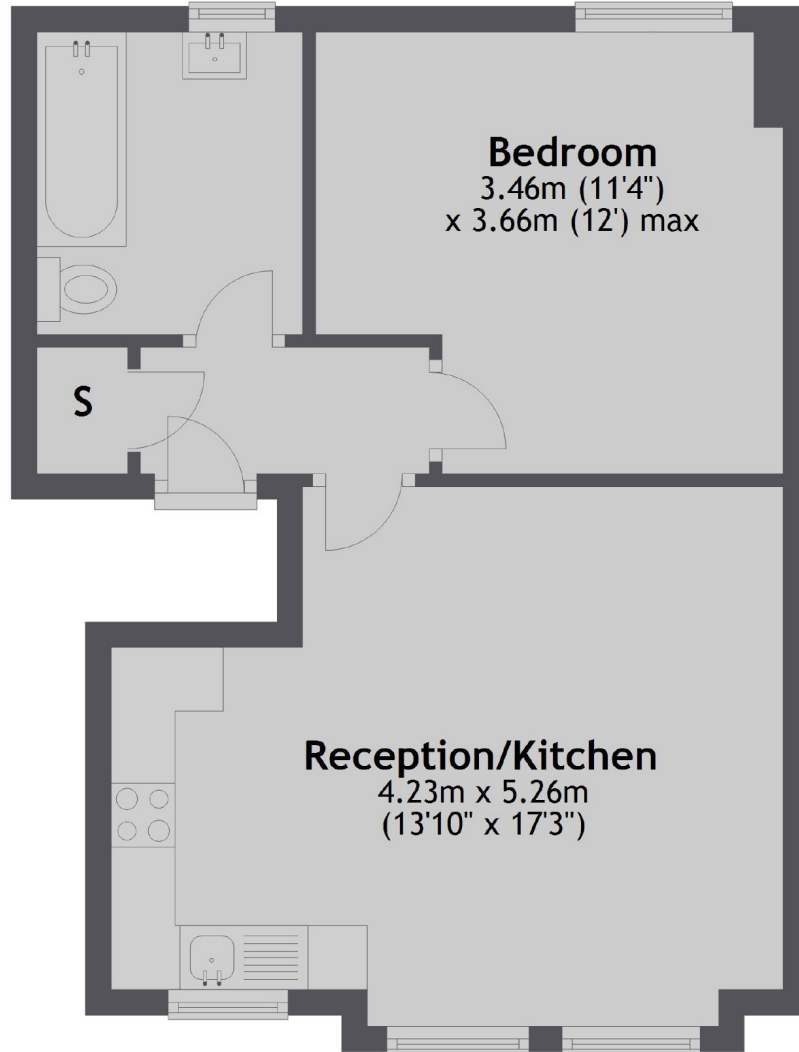

Total area: approx. 40.2 sq. metres (432.7 sq. feet)

Robertson Smith & Kempson Hanwell Sales
69 Greenford Avenue,
London, W7 1LL
020 8566 2339
hanwellsales@robertsonsmithandkempson.co.uk

Energy Rating: C. We aim to make our particulars both accurate and reliable. However they are not guaranteed; nor do they form part of an offer or contract. If you require clarification on any points then please contact us, especially if you're traveling some distance to view. Please note that appliances and heating systems have not been tested and therefore no warranties can be given as to their good working order.