



Norman Road, Wimbledon SW19 1BN

Guide Price £829,950 Freehold

 4  2  2

- EPC EER D
- Four Double Bedrooms
- 1,335 Sq.Ft. Gross Internal Area

- Private Garden
- Large Roof Terrace
- No Onward Chain



Property Details

A well-presented mid-terrace Victorian family house situated within this popular tree lined residential road 0.3 miles from South Wimbledon Northern line tube station and approximately one mile from Wimbledon town centre.

This spacious home boasts 1,335 Sq. Ft. of living accommodation and features four double bedrooms, a 24'5 Ft. through lounge/dining room with two feature fireplaces and stripped wood flooring and access to the private rear garden, the breakfast room leads through to a well-proportioned kitchen which includes a new gas "Range Cooker", washing machine, dish washer and integrated fridge/freezer, the family bathroom complete with under-floor heating is located at the rear of the property.

The first floor features three double bedrooms as well as access to a superb roof terrace. The property has been loft extended to accommodate the fourth bedroom as well as the second bathroom. The property has been recently re-decorated and is available with no onward chain.

Conveniently located the property sits within a short distance of the local Virgin Gym, moments from the Sainsbury/ M&S hypermarket and approximately 0.6 miles from Haydons road Thameslink station.

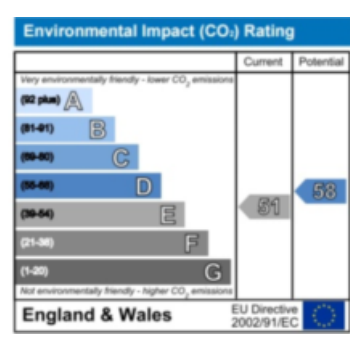
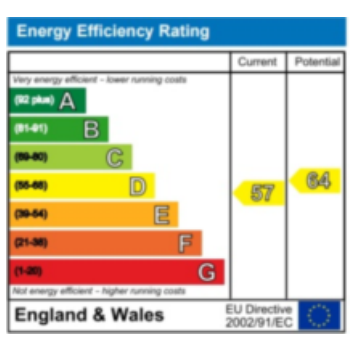

Norman Road, Wimbledon, SW19

TOTAL APPROX. GROSS INTERNAL FLOOR AREA 1335 SQ FT 124 SQ METRES

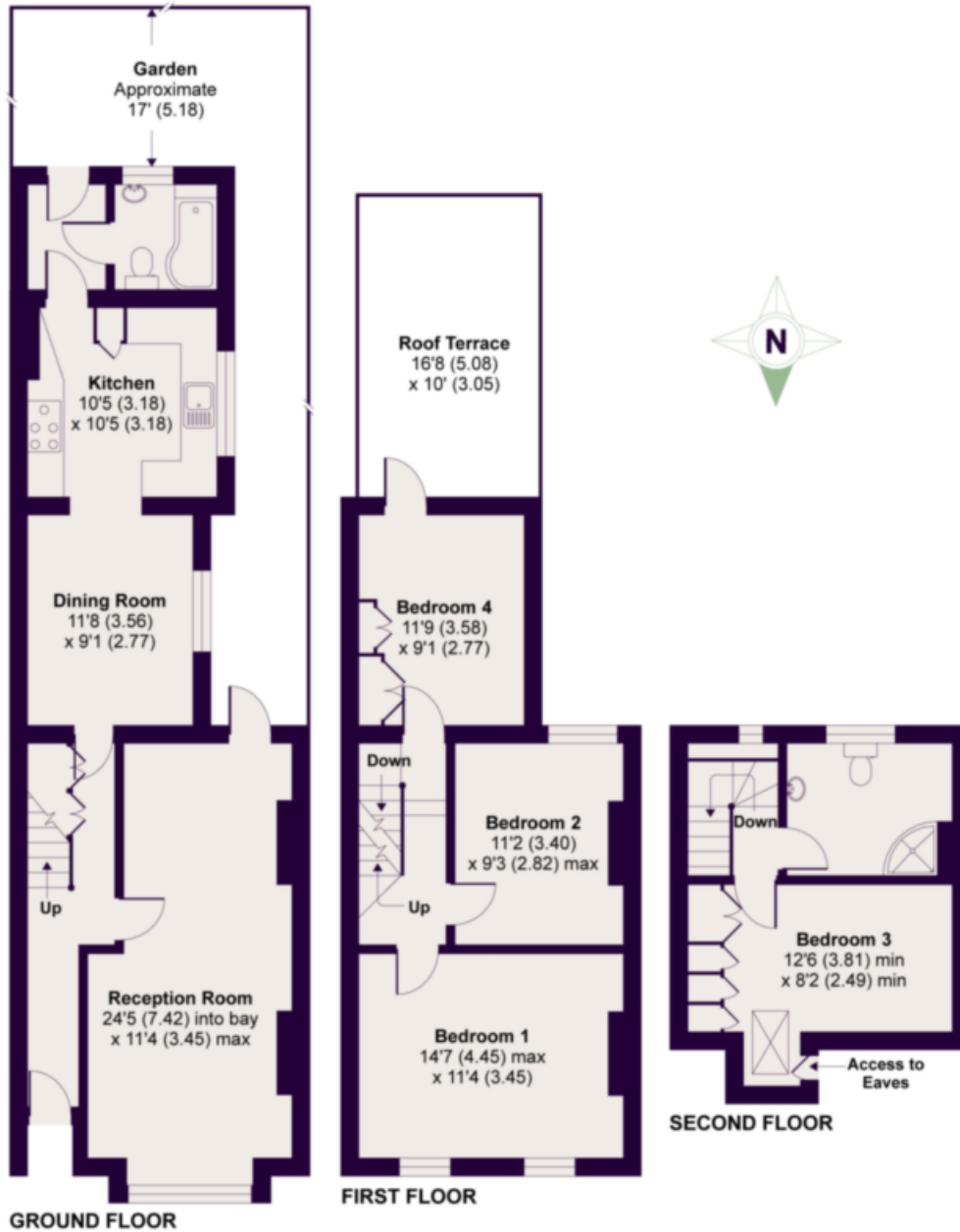

Whilst every attempt has been made to ensure the accuracy of the floor plan contained here, measurements of doors, windows and rooms are approximate and no responsibility is taken for any error, omission or misstatement. These plans are for representation purposes only as defined by RICS Code of Measuring Practice and should be used as such by any prospective purchaser. Specifically no guarantee is given on the total square footage of the property if quoted on this plan. Any figure given is for initial guidance only and should not be relied on as a basis of valuation.

Copyright nichecom.co.uk 2015 Produced for Lauristons REF : 56989

If you have just started looking or have found your new home, you could benefit from talking to our Financial Services Department. For an informal discussion on anything from costs of moving to the most current mortgage rates please call us on 020 8946 9468. Your home is at risk if you do not keep up with repayments on a mortgage or any other loan secured on it, Written quotations available on request. Viewing is strictly through the owners Lauristons, Wimbledon Office 66-68 Wimbledon Hill, London SW19 7PA Tel: 020 8946 9468 Fax: 020 8946 9465 Email: sales.wimbledon@lauristons.com. For clarification we wish to inform potential purchasers that we prepared these particulars as a general guide. We have not carried out a detailed survey, nor tested the services, appliances and specific fittings. Lease details, where applicable, must be confirmed by your solicitor, Carpets, curtains, gas fires, electrical goods / fittings or other fixtures, unless expressly mentioned, are not included in the sales of this property. If there are any important matters which are unlikely to affect your decision to buy please contact this office and we will be pleased to check the information for you before viewing the property. Before this property can be removed from the market, all offers must be checked by Lauristons Financial Adviser. This is a service we offer on behalf of our clients. Please note that our room sizes are quoted in meters to the nearest tenth of a meter on wall to wall basis. The imperial equivalent is only intended as an approximate guide for those not fully conversant with the metric measurements. All measurements have been taken using a sonic tape measure and therefore may be subject to a small margin error.