



**Hardy Road, Wimbledon, London SW19 1JB**

Guide Price: £679,950 Freehold

 2  1  2

- 0.1 miles from the Northern line tube
- Excellent condition throughout
- West facing rear garden

- Scope for loft extension (stpp)
- 836 SQFT of floorspace
- Desirable 'Battles location'



### Property Details

A well-presented two double bedroom period home located in the sought after 'Battles area' of Wimbledon, 0.1 miles from the Northern line tube and approximately one mile from Wimbledon town centre.

Situated within this tree lined cul-de-sac this light and airy home benefits from a full width kitchen extension, scope to loft extend (stpp), enjoys 836 SQFT of floor space and with a 33' West facing rear garden we feel this property would make an ideal family home.

The accommodation comprises two double bedrooms, large loft space, modern three piece bathroom suite, bay fronted living room with feature fire place & built in storage cabinets, dining room, large extended kitchen/ breakfast room boasting a vaulted ceiling with Velux windows and a 33' West facing rear garden.

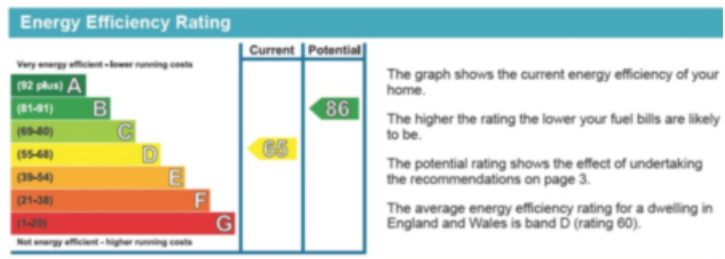

**Top actions you can take to save money and make your home more efficient**

Recommended measures	Indicative cost	Typical savings over 3 years	Available with Green Deal
1 Internal or external wall insulation	£4,000 - £14,000	£ 313	✓
2 Floor insulation	£800 - £1,200	£ 97	✓
3 Draught proofing	£80 - £120	£ 41	✓

## Hardy Road, London, SW19

APPROX. GROSS INTERNAL FLOOR AREA 836 SQ FT 77.66 SQ METRES

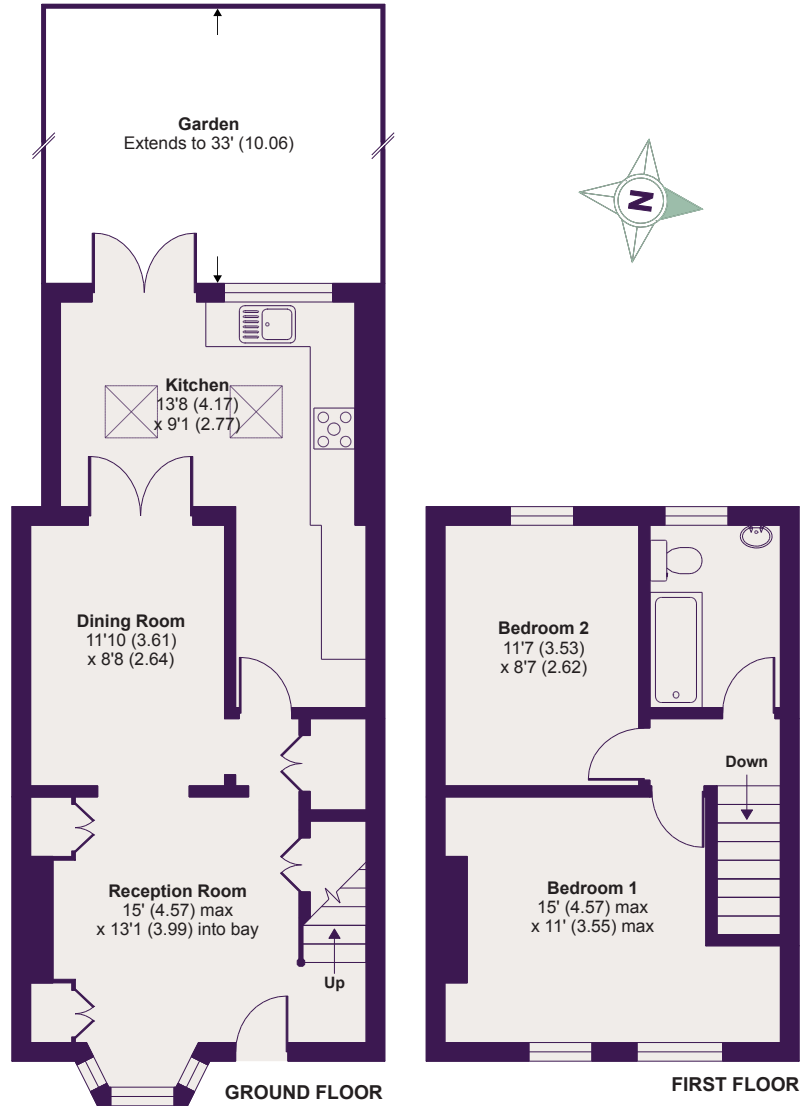

Whilst every attempt has been made to ensure the accuracy of the floor plan contained here, measurements of doors, windows and rooms are approximate and no responsibility is taken for any error, omission or misstatement. These plans are for representation purposes only as defined by RICS Code of Measuring Practice and should be used as such by any prospective purchaser. Specifically no guarantee is given on the total square footage of the property if quoted on this plan. Any figure given is for initial guidance only and should not be relied on as a basis of valuation.

Copyright nichecom.co.uk 2014 Produced for Lauristons REF : 657032

If you have just started looking or have found your new home, you could benefit from talking to our Financial Services Department. For an informal discussion on anything from costs of moving to the most current mortgage rates please call us on 020 8946 9468. Your home is at risk if you do not keep up with repayments on a mortgage or any other loan secured on it, Written quotations available on request. Viewing is strictly through the owners Lauristons, Wimbledon Office 66-68 Wimbledon Hill, London SW19 7PA Tel: 020 8946 9468 Fax: 020 8946 9465 Email: enquiries.wimbledon@lauristons.com. For clarification we wish to inform potential purchasers that we prepared these particulars as a general guide. We have not carried out a detailed survey, nor tested the services, appliances and specific fittings. Lease details, where applicable, must be confirmed by your solicitor, Carpets, curtains, gas fires, electrical goods / fittings or other fixtures, unless expressly mentioned, are not included in the sales of this property. If there are any important matters which are unlikely to affect your decision to buy please contact this office and we will be pleased to check the information for you before viewing the property. Before this property can be removed from the market, all offers must be checked by Lauristons Financial Adviser. This is a service we offer on behalf of our clients. Please note that our room sizes are quoted in meters to the nearest tenth of a meter on wall to wall basis. The imperial equivalent is only intended as an approximate guide for those not fully conversant with the metric measurements. All measurements have been taken using a sonic tape measure and therefore may be subject to a small margin error.