



Guinea Street, BS1 6SD

Wapping Wharf



A stunning 2 double bedroom duplex waterside apartment with secure underground parking and a private balcony directly overlooking the harbour. The apartment forms part of the iconic Bristol General Hospital that has now been converted into luxurious and super stylish homes that have been finished to an exceptionally high standard.

The location is so convenient with everything the city centre has to offer at your fingertips. Temple Meads train station is also within walking distance. An ideal home for any city professional or as a pied à terre. No chain.

- Luxury waterside duplex apartment
- Secure underground parking
- Direct harbourside views
- Leasehold
- Energy rating - C
- Circa 990 sqft (taken from EPC)



Accommodation

Reception Room

A stunning and refreshingly bright and airy space with large windows and doors that lead on to the balcony which offers spectacular views over the harbour. The room is open to the stylish modern kitchen making it very sociable when entertaining.

Bedroom

The smaller double bedroom of the two but still a great size. It is located on the same floor as the living area and faces out towards the water.

Master Bedroom

A very grand bedroom which is on the upper level of the flat with its own beautifully fitted ensuite 4 piece bathroom and a built in double wardrobe.

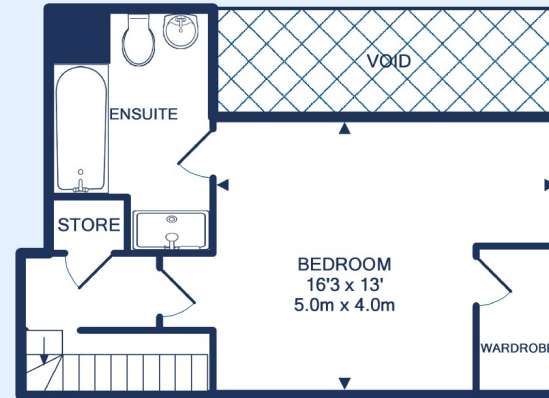



Wapping Wharf - Guide price £600,000

2 Bed Apartment

References to the Tenure of a Property are based on information supplied by the Seller. The Agent has not had sight of the title documents. Lease details, service ground rent (where applicable) are given as a guide only and should be checked and confirmed by your solicitor prior to exchange of contracts.



Clifton Branch
187 Whiteladies Road, Clifton, Bristol, BS8 2RY

Call: 0117 9466007

Mail: cliftonsales@oceanhome.co.uk

Search: www.oceanhome.co.uk