

Oak Point Sutton Court Road, HILLINGDON, UB10 9HR



£315,000

The Manhattan by ClearView Homes Open Day House 14th March..... is a unique stylish apartment within a contemporary building and nestled in the ever popular Oak Farm Development. The accommodation comprises of open planned living area with integrated appliances to the kitchen/ Dining area along with NEFF Hob and oven. The Manhattan boasts a separate sleeping area with fitted wardrobes and bespoke Bi folding frosted doors, Jack and Jill shower which is fully tiled. To the outside the apartment has access to its own private garden. This exquisite apartment lies just over a mile from Hillingdon Station Metropolitan and Piccadilly Lines located just off the A437 giving easy access to the M40, M4 and the M25. Oak Point Sutton Court Road has a parade of useful shops including newsagents and pharmacy. Being only six miles approximately from Heathrow Airport. The Manhattan falls under the London Help To Buy Scheme and being the only apartment available Peter Rolfe would recommend an early viewing.

- The Manhattan
- Separate Bedroom Area
- Jack and Jill Shower
- Private Garden to Front.
- London Help To Buy
- Integrated Appliance
- Fitted Wardrobes
- Bespoke Bi Folding Doors

Ground Floor

Approx. 41.7 sq. metres (448.9 sq. feet)

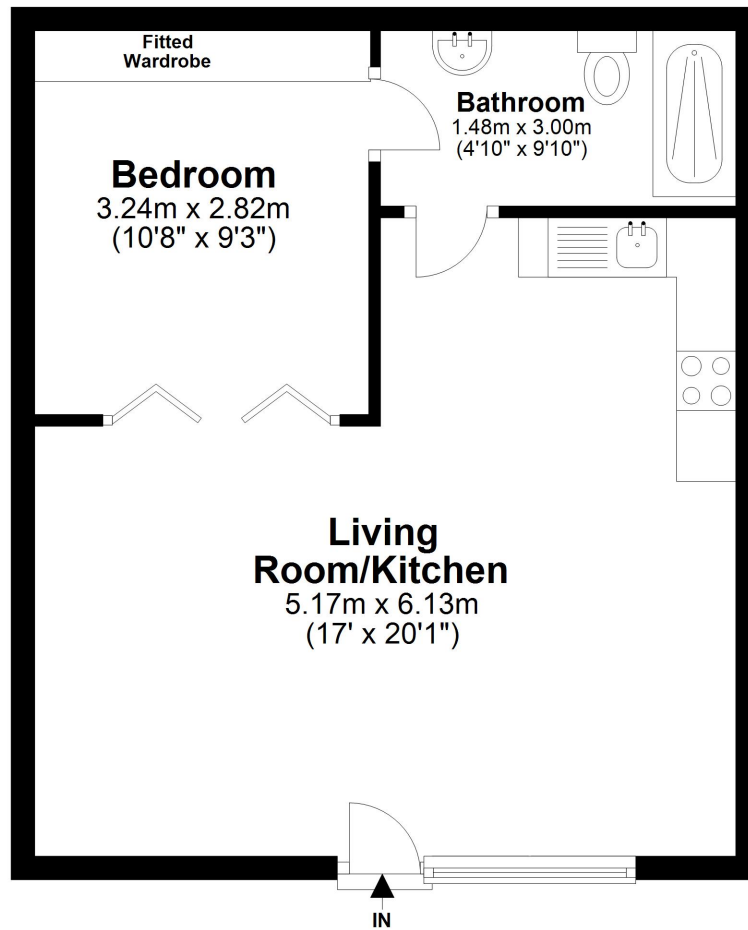

Total area: approx. 41.7 sq. metres (448.9 sq. feet)