

# DOMUS NOVA

nottinghill@domusnova.com | 020 7727 1717

[Property](#) / [Map](#) / [Floor plan](#) / [Contact](#)

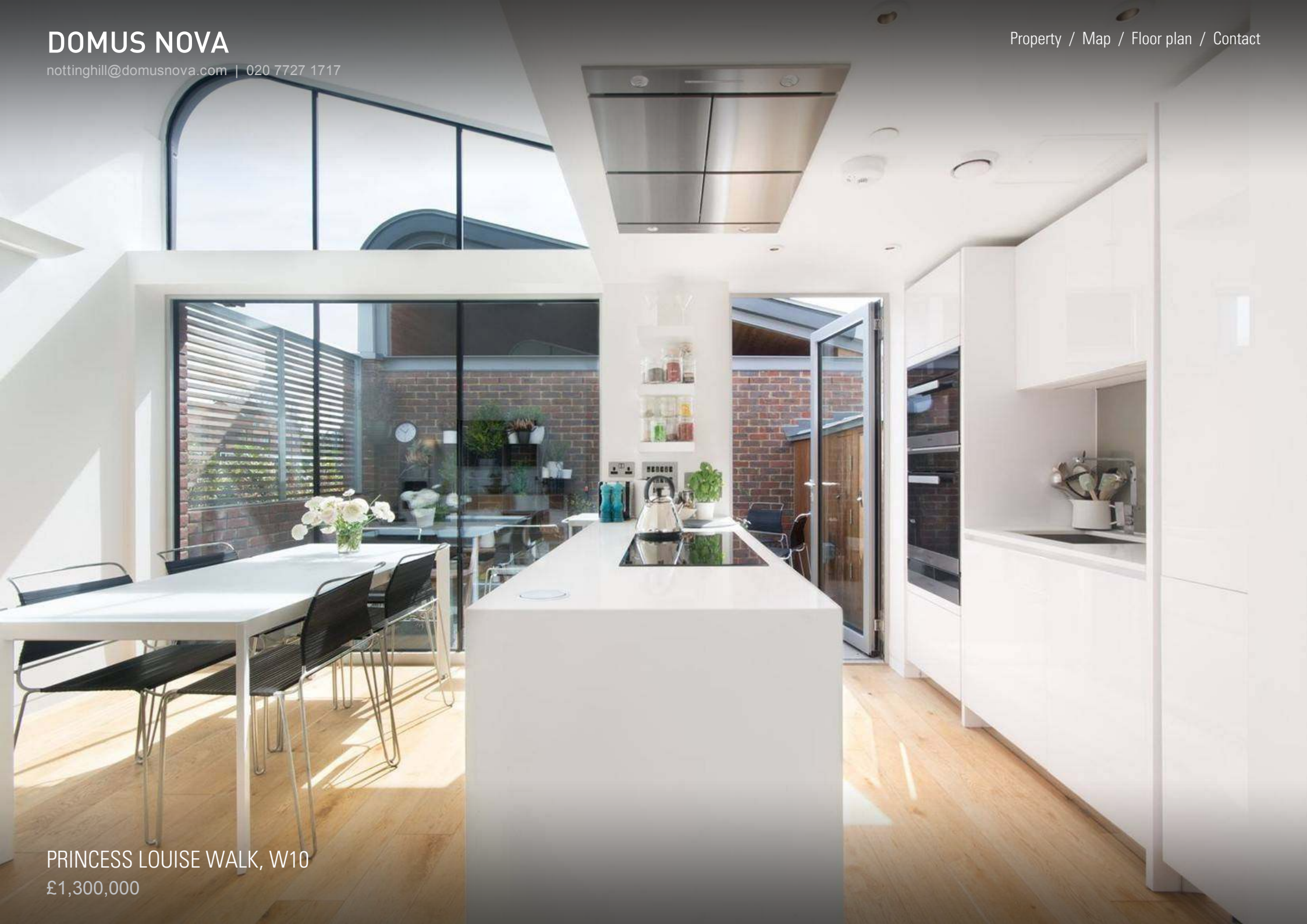

PRINCESS LOUISE WALK, W10

£1,300,000

Princess Louise Walk, W10

£1,300,000

A unique and contemporary three-bedroom mews house. Flooded with natural light, this modern home has a large open-plan living area spanning the entire ground floor which leads onto a private patio garden; overlooking Kensington Memorial Park. The wonderful master bedroom suite opens onto a private patio, with a guest bedroom and a glazed study/bedroom 3 overlooking the winter garden.

Princess Louise Walk is a gated development in North Kensington, moments from the wonderful amenities of Ladbroke Grove, Golborne Road and White City.

- Open-plan living room
- Open plan kitchen onto patio garden
- Master bedroom suite onto private patio
- Guest bedroom
- Guest bedroom
- Patio garden
- Secure underground parking
- Freehold
- Royal Borough of Kensington & Chelsea
- Approx. 1,117 sq ft / 103.8 sq m. EPC=B







# DOMUS NOVA

## Map

 Princess Louise Walk, W10

## Local Information

### Architecture

-  Jonathan Tuckey Design
-  Studio Bednarski
-  De Rosee Sa Architects

### Art & Culture

-  Siegfried Contemporary





### Design

-  Violet & George
-  Tom Dixon Studio

### Fashion

-  meli melo

### Food & Drink

-  George's Fish Bar
-  108 Garage
-  Pizza East Portobello
-  Snaps & Rye

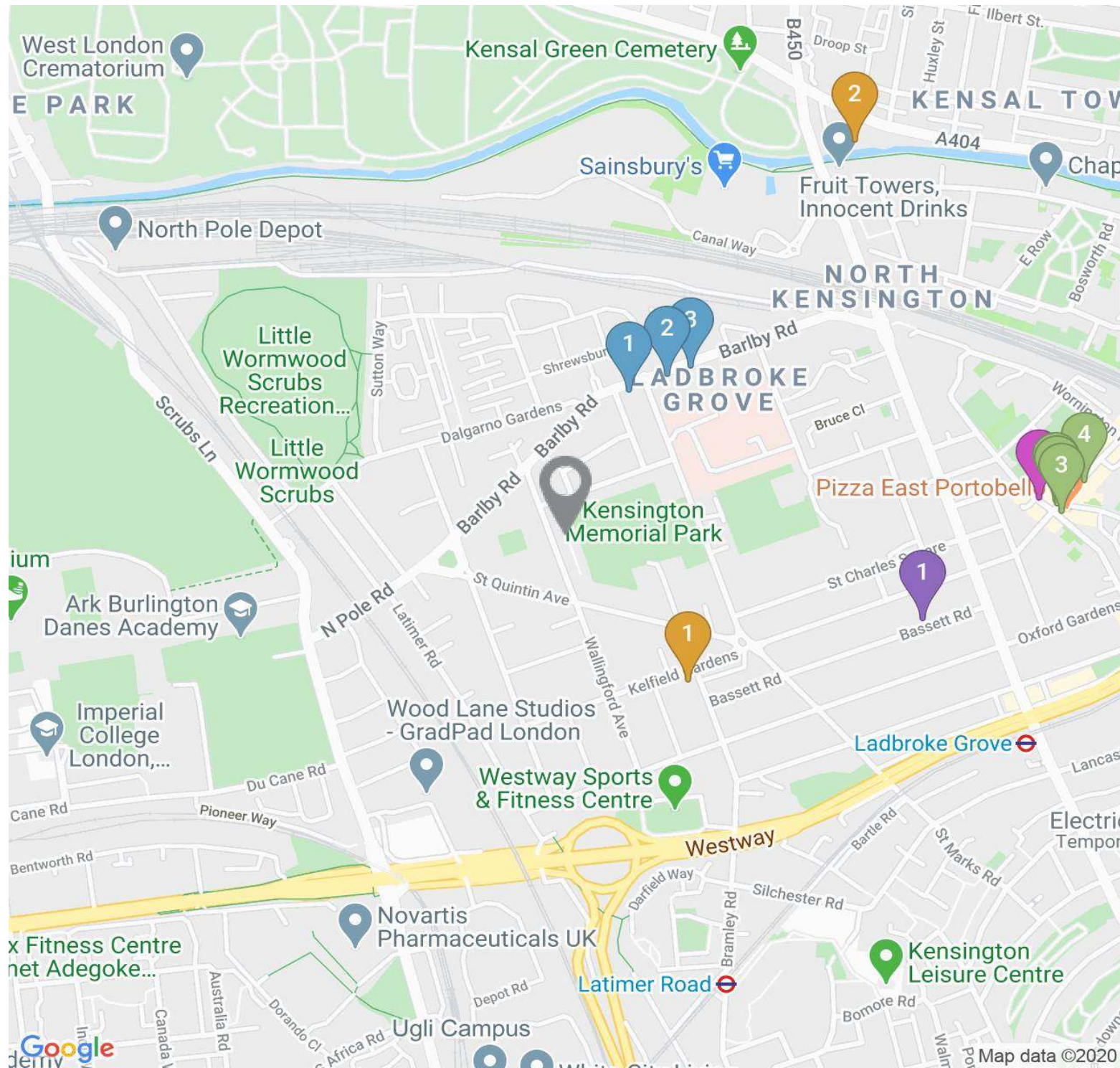

## Floor plan

This image is illustrative only

(Not to scale)

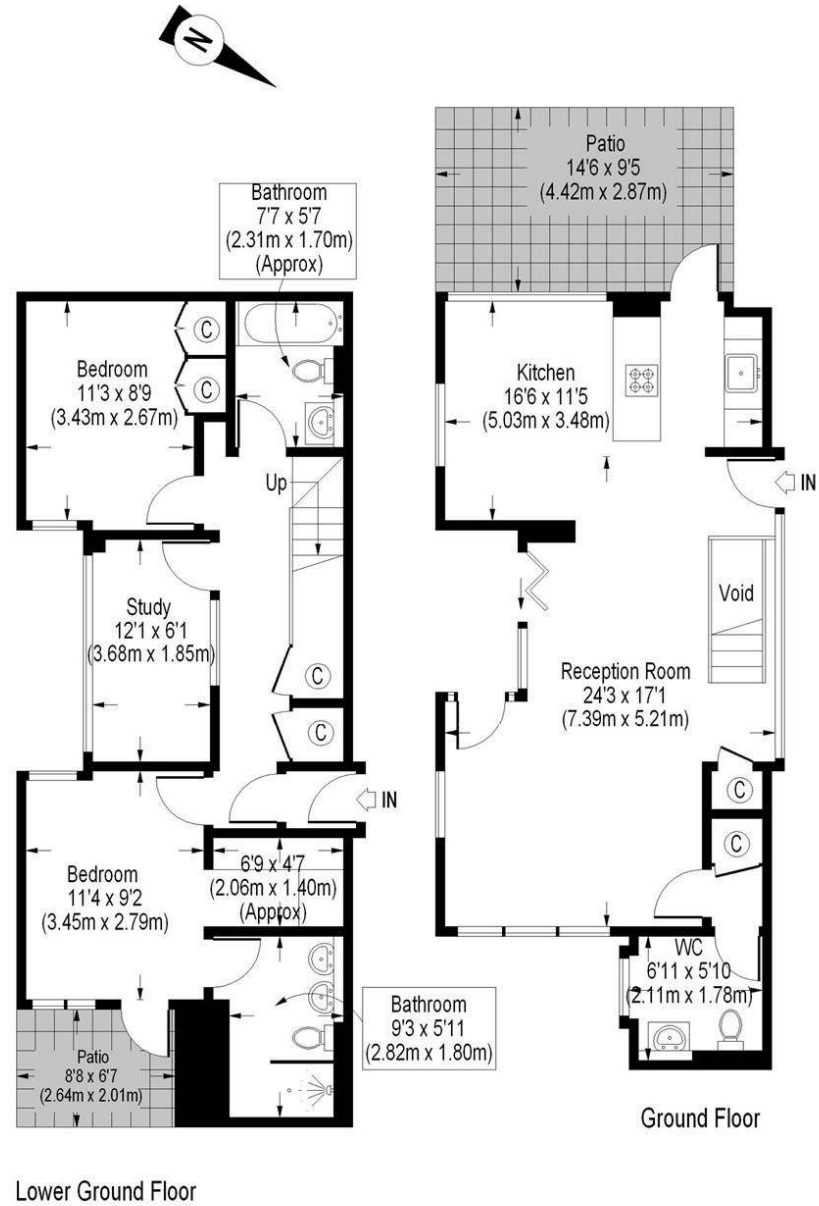

Approximate Gross Internal Area  
(Excluding Void)  
1117 Sq.Ft. / 103.8 Sq.M.

Floor Plans are illustrative purposes only and not to scale.  
Compliant with RICS code of measuring practice.

## Contact

### 1 Domus Nova Notting Hill

17 Kensington Park Road, London W11 2EU

020 7727 1717

[nottinghill@domusnova.com](mailto:nottinghill@domusnova.com)

### 2 Domus Nova Bayswater

78 Westbourne Grove, London W2 5RT

020 7221 7817

[bayswater@domusnova.com](mailto:bayswater@domusnova.com)

### 3 Domus Nova Property Management

37 Alexander Street, London W2 5NU

020 7908 9338

[management@domusnova.com](mailto:management@domusnova.com)

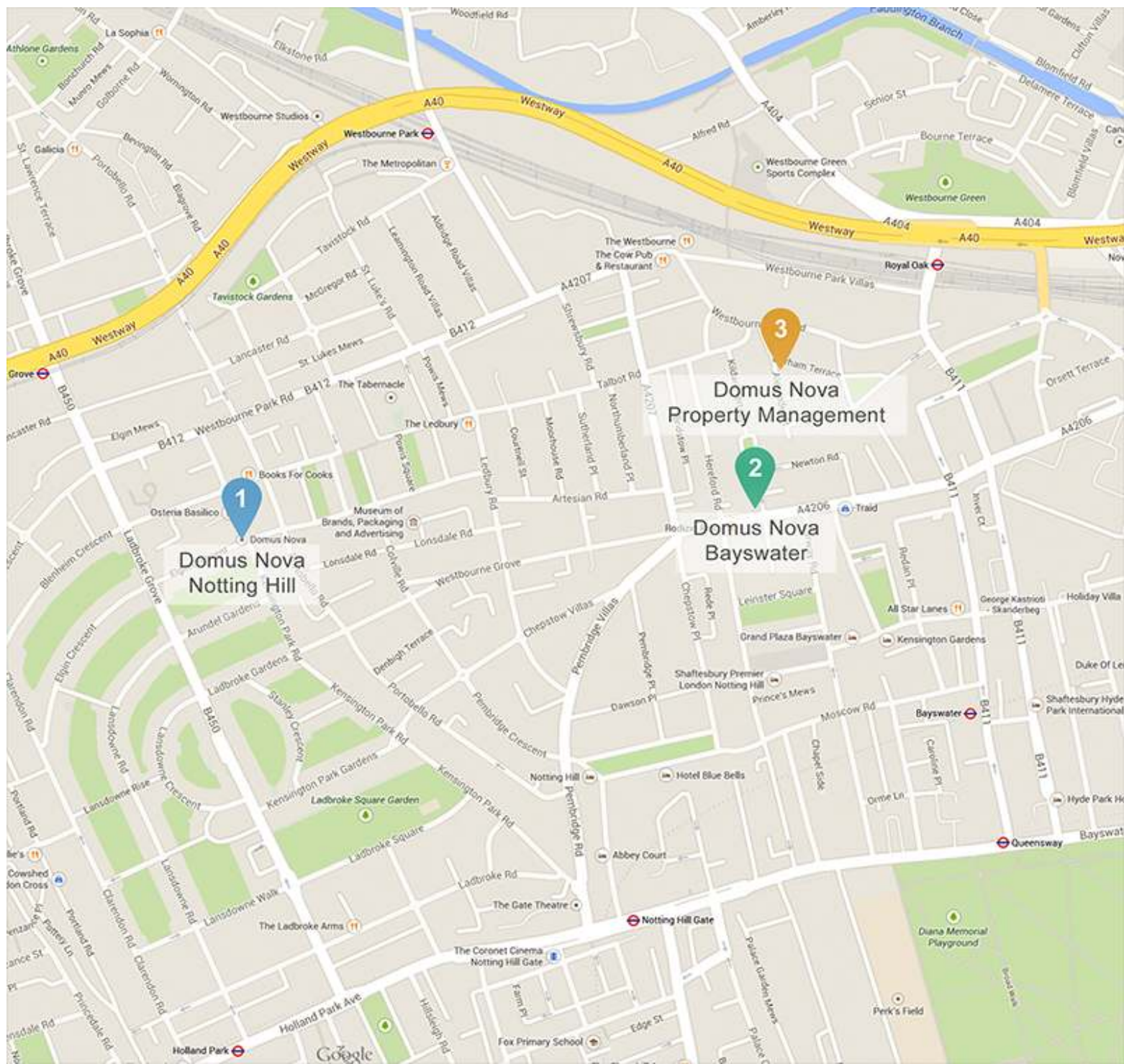



**DOMUSNOVA.COM**