



Fern Lane | | Hounslow | TW5 0HH

£484,950

Positioned on this most sought after road in Heston comes this three bedroom end of terrace home, the ideal family property for a first time buyer and available with no onward chain. Extended to the rear the property offers two reception rooms, an extended kitchen, a downstairs shower and an upstairs shower room. Added benefits include side access, an own driveway, good size rear garden and a brick built outbuilding. The property in our opinion is in good order throughout, but does have scope for further improvements.

## Tenure

Freehold

## Council Tax Band

D

## Viewing Arrangements

Strictly by appointment

## Contact Details

10 Central Parade

New Heston Road

Heston

Middlessex

TW5 0LH

020 8570 7258

heston@shawandcoestates.com

www.shawandcoestates.com



GROUND FLOOR  
APPROX. FLOOR  
AREA 728 SQ.FT.  
(67.6 SQ.M.)

TOTAL APPROX. FLOOR AREA 1047 SQ.FT. (97.2 SQ.M.)

Whilst every attempt has been made to ensure the accuracy of the floor plan contained here, measurements of doors, windows, rooms and any other items are approximate and no responsibility is taken for any error, omission, or mis-statement. This plan is for illustrative purposes only and should be used as such by any prospective purchaser. The services, systems and appliances shown have not been tested and no guarantee as to their operability or efficiency can be given  
Made with Metropix ©2020

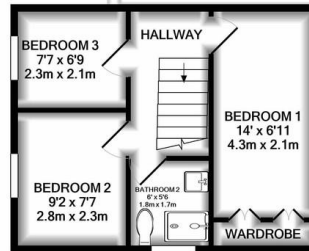

1ST FLOOR  
APPROX. FLOOR  
AREA 319 SQ.FT.  
(29.6 SQ.M.)

%epcGraph\_c\_1\_349%

Agents Note: Whilst every care has been taken to prepare these particulars, they are for guidance purposes only. All measurements are approximate and for general guidance purposes only and whilst every care has been taken to ensure their accuracy, they should not be relied upon and potential buyers/tenants are advised to recheck the measurements