



Laurel Gardens, W7

£750,000

*** Offers In Excess Of *** A simply stunning example of a beautiful four double bedroom family home with south-facing garden, nestled away in this sought after tranquil location. A 'Turn Key' property for it's new owners to move straight into and enjoy.



*** Offers In Excess Of *** Presented in excellent condition by it's current owners, internal viewing is highly recommended to appreciate the quality, abundance of character and period features throughout. The ground floor comprises separate reception, dining/kitchen leading to a mature landscaped south-facing garden. First floor offers three double bedrooms and family bathroom. The loft has been converted to provide a master bedroom with additional separate shower-room.

Ideally located a short stroll to Hanwell Station (Crossrail) and the renowned 'Bunny Park'. Well regarded schools to choose from locally.

- Four Double Bedrooms • Two Bath/Shower-Rooms • South-Facing Garden •
- Hanwell Station (Crossrail) • Bunny Park • Well Regarded Schools •



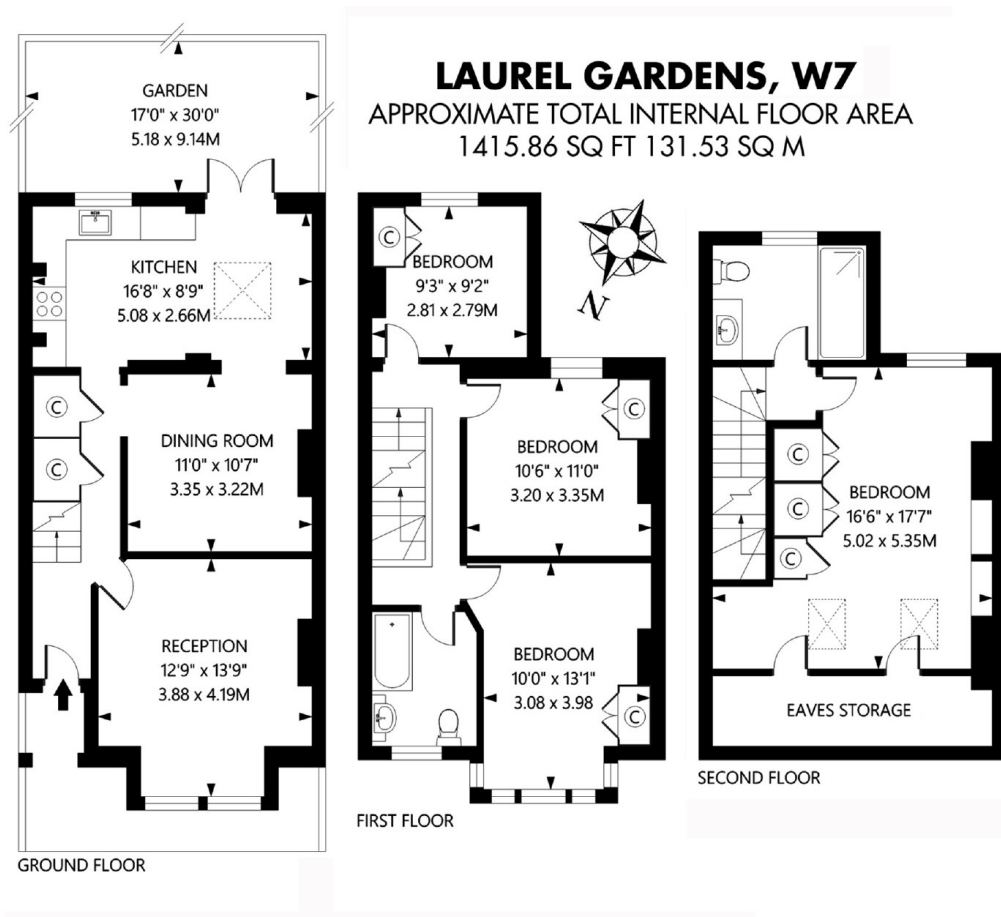

Robertson Smith & Kempson Hanwell Sales
69 Greenford Avenue,
London, W7 1LL
020 8566 2339
hanwellsales@robertsonsmithandkempson.co.uk

Energy Rating: C. We aim to make our particulars both accurate and reliable. However they are not guaranteed; nor do they form part of an offer or contract. If you require clarification on any points then please contact us, especially if you're traveling some distance to view. Please note that appliances and heating systems have not been tested and therefore no warranties can be given as to their good working order.