



Church Road | Hounslow | TW5 0LA

£374,950

The ideal starter home and well presented is this two bedroom mid terrace property. Available with no onward chain, the property briefly consists of a lounge, kitchen, a bathroom suite and a good size rear garden. Positioned walking distance to local schools, shops and bus stops. This delightful home would suit a first time buyer, for a viewing please contact us.

Tenure

Freehold

Council Tax Band

C

Viewing Arrangements

Strictly by appointment

Contact Details

10 Central Parade

New Heston Road

Heston

Middlesex

TW5 0LH

020 8570 7258

heston@shawandcoestates.com

www.shawandcoestates.com

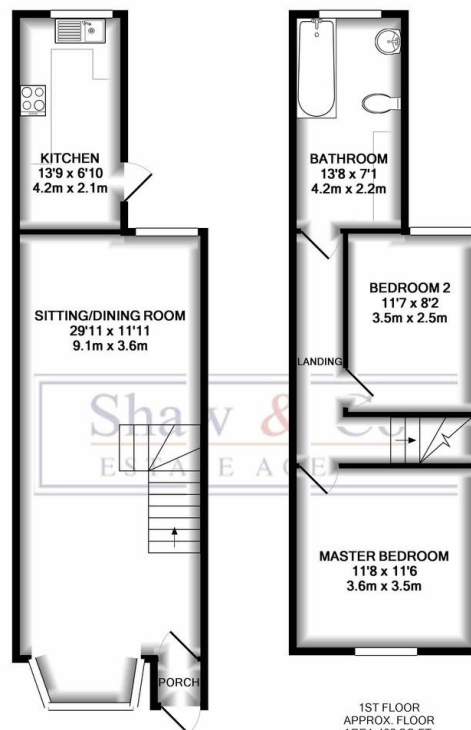

GROUND FLOOR
APPROX. FLOOR
AREA 441 SQ.FT.
(41.0 SQ.M.)

1ST FLOOR
APPROX. FLOOR
AREA 402 SQ.FT.
(37.4 SQ.M.)

TOTAL APPROX. FLOOR AREA 843 SQ.FT. (78.3 SQ.M.)

Whilst every attempt has been made to ensure the accuracy of the floor plan contained here, measurements of doors, windows, rooms and any other items are approximate and no responsibility is taken for any error, omission, or mis-statement. This plan is for illustrative purposes only and should be used as such by any prospective purchaser. The services, systems and appliances shown have not been tested and no guarantee as to their operability or efficiency can be given.
Made with Metropix ©2019

Energy Efficiency Rating

	Current	Potential
Very energy efficient - lower running costs		
(92 plus) A		
(81-91) B		
(69-80) C		
(55-68) D	63	71
(39-54) E		
(21-38) F		
(1-20) G		

Agents Note: Whilst every care has been taken to prepare these particulars, they are for guidance purposes only. All measurements are approximate and for general guidance purposes only and whilst every care has been taken to ensure their accuracy, they should not be relied upon and potential buyers/tenants are advised to recheck the measurements