



## Lynette Avenue, SW4

**£1,395,000**

A rare opportunity to acquire a substantial, unextended terraced Victorian family house which could readily be refurbished and extended to create a simply stunning property.

Lynette Avenue being within the 'Abbeville Village' is super convenient for Clapham Common and the underground station at Clapham South.

- Unextended Victorian Terrace
- Five Bedrooms
- Two Reception Rooms
- Dining Room And Kitchen
- Cellar
- Abbeville Village Location

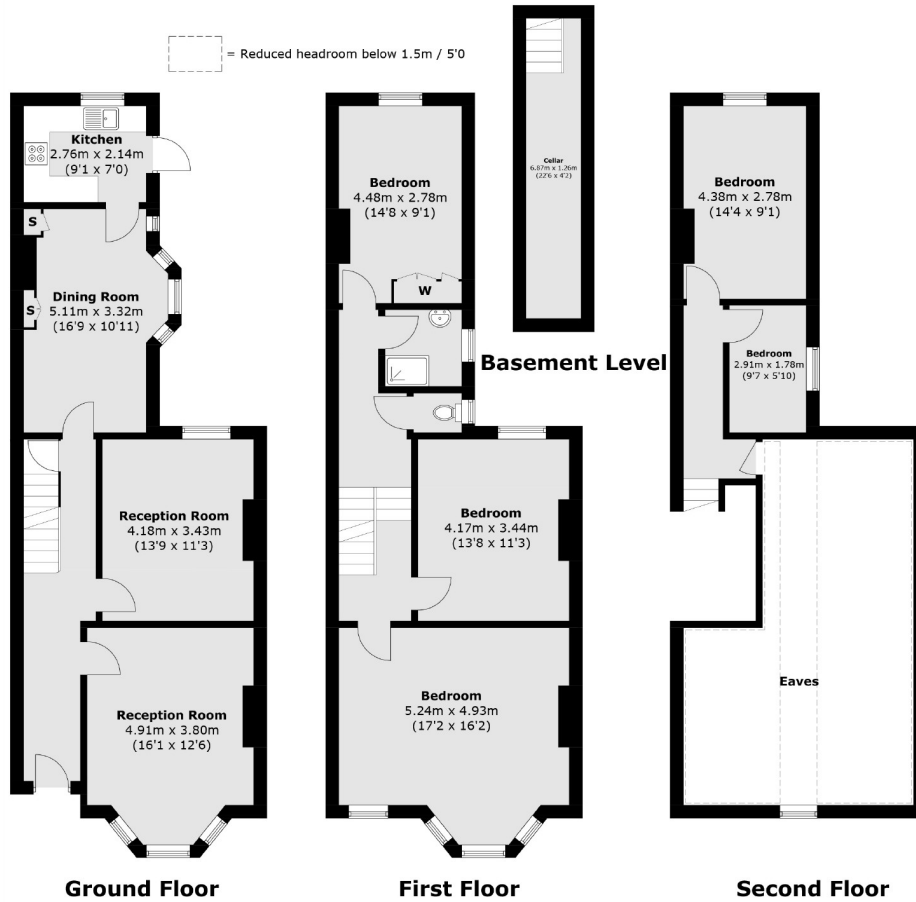

Total area (approx.): 165.5 sq. m (1,781.4 sq. ft)  
 (Including Basement / Excluding Eaves)

Jacksons Clapham  
 73 Abbeville Road  
 London  
 SW4 9JN  
 020 8875 7995  
[clapham.sales@jacksonsestateagents.com](mailto:clapham.sales@jacksonsestateagents.com)

Energy Rating: D We aim to make our particulars both accurate and reliable. However they are not guaranteed; nor do they form part of an offer or contract. If you require clarification on any points then please contact us, especially if you're traveling some distance to view. Please note that appliances and heating systems have not been tested and therefore no warranties can be given as to their good working order.