



Kensington Way, Borehamwood WD6

MORRIS & JOEL

We have pleasure in being able to offer for sale as **SOLE AGENTS**, this Spacious and **CHAIN FREE** Two Double Bedrooms apartment situated on the top floor of this delightful purpose built block.

MORRIS & JOEL

A: 48 Shenley Road
Borehamwood
Hertfordshire, WD6 1DS

Two Double Bedrooms | Large Reception Room | Fitted Kitchen

T: 020 3621 8080

Bathroom/WC | Loft Storage | Residents & Visitors Parking

E: enquiries@morrisandjoel.com

CHAIN FREE |||

W: www.morrisandjoel.com

£299,950 Leasehold

DESCRIPTION

We have pleasure in being able to offer for sale as **SOLE AGENTS**, this Spacious and **CHAIN FREE** Two Double Bedrooms apartment situated on the top floor of this delightful purpose built block. The property is presented in good condition throughout and offers a good size lounge with an arch leading to a fully fitted kitchen. In addition, there is a modern fully tiled bathroom, access to a large loft area ideal for storage. The development also benefits from a large amount of residents and visitor parking. Kensington Way is a very popular development and is located close to many local amenities in Borehamwood and just a short walk from London bus links, 2 minutes from the A1 and close access to the mainline station. Viewing is Highly Recommended.

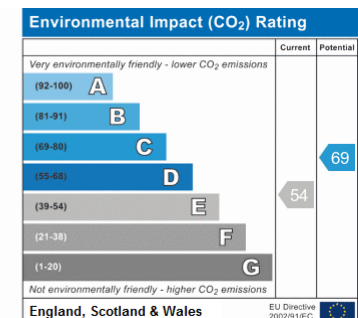
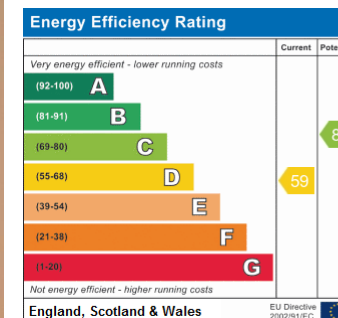



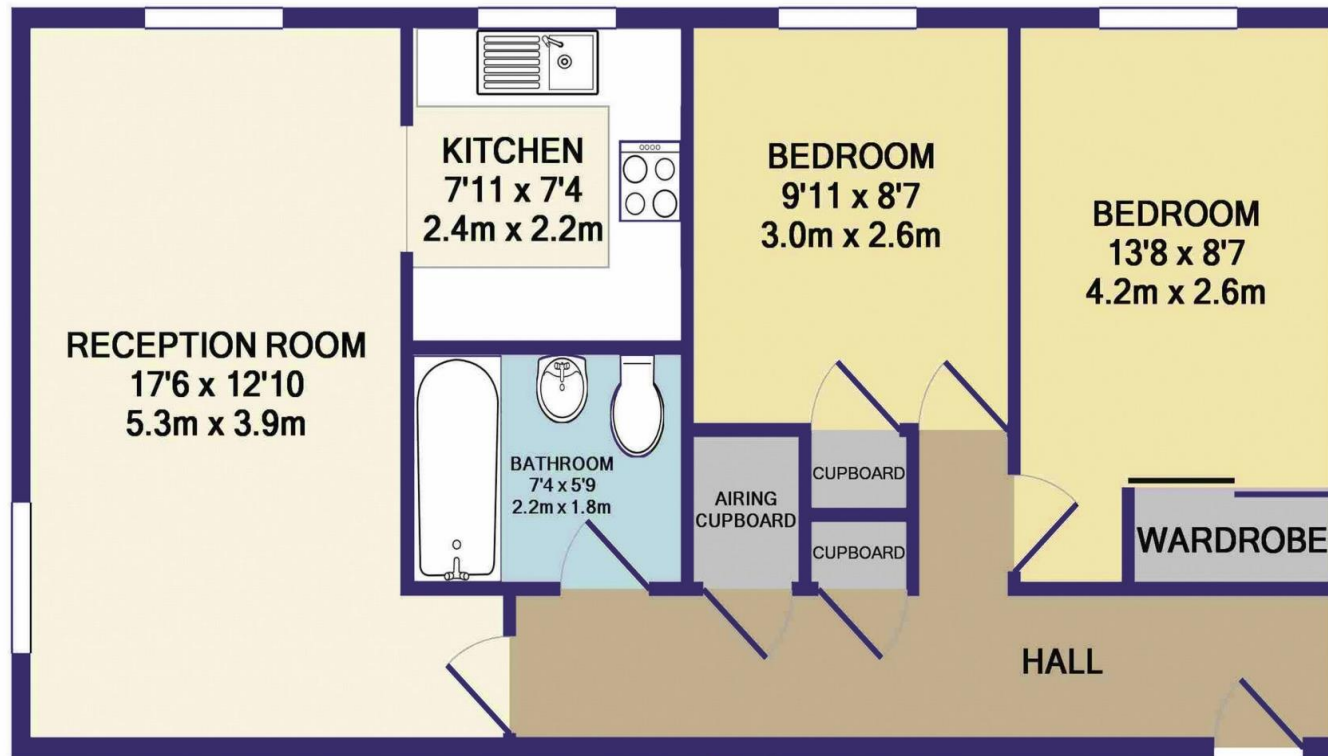

MORRIS & JOEL

TOTAL APPROX. FLOOR AREA 685 SQ.FT. (63.6 SQ.M.)

Whilst every attempt has been made to ensure the accuracy of the floor plan contained here, measurements of doors, windows, rooms and any other items are approximate and no responsibility is taken for any error, omission, or mis-statement. This plan is for illustrative purposes only and should be used as such by any prospective purchaser. The services, systems and appliances shown have not been tested and no guarantee as to their operability or efficiency can be given

Made with Metropix ©2018

FOR CLARIFICATION

We wish to inform prospective purchasers that we have prepared these sales particulars as a general guide. We have not carried out a detailed survey, nor tested the services, appliances and specific fittings. Room sizes are approximate and rounded; they are taken between internal wall surfaces and therefore included cupboards/shelves, etc. Accordingly, they should not be relied upon for carpets and furnishings. Formal notice is also given that all fixtures and fittings, carpeting, curtains/blinds and kitchen equipment, whether fitted or not, are deemed removable by the vendor unless specifically itemised within these particulars.

MORRIS & JOEL