



Whitehouse Avenue

MORRIS & JOEL

# As Sole Agents, we are delighted to offer FOR SALE this charming Three Bedroom Mid-Terraced house situated within the catchment area of Yavneh College School.



A: 48 Shenley Road  
Borehamwood  
Hertfordshire, WD6 1DS

T: 020 3621 8080

E: enquiries@morrisandjoel.com

W: www.morrisandjoel.com

Mid-Terraced House | Three Bedrooms | Reception/Dining room

Fully Fitted Kitchen | Shower Room | Downstairs WC

Garden | Two Separate Garages | Close To All Local Amenities | Viewings Highly Recommended

**£485,000**

## DESCRIPTION

As Sole Agents, we are delighted to offer FOR SALE this charming Three Bedroom Mid-Terraced house situated within the catchment area of Yavneh College School. The property comprises of 1124 sq ft and benefits from a fully fitted kitchen, reception room/dining room, shower room, downstairs WC, well maintained rear garden, and the added attraction of two separate garages. Whitehouse Avenue is conveniently located close to Borehamwood High Street offering a huge selection of shops, restaurants and coffee bars as well as convenient transportation links (Elstree and Borehamwood Thames Link Station).

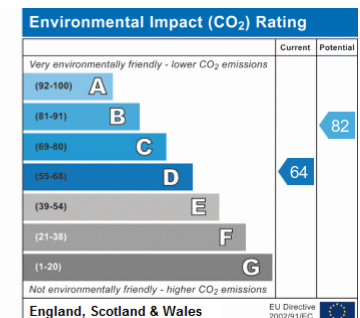
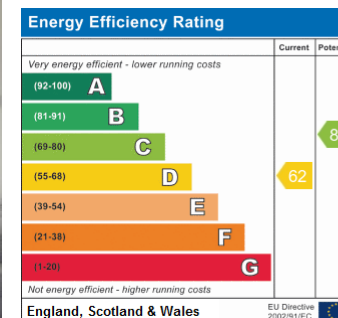



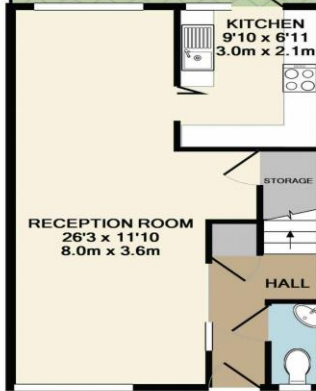
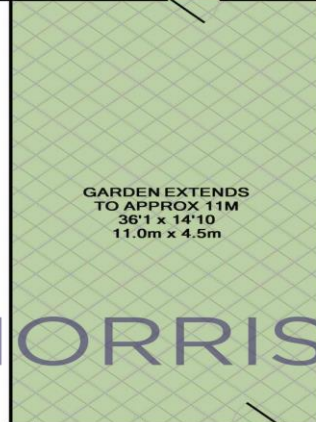
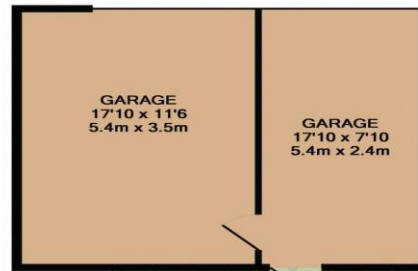

GROUND FLOOR  
APPROX. FLOOR  
AREA 734 SQ.FT.  
(68.2 SQ.M.)

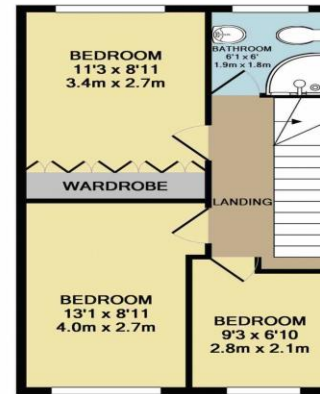

1ST FLOOR  
APPROX. FLOOR  
AREA 390 SQ.FT.  
(36.2 SQ.M.)

TOTAL APPROX. FLOOR AREA 1124 SQ.FT. (104.4 SQ.M.)

Whilst every attempt has been made to ensure the accuracy of the floor plan contained here, measurements of doors, windows, rooms and any other items are approximate and no responsibility is taken for any error, omission, or mis-statement. This plan is for illustrative purposes only and should be used as such by any prospective purchaser. The services, systems and appliances shown have not been tested and no guarantee as to their operability or efficiency can be given.  
Made with Metropix ©2017

MORRIS & JOEL

**FOR CLARIFICATION**

We wish to inform prospective purchasers that we have prepared these sales particulars as a general guide. We have not carried out a detailed survey, nor tested the services, appliances and specific fittings. Room sizes are approximate and rounded; they are taken between internal wall surfaces and therefore included cupboards/shelves, etc. Accordingly, they should not be relied upon for carpets and furnishings. Formal notice is also given that all fixtures and fittings, carpeting, curtains/blinds and kitchen equipment, whether fitted or not, are deemed removable by the vendor unless specifically itemised within these particulars.

MORRIS & JOEL