

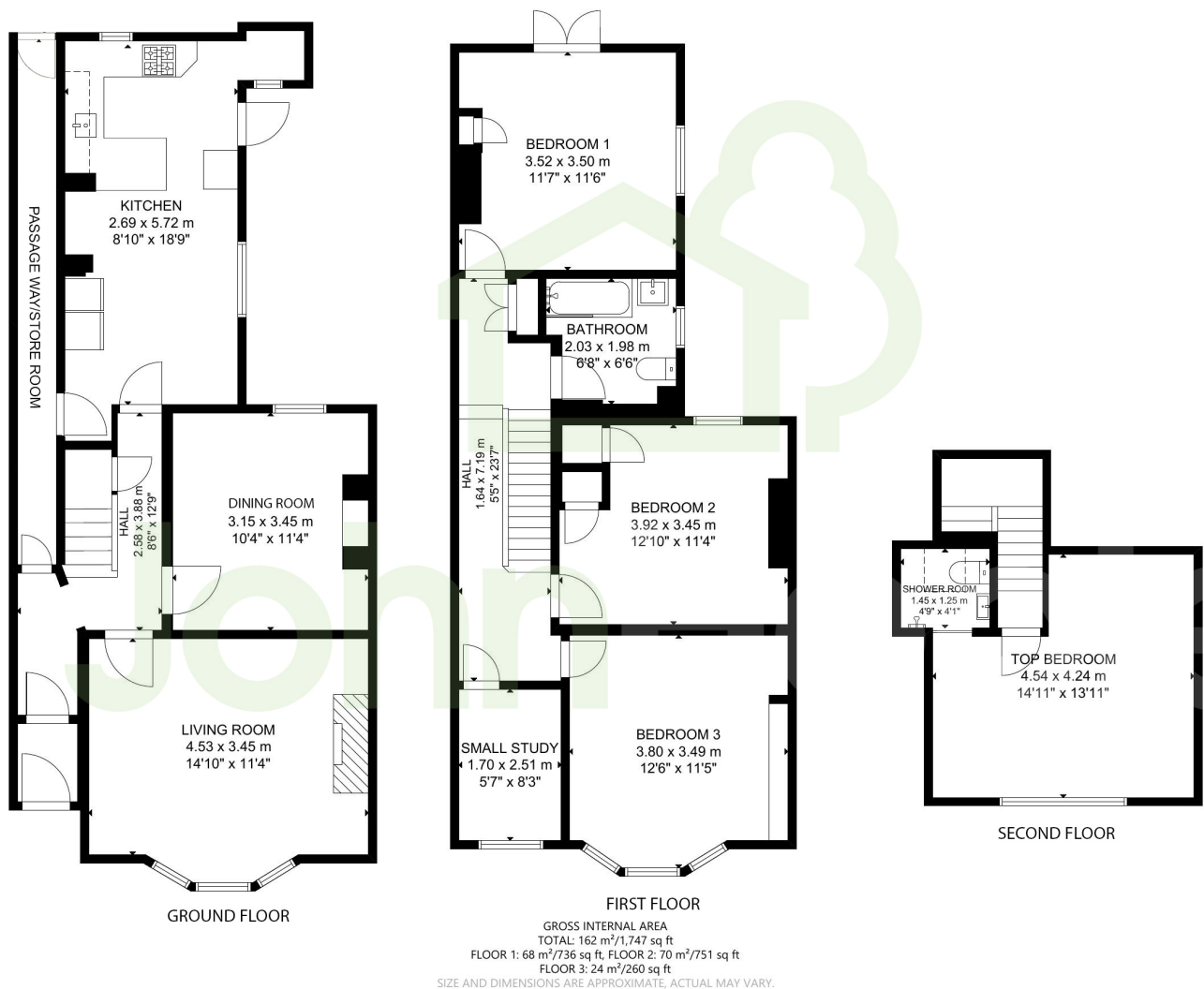

30 Hampstead Road, Brighton, BN1 5NG
£765,000



01273 555115

info@johnhoole.co.uk

johnhoole.co.uk

214 Dyke Road | Brighton | BN1 5AA

Agents note: All measurements are approximate and whilst every attempt has been made to ensure accuracy they are for general guidance only and must not be relied on. The fixture and fittings referred to have not been tested and therefore no guarantee can be given that they are in working order. Internal photographs are reproduced for general information and it must not be inferred that any item shown is included with the property.





John Hoole Estate Agents are delighted to offer to the market this handsome Victorian mid-terraced property, situated on an attractive street boasting breath-taking views across Preston Park and beyond to the Downs. With spacious accommodation provided over three floors, the property presents as a wonderfully balanced family home, with generous-sized bedrooms throughout and an additional room to be used either as a study or 5th bedroom. With two separate reception rooms in addition to the kitchen breakfast room, there is versatility in the way the ground floor can be used, and a quirky feature is the enclosed passageway running the length of the property giving access to the rear garden but also very useful storage capacity. To the other side of the property and accessed from the kitchen, there is further storage and utility space outside and a working W.C.

The rear garden, mainly laid to lawn, can also be accessed from a room on the first floor, currently used as an occasional bedroom but could alternatively work well as an informal lounge/den. There is a good-sized family bathroom on the first floor and the top floor bedroom also benefits from an en suite wet room - ideal as a master bedroom or perhaps a guest suite.

The property is within a highly sought-after area, not only being close to commuter links and amenities, but also in catchment to good schools. Early viewing is recommended to avoid disappointment.



- Victorian bay fronted terraced house
- Spacious family home
- 4 bedrooms, 1 en-suite
- Study/5th bedroom
- Kitchen breakfast room
- Integrated washing machine and dishwasher
- 2 reception rooms
- West facing garden
- Close to amenities and train stations
- Spectacular views over South Downs