

# FLETCHERS

ESTATE AGENTS



## Chiswick High Road, W4

£375,000

A superb first floor flat which has been completely renovated to a high specification. The open-plan kitchen/reception room has bespoke fittings and good storage, including a breakfast bar and dining area with fantastic views over Turnham Green.

A central location with the boutique shops, cafés and restaurants of Chiswick High Road and Turnham Green available on the doorstep. Chiswick Park station is just around the corner for underground links.

- First Floor Flat • Modern Finish • Oak Flooring • Bespoke Kitchen • Private Entrance • Good Storage •

# FLETCHERS

ESTATE AGENTS

---

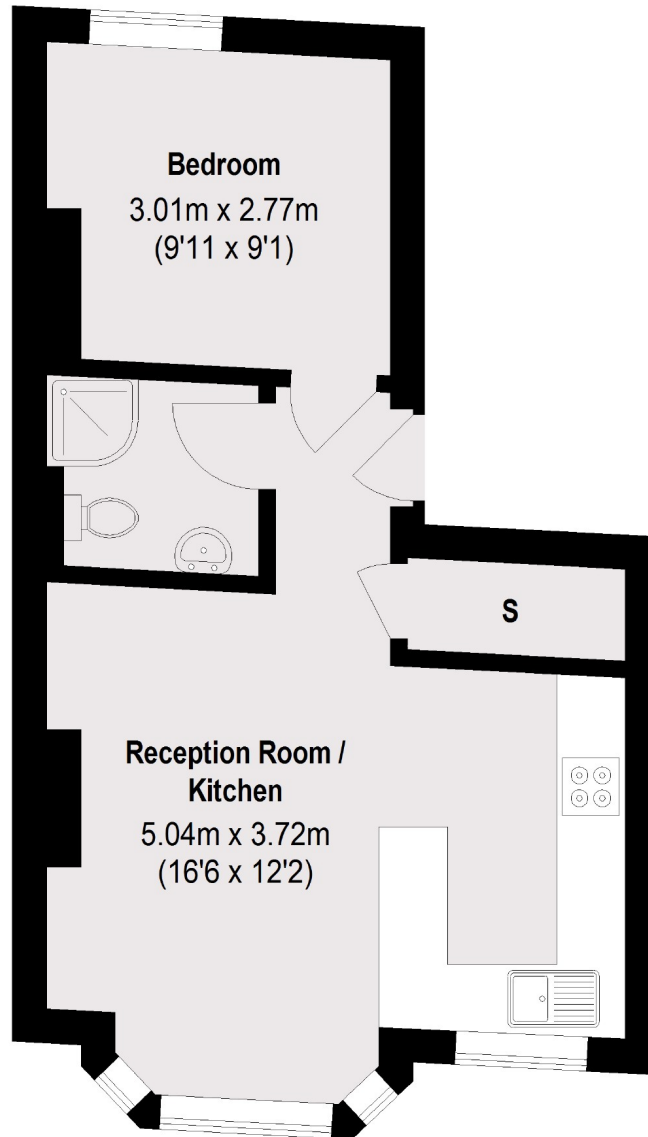

Total area (approx.): 35.39 sq. m (381 sq. ft)

---

Fletchers Chiswick Turnham Green Sales  
58 Turnham Green Terrace, London, W4 1QP  
020 8987 3000  
[chiswicksales@fletcherestates.com](mailto:chiswicksales@fletcherestates.com)

Energy Rating: C. We aim to make our particulars both accurate and reliable. However they are not guaranteed; nor do they form part of an offer or contract. If you require clarification on any points then please contact us, especially if you're traveling some distance to view. Please note that appliances and heating systems have not been tested and therefore no warranties can be given as to their good working order.