

FLETCHERS

ESTATE AGENTS



Wilkinson Way, W4

£349,950

A spacious and well maintained one bedroom apartment on the first floor of a purpose built block. With a separate eat-in kitchen and reception room both with plenty of natural light, and great storage throughout.

An abundance of amenities are within walking distance with Southfield Rec, Chiswick High Road, Turnham Green Terrace and Acton High Street. There is an excellent bus service with a stop on Southfield Road.

- One Bedroom • First Floor • Eat-In Kitchen • Great Condition • Built In Storage • Off-Street Parking •

FLETCHERS

ESTATE AGENTS

First Floor

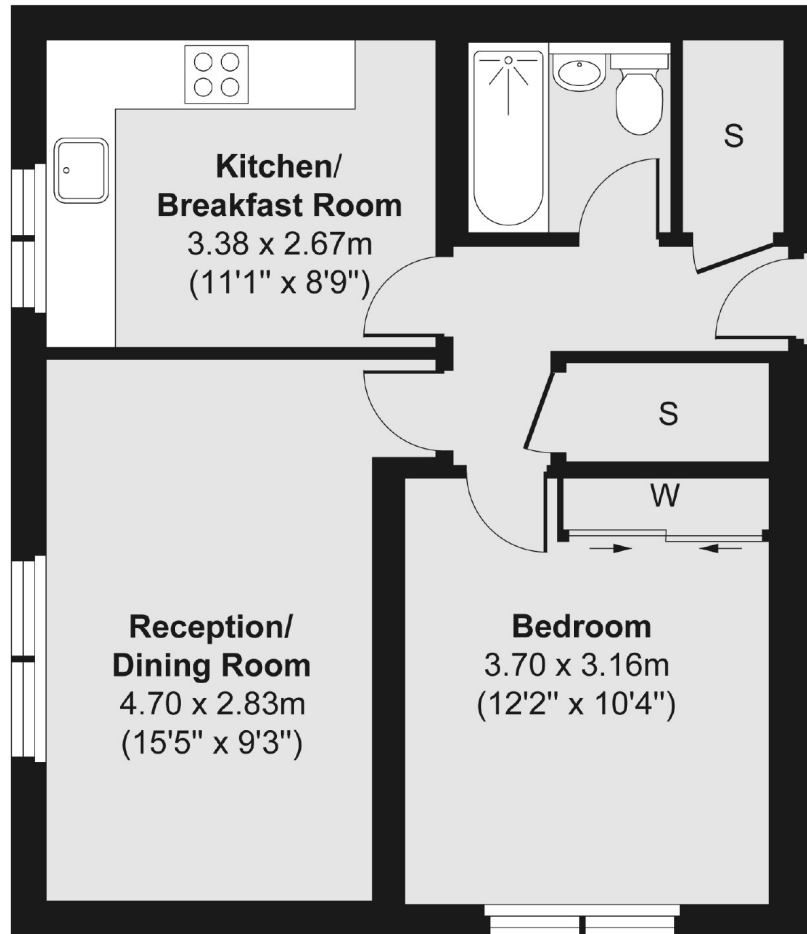

Total area (approx.) 47.32 sq. m (509 sq. ft)

Fletchers Chiswick Turnham Green Sales
58 Turnham Green Terrace, London, W4 1QP
020 8987 3000
chiswicksales@fletcherestates.com

Energy Rating: C. We aim to make our particulars both accurate and reliable. However they are not guaranteed; nor do they form part of an offer or contract. If you require clarification on any points then please contact us, especially if you're traveling some distance to view. Please note that appliances and heating systems have not been tested and therefore no warranties can be given as to their good working order.