

FLETCHERS

ESTATE AGENTS



Chiswick High Road, W4

£439,950

A first floor apartment in a central spot in Chiswick that comes with a lift and private off-street parking. The property offers great internal space (c. 578 sq foot), an eat-in kitchen, large reception room and bedroom with built in wardrobes.

A fantastic location conveniently located on the Chiswick High Road, with a selection of shops, restaurants and bars on the doorstep. Turnham Green and Stamford Brook Stations are just around the corner.

- One Bedroom • Lift Access • Eat-in Kitchen • Large Reception • Private Parking Space • Central Location •

First Floor

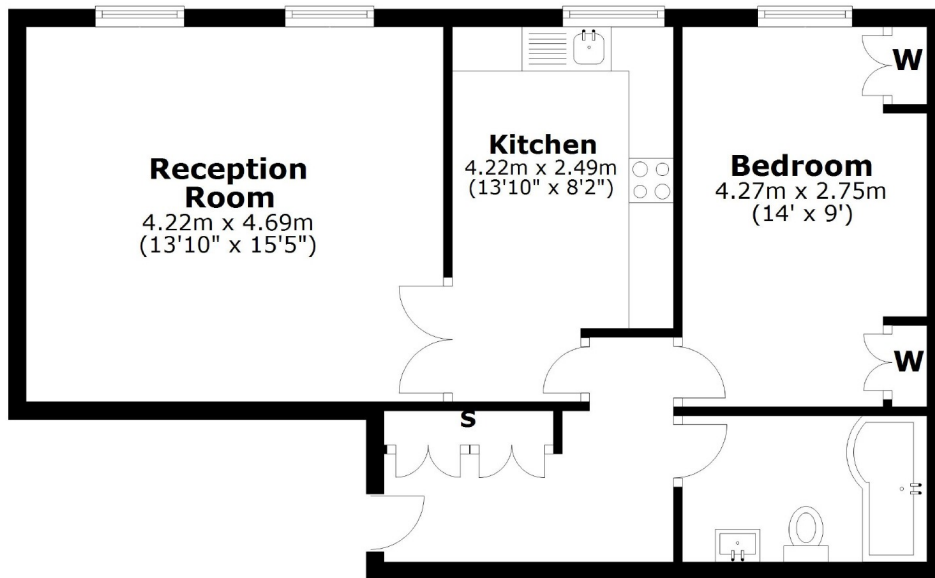

Total area: approx. 53.7 sq. metres (578.0 sq. feet)

Fletchers Chiswick Turnham Green Sales
58 Turnham Green Terrace, London, W4 1QP
020 8987 3000
chiswicksales@fletcherestates.com

Energy Rating: C. We aim to make our particulars both accurate and reliable. However they are not guaranteed; nor do they form part of an offer or contract. If you require clarification on any points then please contact us, especially if you're traveling some distance to view. Please note that appliances and heating systems have not been tested and therefore no warranties can be given as to their good working order.