

Frank Harris & Co.



Ben Jonson House, EC2Y

£525,000

A one bedroom flat with an open plan updated kitchen and bathroom. The reception room faces south with a full width window and door opening onto the balcony/ fire exit overlooking the podium. The bedroom also faces south with a full width window and a fitted cupboard.

The Barbican is a short walk to the future Crossrail station at Farringdon, which is due to open in 2022, with journey times cut to approximately 30 minutes to Heathrow airport, 4 minutes to Bond Street and 8 minutes to Canary Wharf.

- Type F2C • Second Floor • South Facing •
- Open Plan Kitchen • Extended Lease • No Onward Chain •

Second Floor

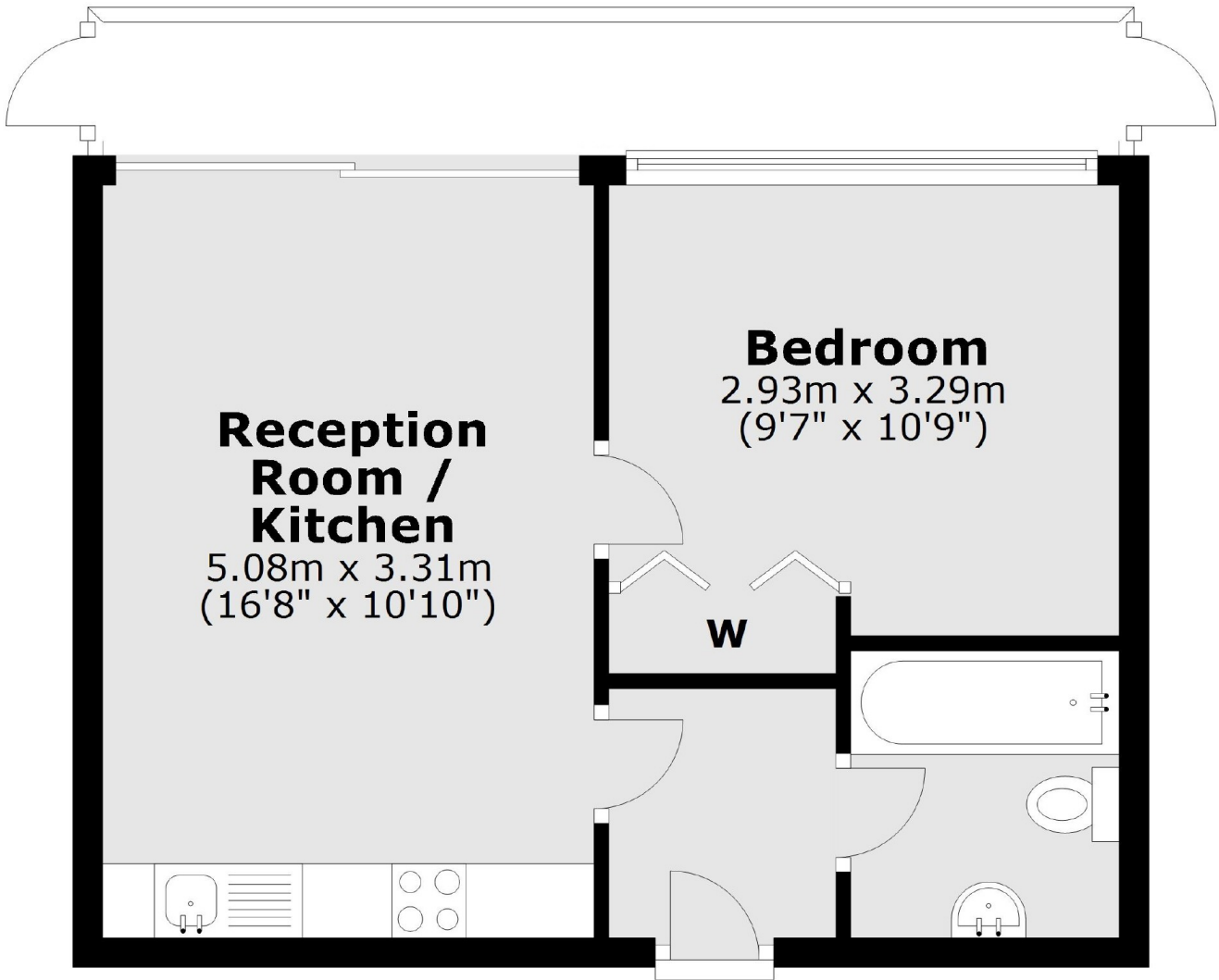

Total area: approx. 34.8 sq. metres (374.6 sq. feet)

Frank Harris & Co. Barbican and City
87 Long Lane, London,
EC1A 9ET
020 7600 7000
city@frankharris.co.uk

Energy Rating: TBC. We aim to make our particulars both accurate and reliable. However they are not guaranteed; nor do they form part of an offer or contract. If you require clarification on any points then please contact us, especially if you're traveling some distance to view. Please note that appliances and heating systems have not been tested and therefore no warranties can be given as to their good working order.