



Addington Close, UB2

£435,000

Offering over 800 sq ft this well presented spacious ground floor flat with private garden and allocated parking space.



Two large double bedrooms, huge reception/kitchen/diner, family bathroom and direct access to a private garden. Plenty of storage throughout. A really well proportioned flat, filled with natural light and added benefits of a long lease (123 years).

On the borders of Hanwell, easy access to Hanwell Station (Crossrail) and many varied and frequent bus routes available locally. The much renowned 'Bunny Park' is a fantastic outdoor amenity locally to enjoy.

- Private Garden • Allocated Parking • Hanwell Station (Crossrail) •
 - Long Lease • Bunny Park • Excellent Condition •
-



Ground Floor

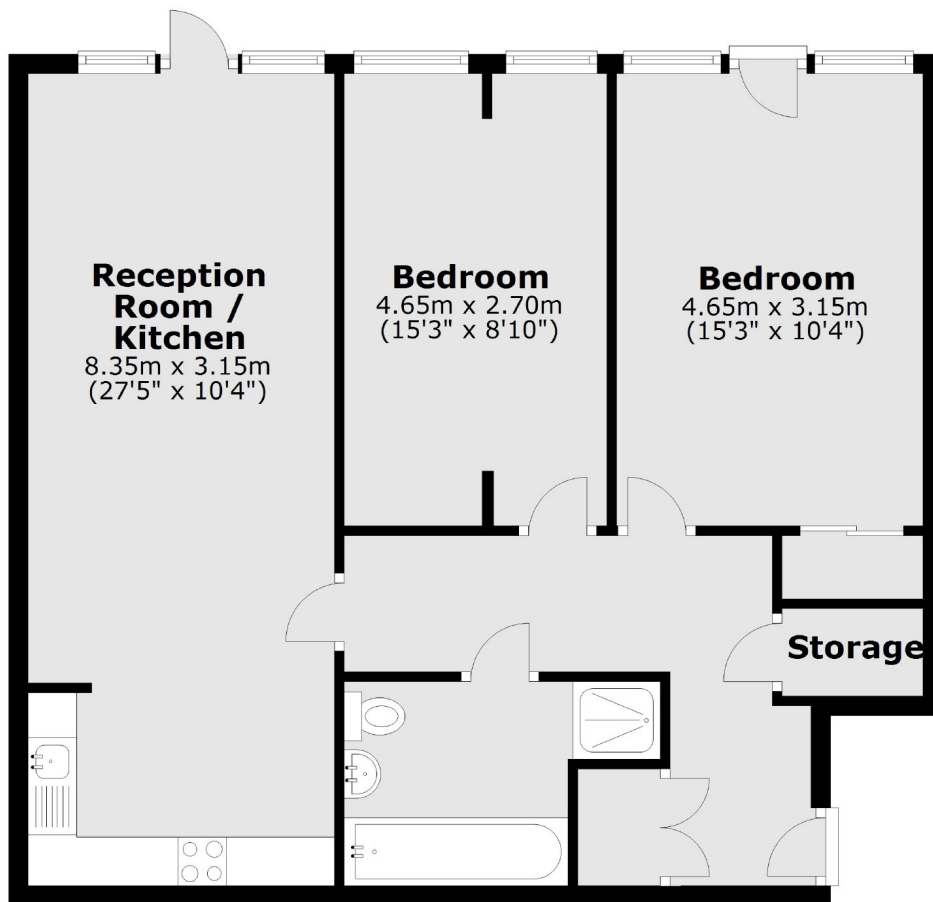

Total area: approx. 74.6 sq. metres (802.7 sq. feet)

Robertson Smith & Kempson Hanwell Sales
69 Greenford Avenue,
London, W7 1LL
020 8566 2339
hanwellsales@robertsonsmithandkempson.co.uk

Energy Rating: B. We aim to make our particulars both accurate and reliable. However they are not guaranteed; nor do they form part of an offer or contract. If you require clarification on any points then please contact us, especially if you're traveling some distance to view. Please note that appliances and heating systems have not been tested and therefore no warranties can be given as to their good working order.