

Shaw & Co
ESTATE AGENTS



Waterford House, 26 Thorney Mill Road, West Drayton, UB7 7DL

£294,950

Set in magnificent surroundings comes this two bedroom flat, also consisting of an en suite shower room and available on the top floor of this well cared for block. Situated in a private gated development, the property has canal views throughout and is only minutes away from West Drayton high Street with access to all amenities. Internally the property briefly consists of a good size lounge, kitchen and a three piece bathroom suite. Perfect for either a first time buyer or as a buy to let, viewings are highly recommended.



26 Waterford House

Approximate Gross Internal Area
743 sq ft - 69 sq m

Kitchen
11'5 x 5'10
3.47 x 1.77m

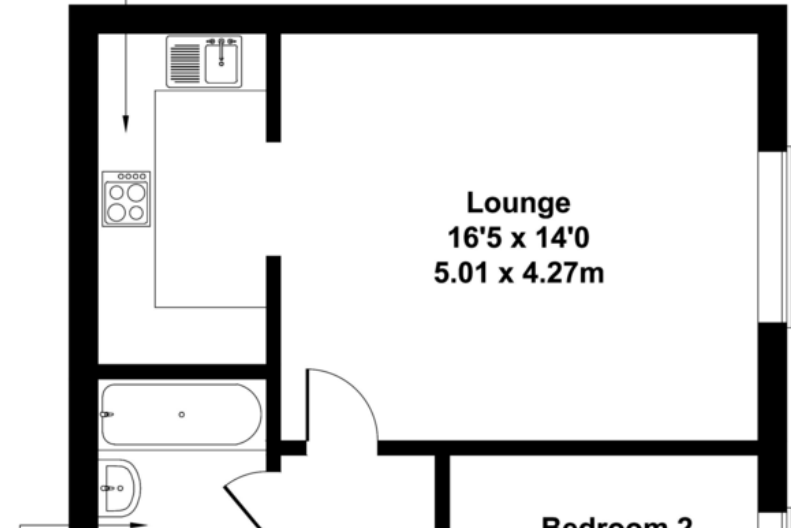

Lounge
16'5 x 14'0
5.01 x 4.27m

Bedroom 2

Score	Energy rating	Current	Potential
92+	A		
81-91	B		
69-80	C	76 c	80 c
55-68	D		
39-54	E		
21-38	F		
1-20	G		

10 Central Parade, New Heston
Road, Heston, Middlesex, TW5
0LH

www.shawandcoestates.com
020 8570 7258
heston@shawandcoestates.com

Agents Note: Whilst every care has been taken to prepare these particulars, they are for guidance purposes only. All measurements are approximate and for general guidance purposes only and whilst every care has been taken to ensure their accuracy, they should not be relied upon and potential buyers/tenants are advised to recheck the measurements