



At home in Alresford

23 Hasted Drive

ALRESFORD, HAMPSHIRE, SO24 9PX

Asking Price £439,950

- Sizeable Family Home
- Three Double Bedrooms
- Sitting Room and Family/Dining Room
- Fitted Kitchen and Sun Room
- South-Facing Garden with Rear Access
- Off-Road Parking To The Front

A well-presented three bedroom end of terrace family house, Hasted Drive is a popular cul-de-sac, with good access to the town centre, local schools and open countryside. The accommodation includes an L-shaped living room, a dining/family room, a fitted kitchen, cloakroom, small sun room, three double bedrooms and a bathroom. The rear garden has a sunny, south-facing aspect, with access from the rear and parking to the front.

The front door opens to a hallway, with a doorway into the fitted kitchen, which has a window overlooking the front garden. The garage has been converted into a family/dining room. There is a cloakroom under the stairs, and a sizeable L-shaped living room with double patio doors opening to the sun room, from where sliding doors open to the rear garden.

On the first floor landing, there are three double bedrooms, one of which has twin built-in double wardrobes. There is a good size bathroom with a corner bath and a separate shower cubicle.





The south-facing rear garden is mainly laid to lawn, with a patio area adjoining the rear of the house and stepping stones to a garden shed and rear access gate. The garden is enclosed by fencing. There is driveway parking to the front.

Alresford is a beautiful Georgian town known for its variety of independent shops, restaurants and inns located in stunning surroundings on the edge of the South Downs National Park. Attractions include the Watercress steam railway, schools for infant, junior and secondary education, several churches and an active and inclusive community. The cathedral city of Winchester is about 7 miles away and there is easy access to the south coast, the midlands and London via the road network. There is also mainline rail access to London from both Winchester and Alton. Southampton airport is only about half an hour away by car.

SERVICES

We understand that all mains services are connected.

LOCAL AUTHORITY INFORMATION

Winchester City Council
Council Tax Band:C

DIRECTIONS

From our office in East Street proceed down West Street and at the junction at the bottom of the hill turn left into Jacklyns Lane. Go under the railway bridge, up the hill and down the other side and take the first turn on the left into Linnets Road. Hasted Drive is the second road on the right hand side. No 23 will be found on the right hand side.



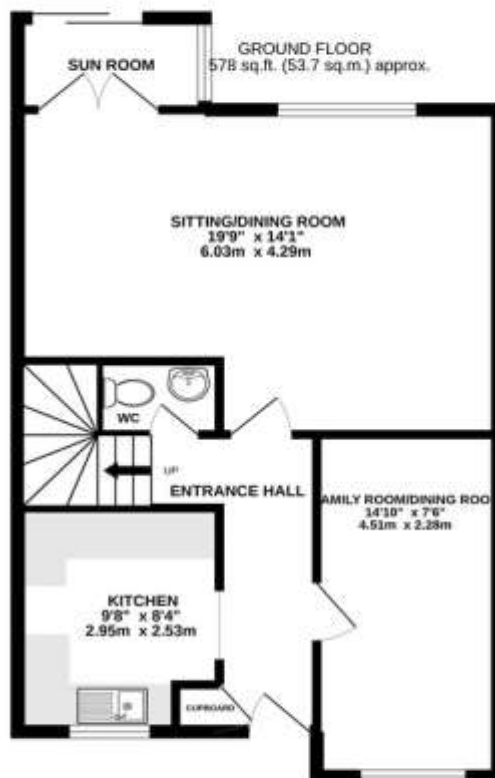
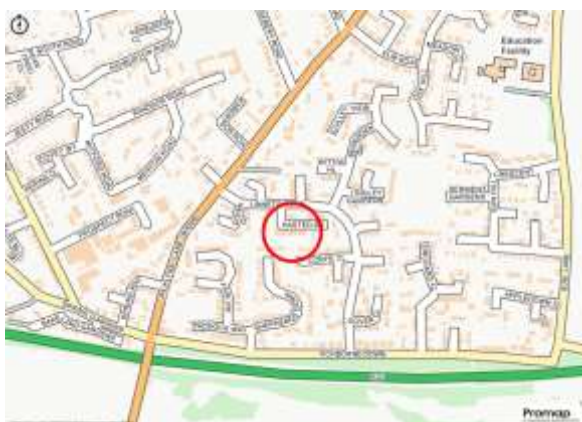

1ST FLOOR
533 sq.ft. (49.5 sq.m.) approx.

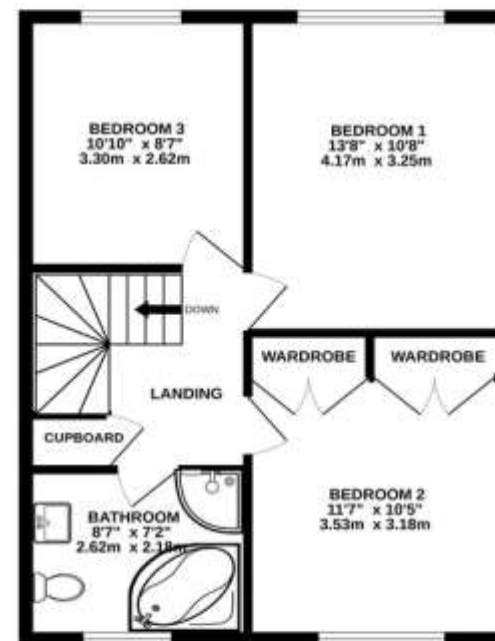

TOTAL FLOOR AREA: 1111 sq.ft. (103.2 sq.m.) approx.

Whilst every attempt has been made to ensure the accuracy of the floorplan contained here, measurements of doors, windows, rooms and any other items are approximate and no responsibility is taken for any error, omission or misstatement. This plan is for illustrative purposes only and should be used as such by any prospective purchaser. The services, systems and appliances shown have not been tested and no guarantee as to their operability or efficiency can be given.
Made with Autocad 12/2022

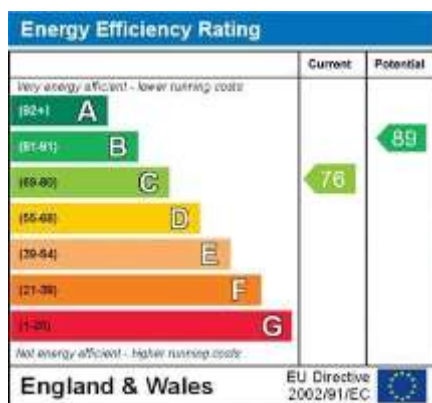

No. 11 Broad Street, Alresford, Hampshire, SO24 9AR

01962 736333

sales@hellards.co.uk | hellards.co.uk

IMPORTANT: we would like to inform prospective purchasers that these sales particulars have been prepared as a general guide only. A detailed survey has not been carried out, nor the services, appliances and fittings tested. Room sizes should not be relied upon for furnishing purposes and are approximate. If floor plans are included, they are for guidance only and illustration purposes only and may not be to scale. If there are any important matters likely to affect your decision to buy, please contact us before viewing the property.

Hellards