



A two bedroom ground floor flat situated on this sought after location, minutes away from local amenities including bus links, shops and schools.

Ideal for first time buyers the property briefly consists of a lounge, good sized bedrooms, kitchen and a bathroom suite.

Further benefits include ample parking spaces, communal gardens and a secure phone entry system for access.

Leasehold 86 years remaining

Ground Rent £100 p.a.

Service Charge £1200 p.a.

Score	Energy rating	Current	Potential
92+	A		
81-91	B		
69-80	C		70 c
55-68	D		
39-54	E	52 E	
21-38	F		
1-20	G		

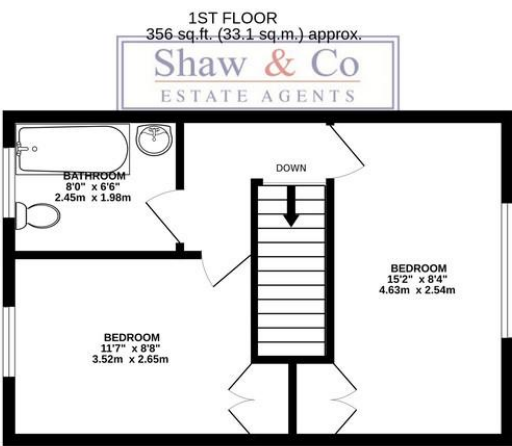
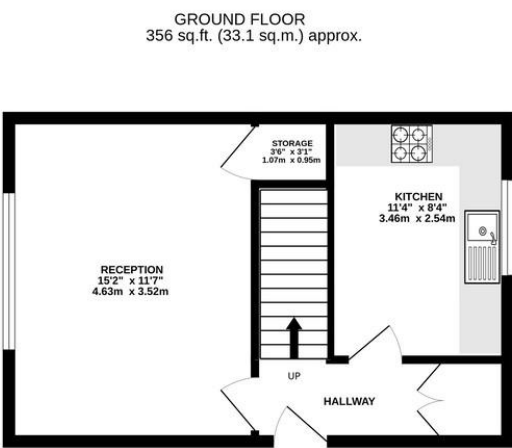

GROUND FLOOR FLAT
TOTAL FLOOR AREA: 712 sq.ft. (66.1 sq.m.) approx.
Whilst every attempt has been made to ensure the accuracy of the floorplan contained here, measurements of doors, windows, rooms and any other items are approximate and no responsibility is taken for any error, omission or mis-statement. This plan is for illustrative purposes only and should be used as such by any prospective purchaser. The services, systems and appliances shown have not been tested and no guarantee as to their operability or efficiency can be given.
Made with Metropix ©2023.