



Bowthorpe House
Manor Royal, West Sussex RH10 9RZ

£1,250

Astons are delighted to offer this two double bedroom ground floor apartment conveniently situated for Gatwick Airport, and Manor Royal industrial estate. The accommodation includes security entry system to communal foyer, entrance hall, 16ft Lounge/kitchen area, two double bedrooms, and bathroom. The property further benefits from Upvc double glazed windows, gas heating to radiators, allocated parking, and communal courtyard. * Available 28th June *

Bowthorpe House, Manor Royal, West Sussex RH10 9RZ

Members of the property ombudsman
Members of CMP for client money protection
holding deposit equivalent of one week rent
security deposit equivalent 5 weeks rent

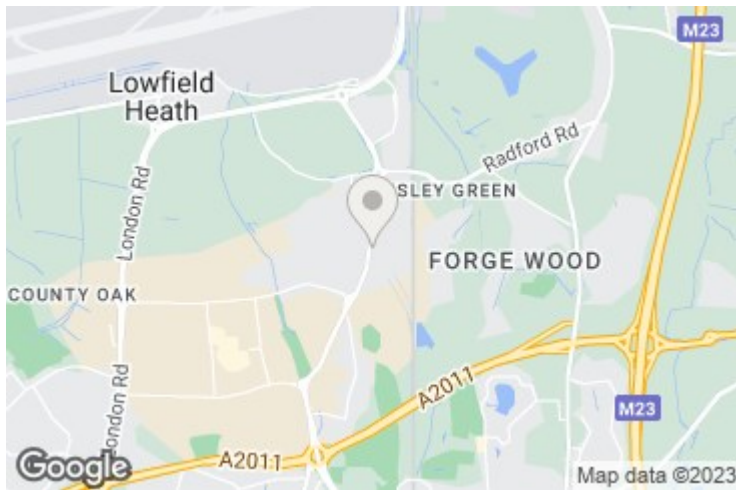

Ground Floor

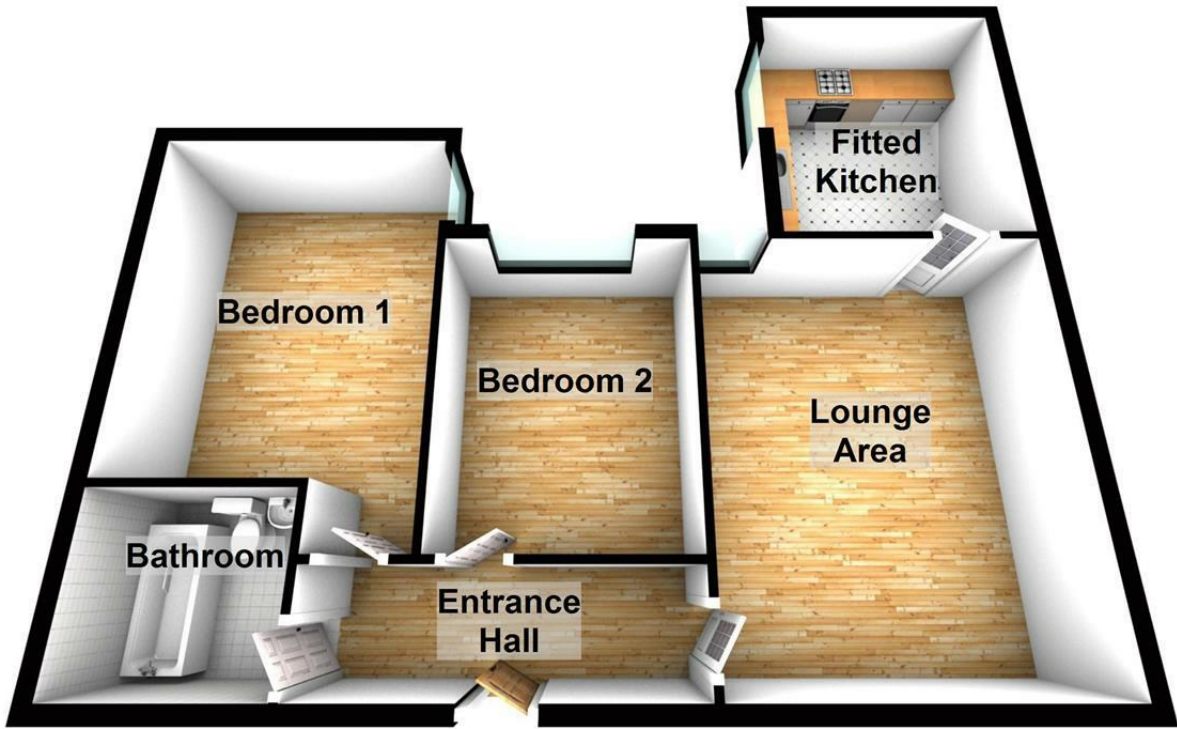

Floor Shapes and Sizes are not exact and merely an indication of layout
Plan produced using PlanUp.

Energy Efficiency Rating		Current	Potential
Very energy efficient - lower running costs			
(92 plus) A			
(81-91) B			
(69-80) C			
(55-68) D			
(39-54) E			
(21-38) F			
(1-20) G			
Not energy efficient - higher running costs			
England & Wales		75	75
	EU Directive 2002/91/EC		

Environmental Impact (CO ₂) Rating		Current	Potential
Very environmentally friendly - lower CO ₂ emissions			
(92 plus) A			
(81-91) B			
(69-80) C			
(55-68) D			
(39-54) E			
(21-38) F			
(1-20) G			
Not environmentally friendly - higher CO ₂ emissions			
England & Wales			
	EU Directive 2002/91/EC		