



Shrewsbury Walk, Middlesex, TW7 7DE

Be the first to live in this stunning newly renovated two double bedroom flat, just moments walk from The River Thames in the heart of Old Isleworth. Situated on the first floor, offering a beautiful kitchen with additional storage space and room to dine, excellent living space, two double bedrooms and a newly fitted modern bathroom suite.

Shrewsbury Walk is situated just off South Street providing a great catchment area for local schools, and easy access into Richmond High Street and Hounslow High Street, both linked by the H37 bus route.

£1,400 PER MONTH

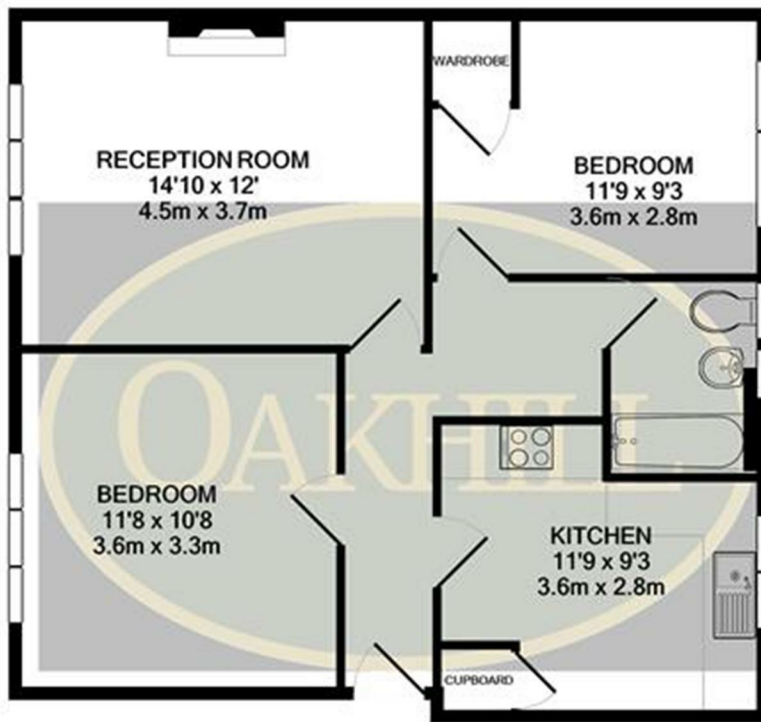

Whilst every attempt has been made to ensure the accuracy of the floor plan contained here, measurements of doors, windows, rooms and any other items are approximate and no responsibility is taken for any error, omission, or mis-statement. This plan is for illustrative purposes only and should be used as such by any prospective purchaser. The services, systems and appliances shown have not been tested and no guarantee as to their operability or efficiency can be given
Made with Metropix ©2021

Energy Efficiency Rating		
	Current	Potential
Very energy efficient - lower running costs		
(92 plus) A		
(81-91) B		
(69-80) C		
(55-68) D		
(39-54) E		
(21-38) F		
(1-20) G		
Not energy efficient - higher running costs		
England & Wales	EU Directive 2002/91/EC	

Environmental Impact (CO ₂) Rating		
	Current	Potential
Very environmentally friendly - lower CO ₂ emissions		
(92 plus) A		
(81-91) B		
(69-80) C		
(55-68) D		
(39-54) E		
(21-38) F		
(1-20) G		
Not environmentally friendly - higher CO ₂ emissions		
England & Wales	EU Directive 2002/91/EC	

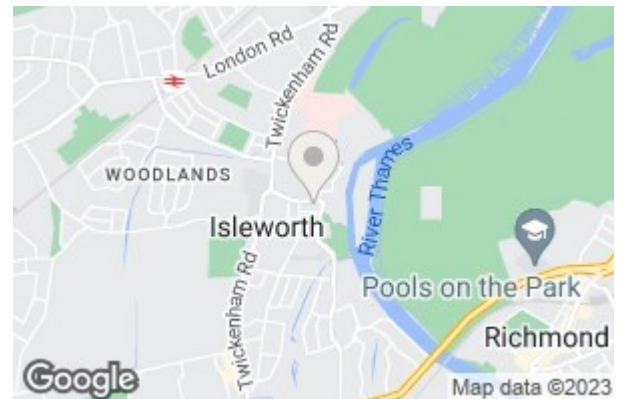

6 South Street, Isleworth, TW7 7BG
Tel: 0208 568 4433
info@oakhillagents.co.uk
www.oakhillagents.co.uk

OAKHILL