



Brickfield Road, SW4

£2,300 PCM

A luxury two double bedroom two bathroom apartment, on the top floor of a prestigious development, with a private balcony and a large open plan reception room and fitted kitchen.

- Two Double Bedrooms
- Two Bathrooms
- Balcony
- Communal Gardens
- Large Reception Room
- Modern Fitted Kitchen

For further information on the costs associated with renting a property, please pop into our office or visit our website.



Entered via a secure lobby with video entry phone and lift to the second floor the flat is entered and you are adjacent to the modern fitted kitchen with a range of units and integrated appliances. The large 20' + reception room has a glazed door onto the covered balcony. The bedrooms are well proportioned and both are generous doubles. One has its own private en-suite shower room while the other is served by a main bathroom.

Situated on the top floor of this sought after modern development in the heart of the Clapham Park, making its convenient for Clapham South underground station or alternatively Clapham Common and even Brixton.



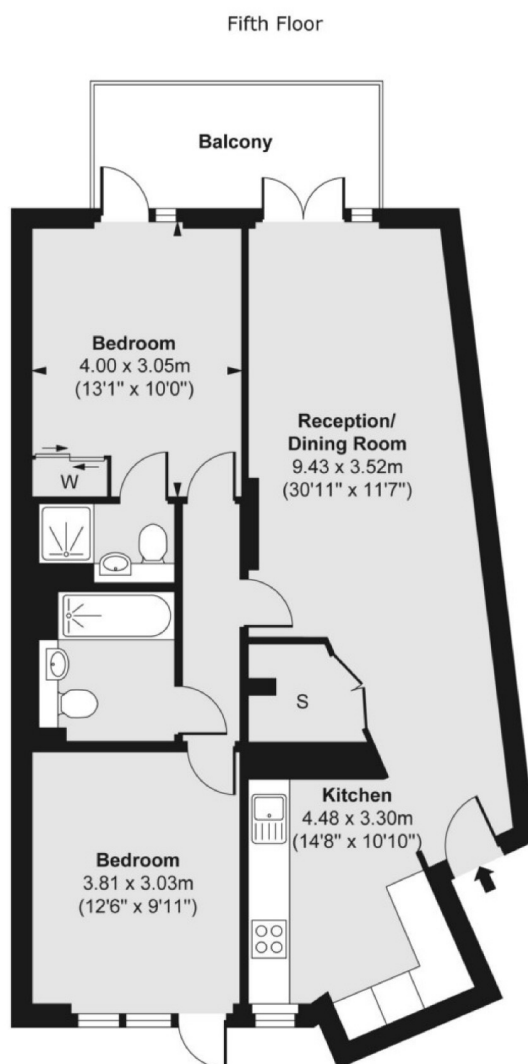

Total area (approx.) 72.93 sq. m (785 sq. ft)

Balcony area (approx.) 7.48 sq. m (81 sq. ft)

Jacksons Clapham
73 Abbeville Road
London
SW4 9JN
020 8875 7995
clapham.lettings@jacksonsestateagents.com

Energy Rating: We aim to make our particulars both accurate and reliable. However they are not guaranteed; nor do they form part of an offer or contract. If you require clarification on any points then please contact us, especially if you're traveling some distance to view. Please note that appliances and heating systems have not been tested and therefore no warranties can be given as to their good working order.