



Hubert Grove, SW9

£2,400 PCM

LONG LET. Spacious ground floor two bedroom flat with private garden located within close proximity to Clapham North tube station. Ideal for a small family or two professional sharers.

- Two Double Bedrooms
- Ground Floor
- Private Rear Garden
- Open Plan Kitchen
- Modern Bathroom
- Close To Clapham North Tube

For further information on the costs associated with renting a property, please pop into our office or visit our website.



The property has an entrance hall with useful storage cupboard, two almost equal sized double bedrooms, mainly tiled bathroom and separate W/C. To the rear of the property is an open plan kitchen/reception room that has space for a dining table and in-turn gives access to a good sized rear garden.

Hubert Grove is located within easy reach of both Clapham North and Brixton underground stations providing access to the Northern and Victoria Lines. Clapham High Street itself is also close by boasting an array of shops, bars and restaurants.



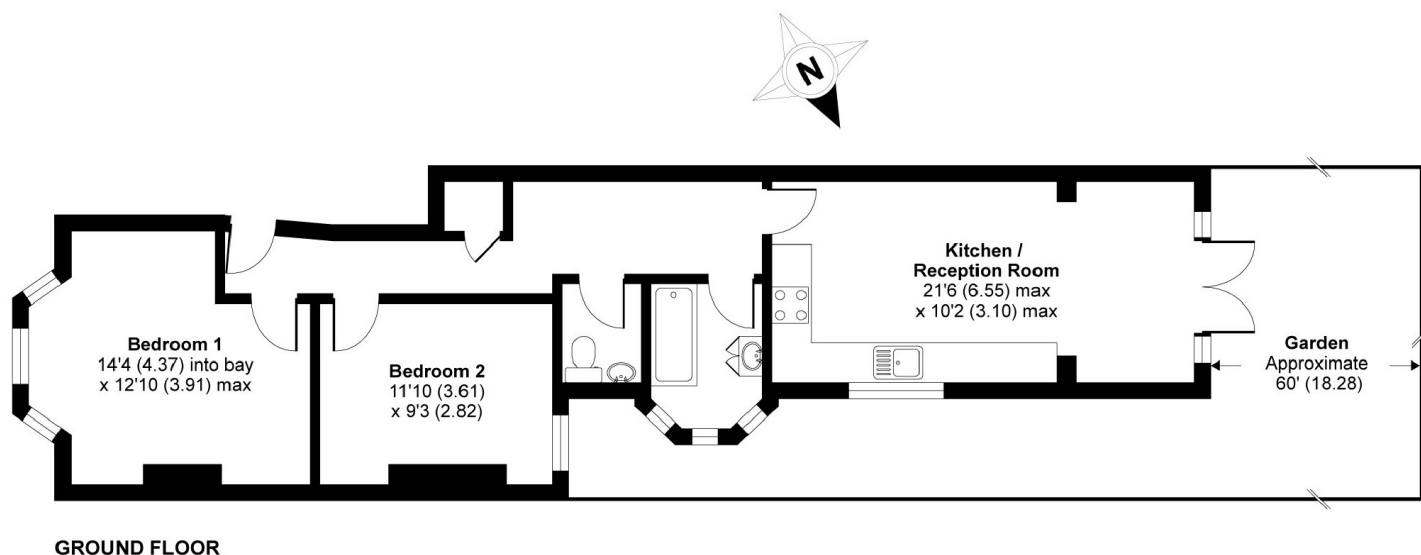

APPROX. GROSS INTERNAL FLOOR AREA 680 SQ FT 63.1 SQ METRES

Hubert Grove, London, SW9

Copyright nichecom.co.uk 2017 Produced for Jacksons the Independent Estate Agents REF : 171760

Jacksons Clapham
73 Abbeville Road
London
SW4 9JN
020 8875 7995
clapham.lettings@jacksonsestateagents.com

Energy Rating: C We aim to make our particulars both accurate and reliable. However they are not guaranteed; nor do they form part of an offer or contract. If you require clarification on any points then please contact us, especially if you're traveling some distance to view. Please note that appliances and heating systems have not been tested and therefore no warranties can be given as to their good working order.