



Tilson Gardens, SW2

£375,000

This spacious two bedroom flat is located in Sandon House, a well maintained purpose built development situated just off Brixton Hill.

- Two Bedrooms
- Leasehold
- Modern Kitchen
- Excellent Transport Links
- Excellent Finish Throughout
- Close Proximity To Brockwell Park



Sandon House is situated just off Atkins Road which runs parallel to Brixton Hill where there are many bus routes into Brixton and Central London. Brixton railway/tube stations along with Clapham South/ Clapham Common tube stations are all within close proximity from the property. Both Brixton Town centre and Clapham High Street offer plenty of shops, restaurants, bars and amenities.



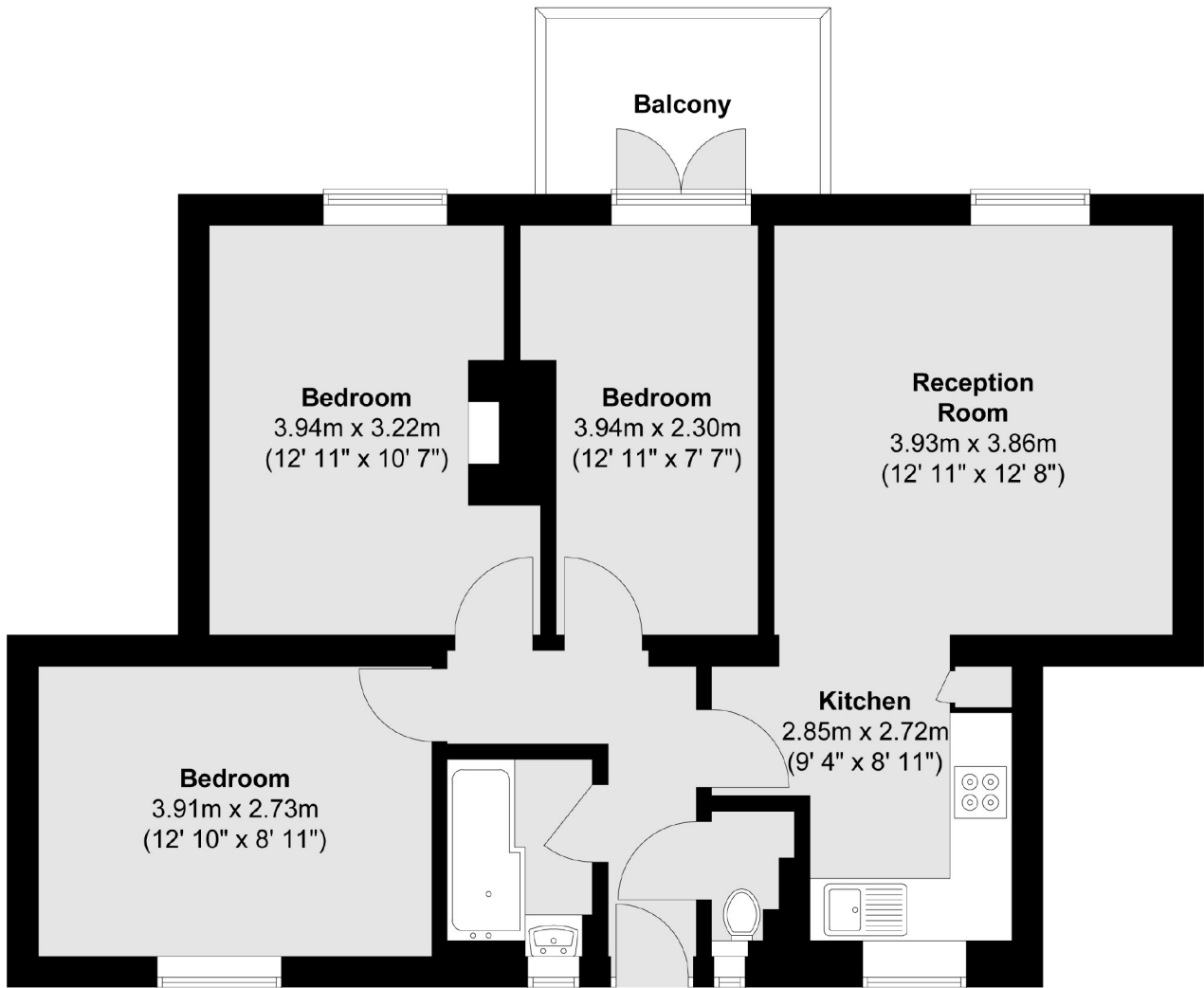

Second Floor

Total area (approx.) : 65.5 sq. m (705 sq. ft)
Total balcony area (approx.) : 4.5 sq. m (48 sq. ft)

Jacksons Clapham
73 Abbeville Road
London
SW4 9JN
020 8875 7995
clapham.sales@jacksonsstateagents.com

Energy Rating: We aim to make our particulars both accurate and reliable. However they are not guaranteed; nor do they form part of an offer or contract. If you require clarification on any points then please contact us, especially if you're traveling some distance to view. Please note that appliances and heating systems have not been tested and therefore no warranties can be given as to their good working order.