



Hutchings Street, E14

£475,000

 2  1  1  C

- OIEO £475,000
- Direct River Views
- South Facing Balcony
- Communal Courtyard
- Open Plan
- Concierge
- Gated Development
- Chain Free



This two-bedroom apartment offers a bright and comfortable living space with the added benefit of a private balcony. The open-plan living area has large windows that let in plenty of natural light, while the kitchen is fitted with modern appliances. Both bedrooms are well-sized and the bathroom is finished to a high standard.

Hutchings Street, is well-connected by public transport, making it easy to travel around the city. The nearest station is Canary Wharf served by the Jubilee Line and the Elizabeth Line. The DLR is also easily accessible from South Quay and Heron Quays stations, offering direct links to Bank, Stratford, and City Airport.



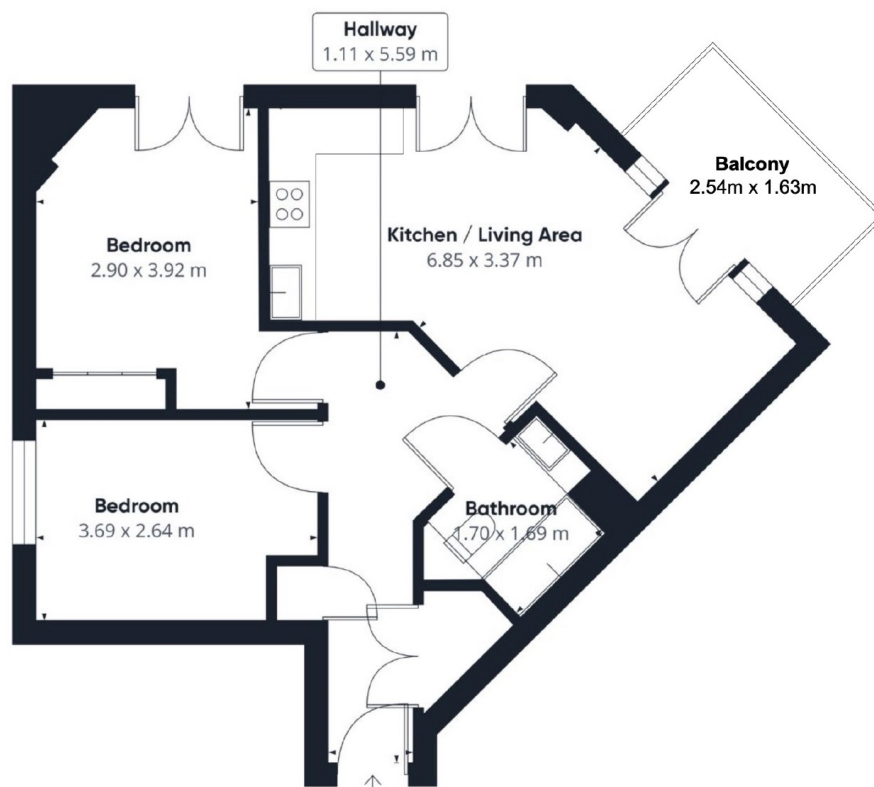

Approximate total area^(*)
58.10 m²

(*) Excluding balconies and terraces

While every attempt has been made to ensure accuracy, all measurements are approximate, not to scale. This floor plan is for illustrative purposes only.

GIRAFFE360

35A Wapping High Street,
London, E1W 1NR
020 7702 3456
ea2group.com



Energy Rating: C We aim to make our particulars both accurate and reliable. However they are not guaranteed; nor do they form part of an offer or contract. If you require clarification on any points then please contact us, especially if you're travelling some distance to view. Please note that appliances and heating systems have not been tested and therefore no warranties can be given as to their good working order.