



## St. Katharines Way, E1W

£553 Per week

 2  2  1  D

- Two Double Bedroom
- Additional Study
- St Katharine's Docks
- West Wapping
- Wood Flooring
- Separate Kitchen





A well-presented two double bedroom property located in this popular development next to St Katharine's Docks. This property offers an additional study room, separate kitchen and wooden flooring throughout.

Matilda House is ideally situated close to St Katharine's Docks with a wide selection of pubs, bars, restaurants and cafes nearby. Tower Hill stations, DLR links and Wapping Overground Station are also nearby for easy access to the City, London Bridge and Canary Wharf.



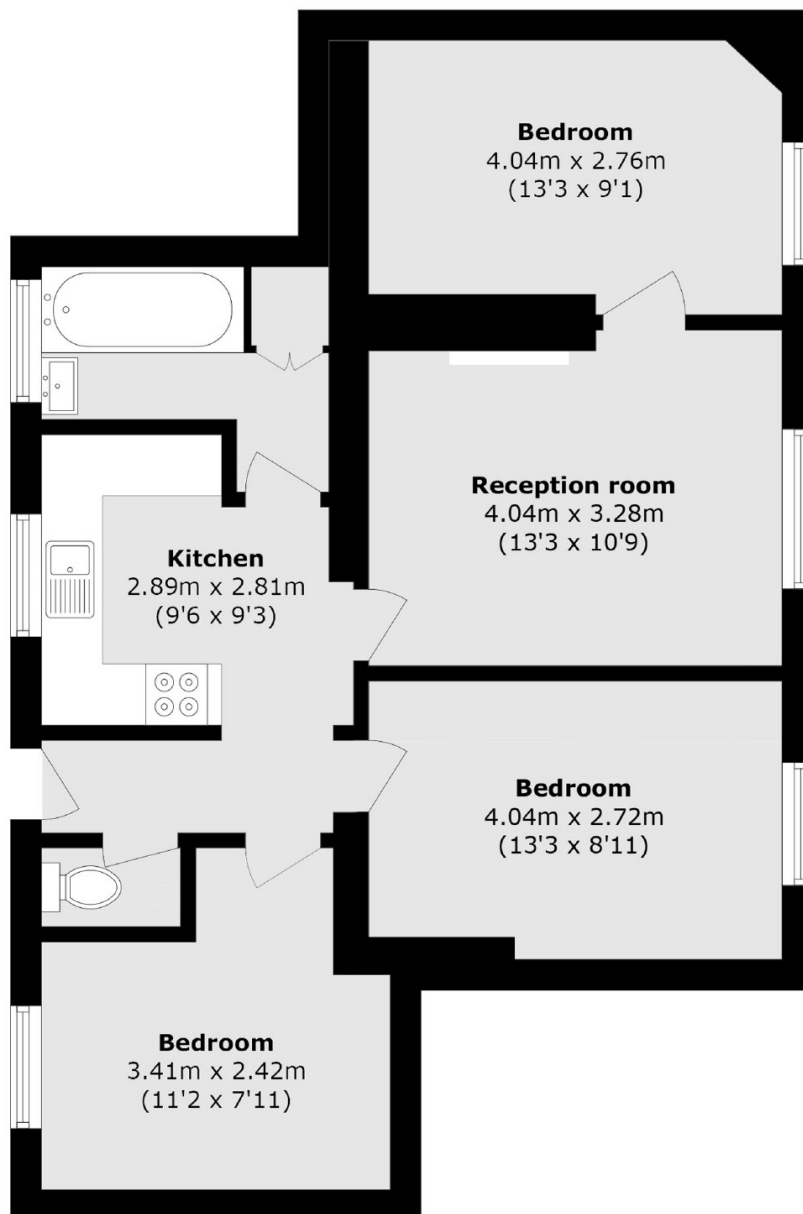

Total area (approx.): 66.4 sq. m (714.4 sq. ft)

35A Wapping High Street,  
London, E1W 1NR  
020 7702 3456  
ea2group.com