



Northolt Avenue, Ruislip, HA4 6SS
£700,000

4 2 1 D



Northolt Avenue, Ruislip, HA4 6SS

£700,000

- Four Bedroom Semi Detached
- Short Walk to South Ruislip Station
- Two Bathrooms
- Private Rear Garden
- Nearby to Highly Regarded Schools
- Garage Via Own Driveway
- Excellent Condition Throughout
- Driveway Providing Off Street Parking
- Short Drive to A40/M40/M25/M4
- No Upper Chain

Description

This well presented spacious property on offer comprises of three downstairs bedrooms, two bathrooms, a spacious inviting reception room, modern fitted kitchen which flows effortlessly into a dedicated dining room providing easy access to the rear.

Rising to the first floor boasts a bright and airy double bedroom with ample of storage space.

Externally the property features a front drive with access to the garage ensuring both convenience and practicality. To the rear enjoys a private garden mainly laid to lawn.

Situation

Northolt Avenue, a quiet residential road in the heart of Ruislip. South Ruislip station with the Central Line is just a short drive away giving serval links into Central London and the surrounding areas. For the commuters the A40/M40 is just moments away, making travel across London and beyond a breeze. The area is also served by a number of highly regarded schools including Sacred Heart Catholic school and Ruislip High School. South Ruislip retail park offers a variety of stores and supermarkets, providing immediate access to everyday essentials and home convenience.



Floor Plans

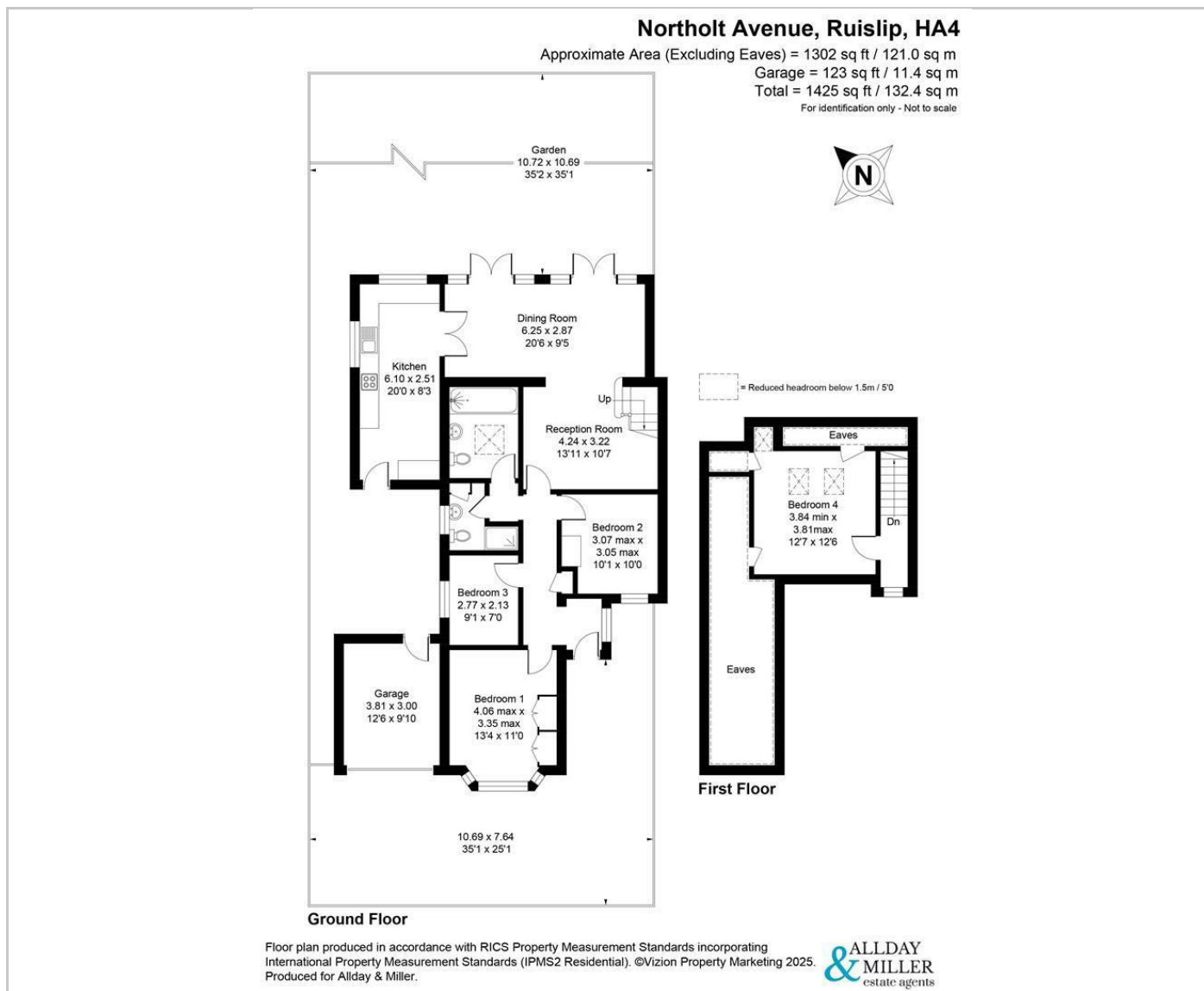

Area Map

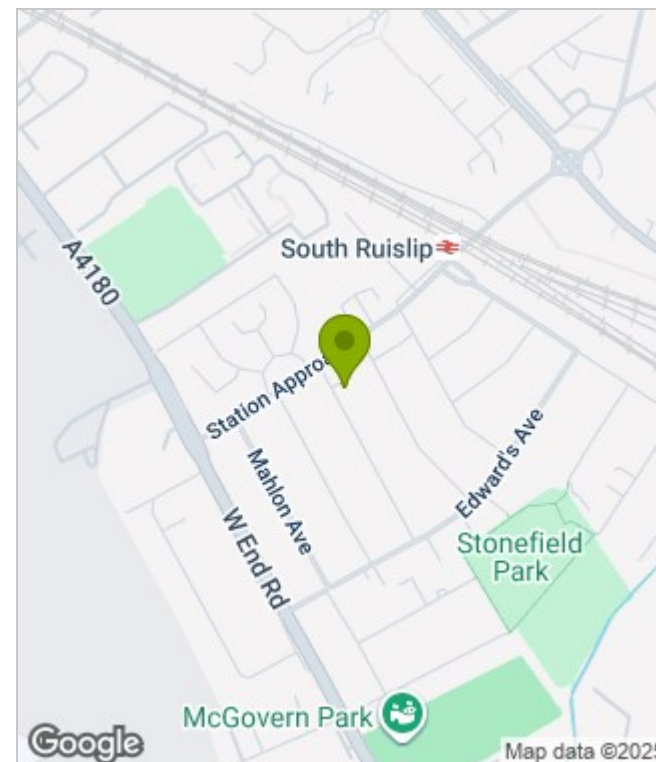

Energy Performance Graph

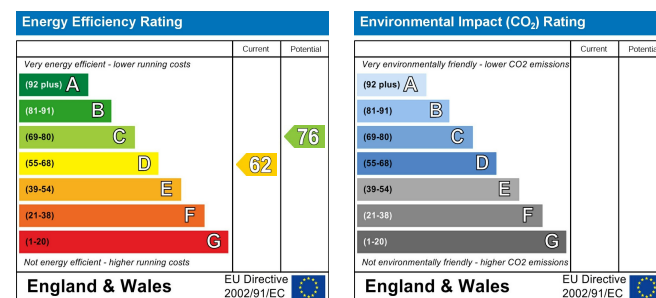

These particulars, whilst believed to be accurate are set out as a general outline only for guidance and do not constitute any part of an offer or contract. Intending purchasers should not rely on them as statements of representation of fact, but must satisfy themselves by inspection or otherwise as to their accuracy. No person in this firm's employment has the authority to make or give any representation or warranty in respect of the property.