

ALLDAY  
& MILLER

Aylsham Drive, Uxbridge, UB10 8UH  
£950 Per Month







Aylsham Drive, Uxbridge, UB10 8UH

**£950 Per Month**

- Studio Apartment
- Off Street Parking
- Pull Down Bed
- Short Walk to West Ruislip and Ickenham Station.
- First Floor
- Newly Decorated and Carpeted
- Large Separate Kitchen
- Available Immediately



## Description

As you enter the apartment, you will be greeted by a spacious studio room that seamlessly combines functionality with style. The cleverly designed pull-down bed allows for versatile use of the space. The large fitted kitchen is a standout feature, equipped with modern appliances. The apartment is located in a quiet development and short walk from West Ruislip and Ickenham stations.

## Situation

Aylsham Drive within close proximity to Ickenham High Street and its selection of shops, trendy cafes, takeaways and restaurants. Ickenham station (Metropolitan/Piccadilly) provides a reliable service into the city whilst West Ruislip Station, half a mile away is serviced by both tube and train lines into Marylebone Station in just 25 minutes, with regular trains every 15 minutes. For the motorist, there are excellent connections to central London via the M25 and the M40 making it a popular choice for professionals.



Floor Plans

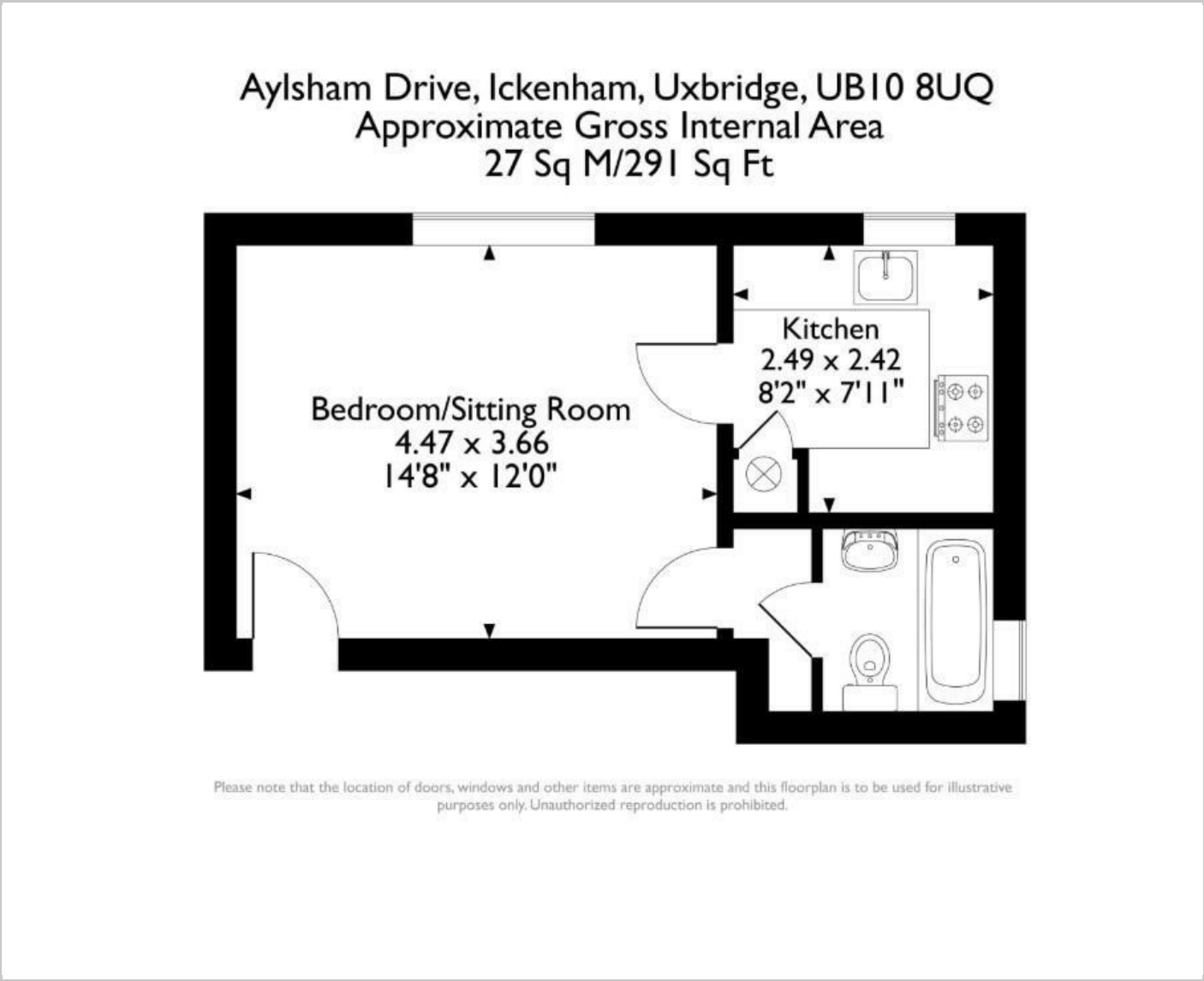

Area Map

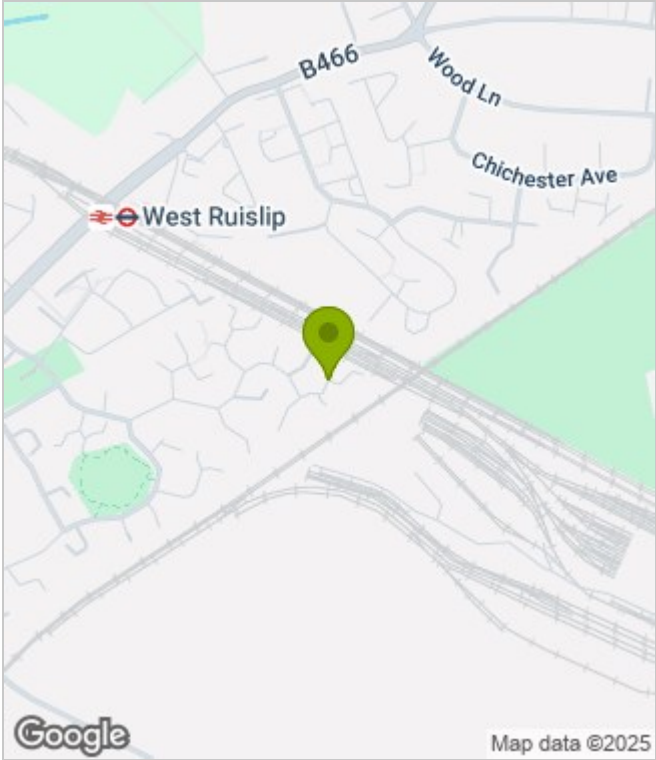

Energy Performance Graph

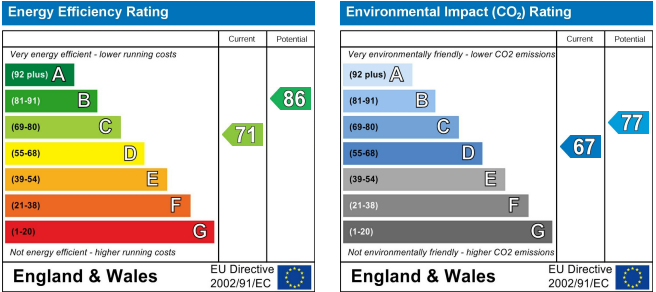

These particulars, whilst believed to be accurate are set out as a general outline only for guidance and do not constitute any part of an offer or contract. Intending purchasers should not rely on them as statements of representation of fact, but must satisfy themselves by inspection or otherwise as to their accuracy. No person in this firms employment has the authority to make or give any representation or warranty in respect of the property.