

ALLDAY  
& MILLER



Cageswood Drive, Farnham Common, SL2 3JZ  
£1,300,000

5 3 2 D





Cageswood Drive, Farnham Common, SL2 3JZ

**£1,300,000**

- Five Bedroom Detached
- Three Bathrooms with Two Ensuite
- Quiet Location with Burnham Beeches
- Planning Permission Granted to Extend
- Dedicated Study
- Garage via Own Driveway
- 3417 Sq Ft / 317.5 Sq M
- Ground Floor W.C
- Close to Highly Regarded Schools
- No Upper Chain

## Description

This stunning house offers a perfect blend of comfort and elegance. Upon entering, you are greeted by a welcoming grand entrance hall that leads to a spacious family room, the fitted kitchen is well equipped, while the utility room adds convenience, a further reception room, additional W.C and dedicated study completes this floor.

The first floor boasts five generously sized bedrooms, ensuring ample space for family and guests. Two of these bedrooms feature their own ensuite bathrooms, providing a touch of luxury and privacy, while a well appointed family bathroom serves the remaining bedrooms.

Outside, the property is complemented by a large driveway that offers ample parking, along with a garage. The rear garden is a true highlight, featuring a private space mainly laid to lawn, perfect for outdoor activities.

## Situation

The property is ideally located within quick and easy access to the beautiful Burnham Beeches and its 500 acres of woodland, and within easy reach of the local Infant and Junior Schools, Sainsbury's, Costa, Tesco plus a variety of local shops, amenities, pubs and places to eat. Farnham Common is considered a highly desirable commuter town, due to it being within a 20-minute journey into Heathrow, nearby to the Cross Rail, with further links to Bond Street, Liverpool Street and Canary Wharf, all without a change and with many stations in between. Gerrards Cross and Beaconsfield are also close by, providing a train line direct to London Marylebone in 20 minutes via Chiltern Railways. The town is well supported for families, with several Bucks/Berkshire grammar schools. In addition, there are a range of private schools in the vicinity such as St Mary's, Thorpe House, Dair House, as well as Caldicott which is within walking distance from the property. Larger shopping centres can be found in Windsor, High Wycombe (Eden centre) and Uxbridge (The Chimes). Nearby towns also include Marlow and Cookham which run alongside the River Thames and Beaconsfield. The property is close to local amenities such as Farnham Common Sports Club, which offers tennis, cricket, hockey & rugby and Bull Lane Tennis Club. Families are well catered for by Legoland Windsor Resort, Burnham Beeches, a National Nature Reserve and Special Area of Conservation, Windsor Great Park, Black Park and Cliveden House.

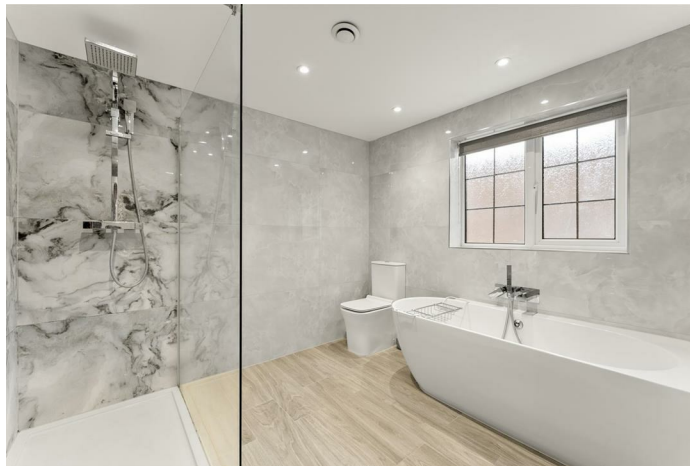



Floor Plans

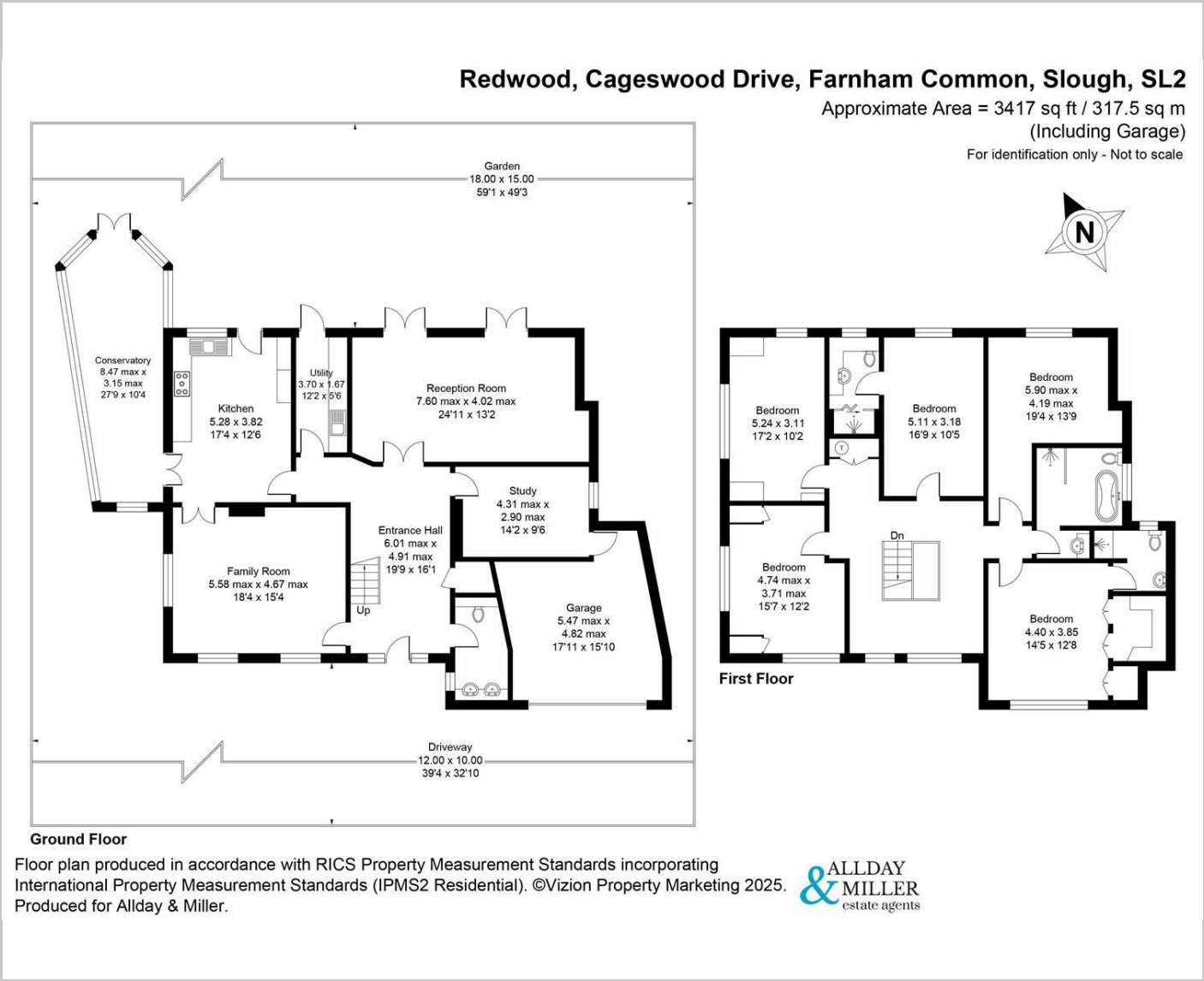

Area Map

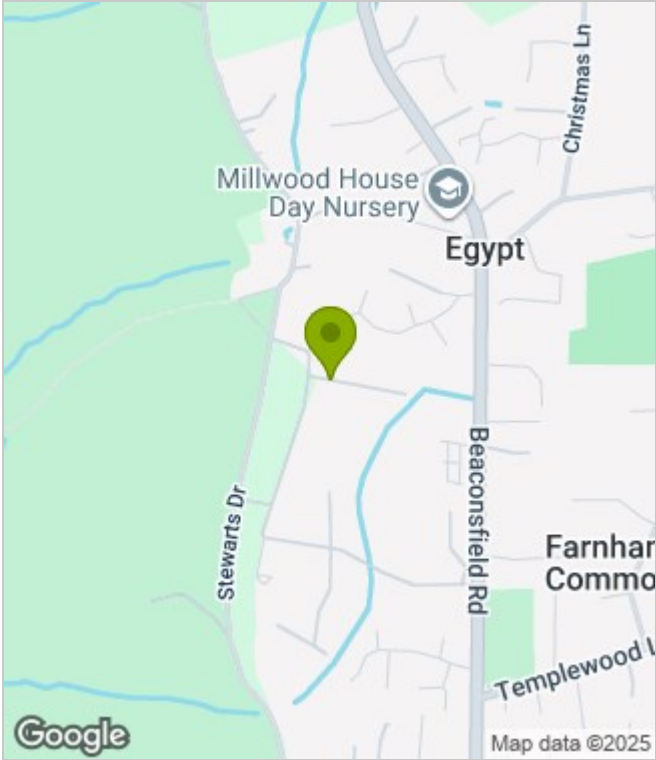

Energy Performance Graph

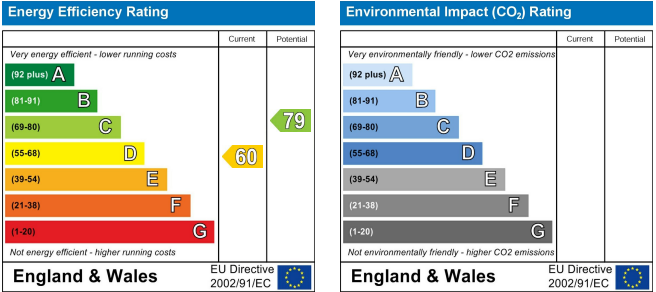

These particulars, whilst believed to be accurate are set out as a general outline only for guidance and do not constitute any part of an offer or contract. Intending purchasers should not rely on them as statements of representation of fact, but must satisfy themselves by inspection or otherwise as to their accuracy. No person in this firms employment has the authority to make or give any representation or warranty in respect of the property.

[www.alldayandmiller.co.uk](http://www.alldayandmiller.co.uk)

192 High Street, Uxbridge, Middlesex, UB8 1LB

T: 01895 641 000 | E: [sales@alldayandmiller.co.uk](mailto:sales@alldayandmiller.co.uk)

T: 01895 379 549 | E: [lettings@alldayandmiller.co.uk](mailto:lettings@alldayandmiller.co.uk)