

ALLDAY
& MILLER

North Hyde Road, Hayes, UB3 4NJ
£615,000

4 2 1 D



North Hyde Road, Hayes, UB3 4NJ

£615,000

- Four Bedrooms
- Side Extension
- Driveway
- Recently Refurbished
- Potential To Extend Further STPP
- Two Bathrooms
- Corner Plot House
- Chain Free Sale
- Good Schools Nearby
- Walking Distance To An Elizabeth Line Station

Description

This charming house offers a delightful blend of comfort and practicality, making it an ideal family home. The ground floor comprises of a spacious reception room, family room, dining room, the sleek fitted kitchen is designed for modern living, a double bedroom and bathroom completes this floor.

Rising to the first floor, you will find three additional bedrooms, each offering ample space and natural light, along with a bathroom.

The property boasts a gated front drive, providing secure off-street parking, while the rear garden offers a private outdoor retreat, ideal for outdoor entertainment.

Situation

North Hyde Road situated in the heart of Hayes close to a number of local amenities including Hayes & Harlington station with the popular Elizabeth line, making the journey to Central London a breeze. Transport links are also on hand for Southall, Heathrow, Hounslow, Uxbridge town centre and the M4/M25 motorways. Walking distance to highly regarded schools in the local area including Rosedale School and Woodend Academy. Hayes Town centre just moments away with its variety of local shops, restaurants, cafes, takeaways and coffee shops.



Floor Plans

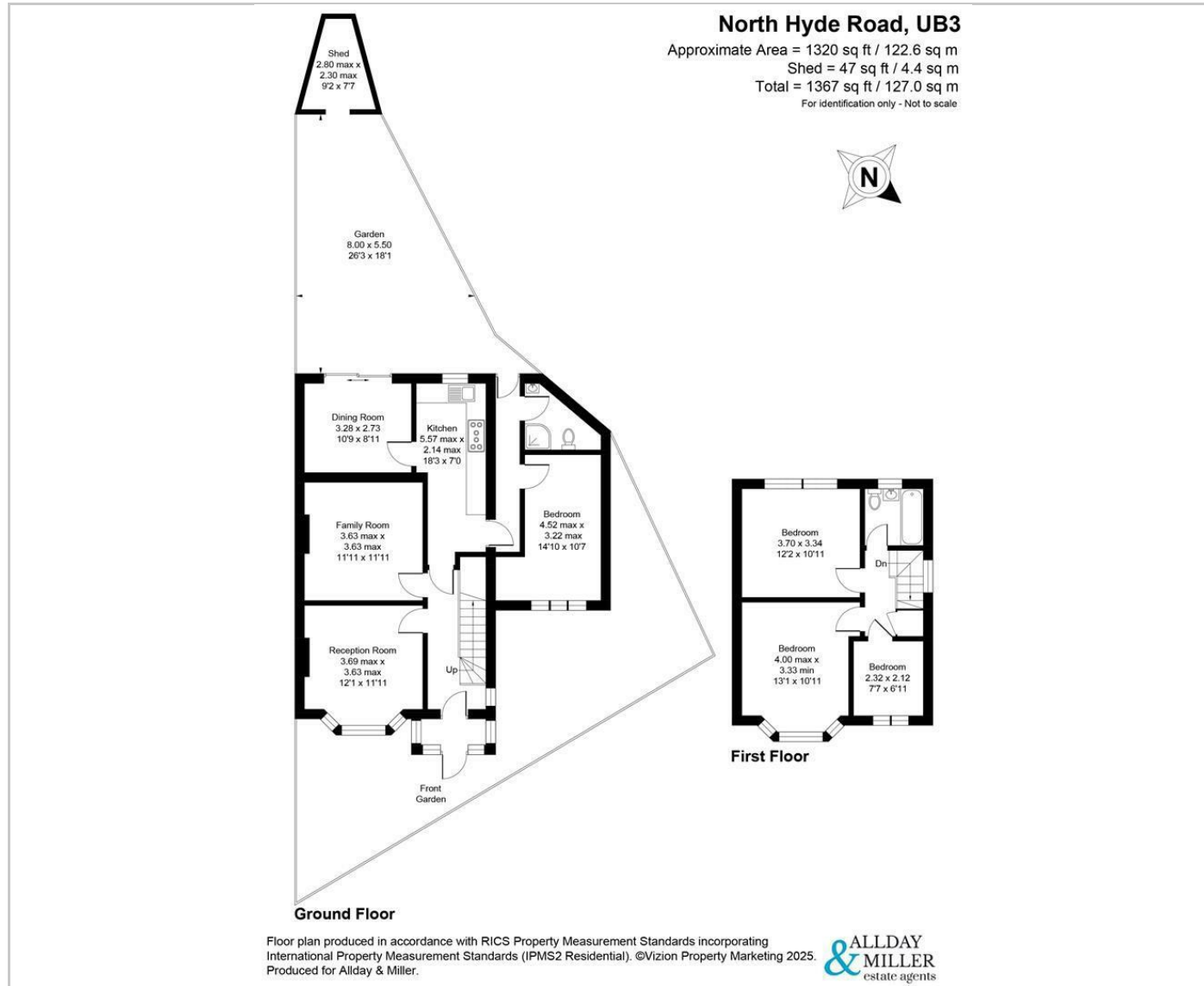

Area Map

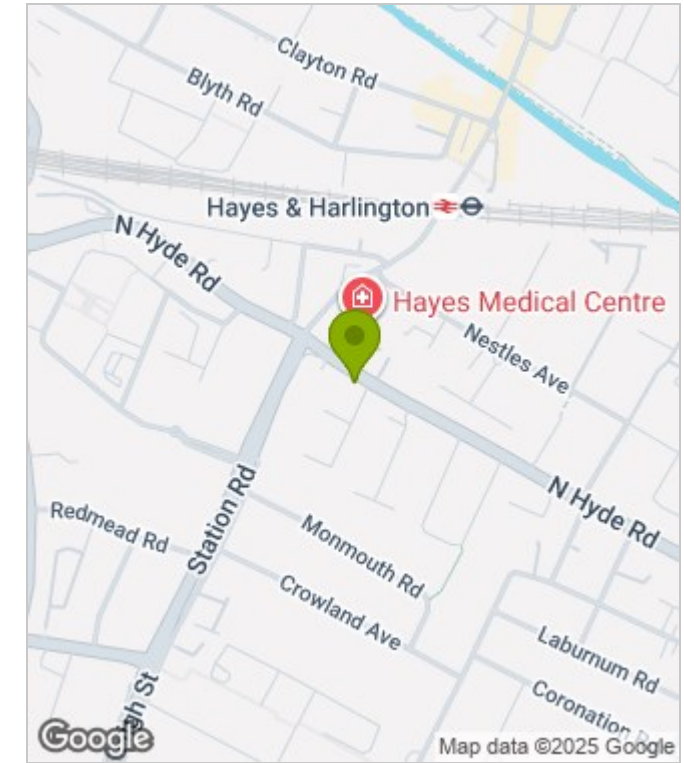

Energy Performance Graph

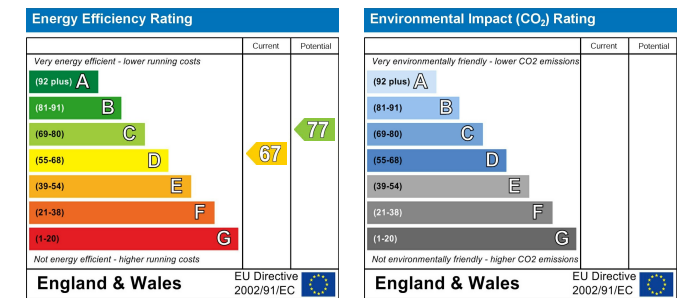

These particulars, whilst believed to be accurate are set out as a general outline only for guidance and do not constitute any part of an offer or contract. Intending purchasers should not rely on them as statements of representation of fact, but must satisfy themselves by inspection or otherwise as to their accuracy. No person in this firm's employment has the authority to make or give any representation or warranty in respect of the property.