

Frank Harris & Co.



Rashleigh House, WC1H

£576 Per week

Located in the heart of Bloomsbury this modern flat comprises of a one double bedroom, bright living area, separate kitchen and bathroom.



This property offers easy access to the University of London, SOAS, Birkbeck, and LSE. Within walking distance of Russell Square and King's Cross Underground station.

- One Bedroom • Period Mansion Block • Furnished •
- Separate Kitchen • Modern Finish •



Frank Harris & Co.

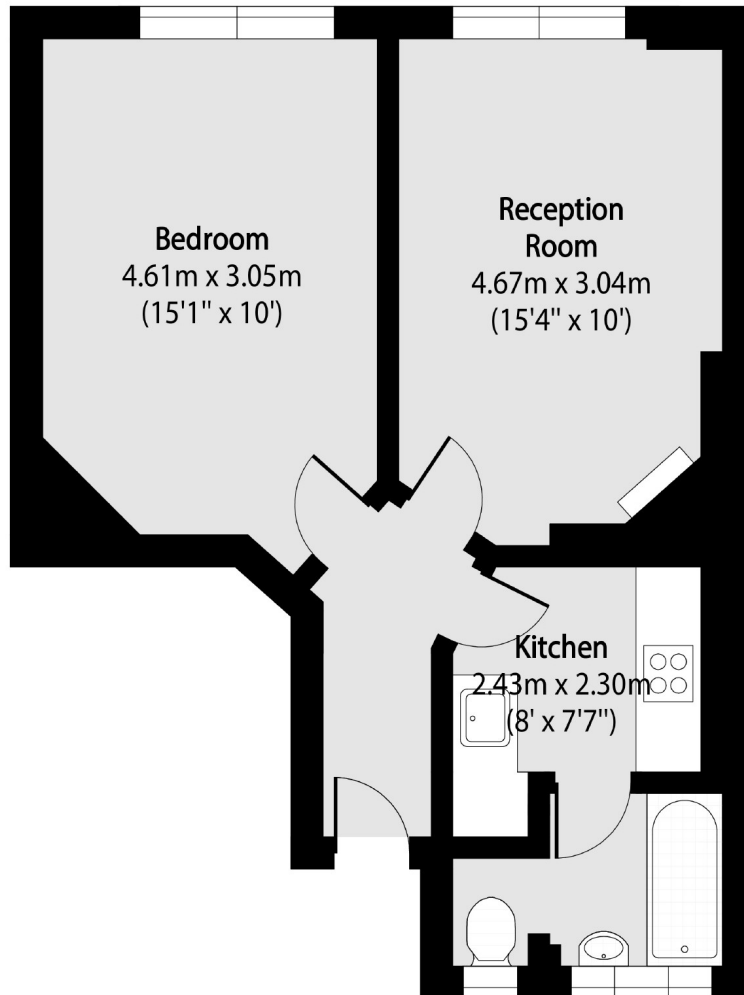

Total area (approx): 42.08sq m (453 sq. ft)

Frank Harris & Co. Bloomsbury and Kings Cross
81 Marchmont Street, London,
WC1N 1AL
020 7387 0077
bloomsburylettings@frankharris.co.uk

Energy Rating: E. We aim to make our particulars both accurate and reliable. However they are not guaranteed; nor do they form part of an offer or contract. If you require clarification on any points then please contact us, especially if you're traveling some distance to view. Please note that appliances and heating systems have not been tested and therefore no warranties can be given as to their good working order.

