



Willowmead, Hertford, SG14 2AT

Welcome to

Willowmead, Hertford

This stunning three-bedroom family home has been recently decorated throughout to an exceptional standard, offering bright, spacious, and modern living. Tucked away in a quiet cul-de-sac, the property is ideally located within walking distance of Hertford town centre and Hertford North train station



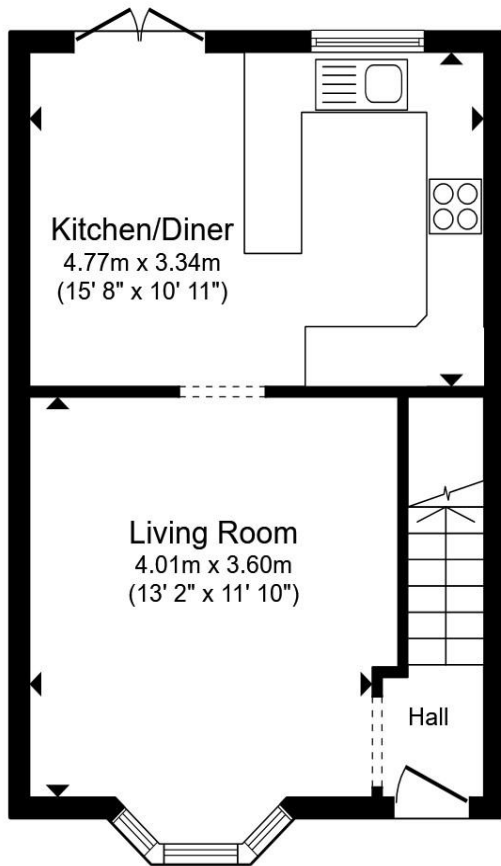

Ground Floor

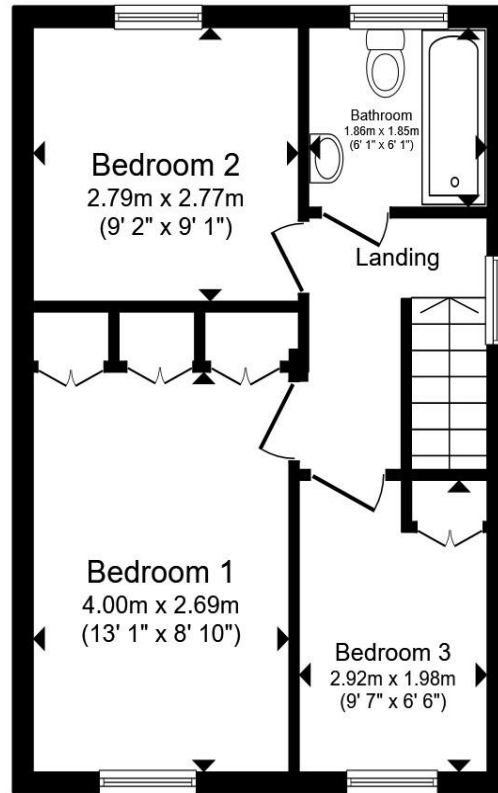

First Floor

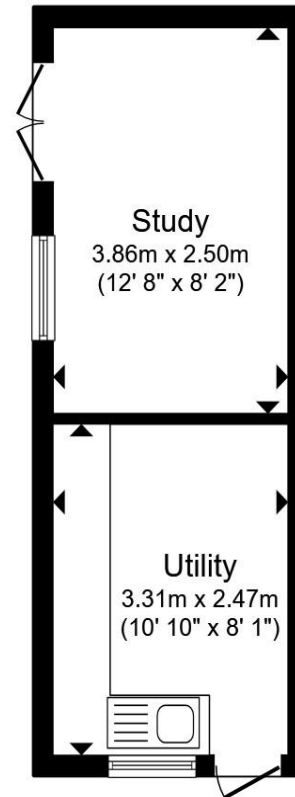

Outbuilding

Total floor area 89.5 m² (964 sq.ft.) approx

This floor plan is for illustrative purposes only. It is not drawn to scale. Any measurements, floor areas (including any total floor area), openings and orientation are approximate. No details are guaranteed, they cannot be relied upon for any purpose and they do not form part of any agreement. No liability is taken for any error, omission or misstatement. A party must rely upon its own inspection(s). Powered by www.propertybox.io



-Accommodation Overview-

Entrance Hall

Living Room

13' 2" max x 11' 10" max (4.01m max x 3.61m max)

Kitchen / Diner

15' 8" x 10' 11" (4.78m x 3.33m)

-First Floor Landing-

Bedroom One

13' 1" excluding wardrobes x 8' 10" (3.99m excluding wardrobes x 2.69m)

Bedroom Two

9' 2" max x 9' 1" max (2.79m max x 2.77m max)

Bedroom Three

9' 7" x 6' 6" (2.92m x 1.98m)

Bathroom

-Exterior-

-Outbuilding-

Study:

12' 8" x 8' 2" (3.86m x 2.49m)

Utility Room:

10' 10" x 8' 1" (3.30m x 2.46m)

Garden

Welcome to

Willowmead, Hertford

- THREE BEDROOM FAMILY HOME
- OFF STREET PARKING FOR SEVERAL CARS
- LANDSCAPED REAR GARDEN
- OUTBUILDING CONVERTED INTO STUDY & UTILITY ROOM
- QUIET CUL-DE-SAC LOCATION

Tenure: Freehold
EPC Rating: C
Council Tax Band: D

Guide price

£525,000



Please note the marker reflects the postcode not the actual property

view this property online williamhbrown.co.uk/Property/HFD108248



Property Ref:
HFD108248 - 0002

1. MONEY LAUNDERING REGULATIONS Intending purchasers will be asked to produce identification documentation at a later stage and we would ask for your co-operation in order that there is no delay in agreeing the sale. 2. These particulars do not constitute part or all of an offer or contract. 3. The measurements indicated are supplied for guidance only and as such must be considered incorrect. Potential buyers are advised to recheck measurements before committing to any expense. 4. We have not tested any apparatus, equipment, fixtures or services and it is in the buyers interest to check the working condition of any appliances. 5. Where an EPC, or a Home Report (Scotland only) is held for this property, it is available for inspection at the branch by appointment. If you require a printed version of a Home Report, you will need to pay a reasonable production charge reflecting printing and other costs. 6. We are not able to offer an opinion either written or verbal on the content of these reports and this must be obtained from your legal representative. 7. Whilst we take care in preparing these reports, a buyer should ensure that his/her legal representative confirms as soon as possible all matters relating to title including the extent and boundaries of the property and other important matters before exchange of contracts.

William H Brown is a trading name of Sequence (UK) Limited which is registered in England and Wales under company number 4268443, Registered Office is Cumbria House, 16-20 Hockliffe Street, Leighton Buzzard, Bedfordshire, LU7 1GN. VAT Registration Number is 500 2481 05.



william h brown



01992 586501



Hertford@williamhbrown.co.uk



21 Castle Street, HERTFORD, Hertfordshire,
SG14 1ER



williamhbrown.co.uk