



Hasted Drive, Alresford

At home in Hampshire

Hellards

33 Hasted Drive

ALRESFORD SO24 9PX

Guide Price £450,000

- Well-Presented Three Bedroom Home
- Larger than Average West Facing Rear Garden
- Recently Refitted Kitchen/Breakfast Room
- Large and Sunny Sitting/Dining Room
- Downstairs Cloakroom
- Quiet Cul-de-Sac Location
- Easy Access to Town Centre & Shops
- Council Tax Band C

Set in this popular and quiet cul-de-sac within easy reach of the town centre, a very well-presented three bedroom home with a lovely West-facing garden. The entrance hall leads to the recently refitted kitchen/breakfast room which benefits from a range of built-in appliances as well as larder cupboard and plenty of storage. The bay window is an ideal spot for a kitchen table. To the rear of the house, the sitting room is large and bright with plenty of space for sofas and a dining table as well as an understairs storage cupboard. There is also a cloakroom on this level.

Upstairs, the main bedroom has views over the garden as well as fitted storage. There is a further double bedroom and a single bedroom as well as a recently refitted family bathroom with shower over the bath.

The rear garden is a particular delight, with a large patio area for catching the afternoon sun as well as a summerhouse. The garden is laid to lawn with mature shrubs and colourful flowerbeds. A gate to the rear of the garden gives access to a footpath at the back for the terrace of properties.

To the front, the property is set back with a pretty front garden and screened from the road with a green area and mature trees. There is a garage in a separate block.





Alresford is a beautiful Georgian town known for its variety of independent shops, restaurants and inns located in stunning surroundings on the edge of the South Downs National Park. Attractions include the Watercress steam railway, schools for infant, junior and secondary education, several churches and an active and inclusive community. The cathedral city of Winchester is about 7 miles away and there is easy access to the south coast, the midlands and London via the road network. There is also mainline rail access to London from both Winchester and Alton. Southampton airport is only about half an hour away by car.

SERVICES

Mains gas with gas fired central heating.
Mains water, electricity and drainage.

LOCAL AUTHORITY

Winchester City Council
Council Tax Band C

DIRECTIONS

From our office in Broad Street proceed down West Street and at the junction at the bottom of the hill turn left into Jacklyns Lane. Go under the railway bridge, up the hill and down the other side and take the first turn on the left into Linnets Road. Hasted Drive is the second road on the right. The house is the second one on the right hand side.

What3words: [///licks.magazine.octopus](https://www.what3words.com/licks-magazine-octopus)



Approx Gross Internal Area
77 sq m / 830 sq ft

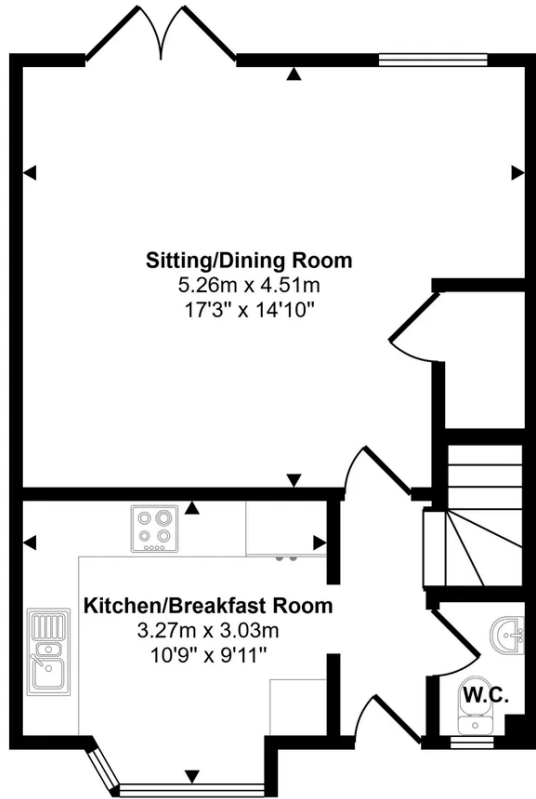

Ground Floor
Approx 39 sq m / 419 sq ft

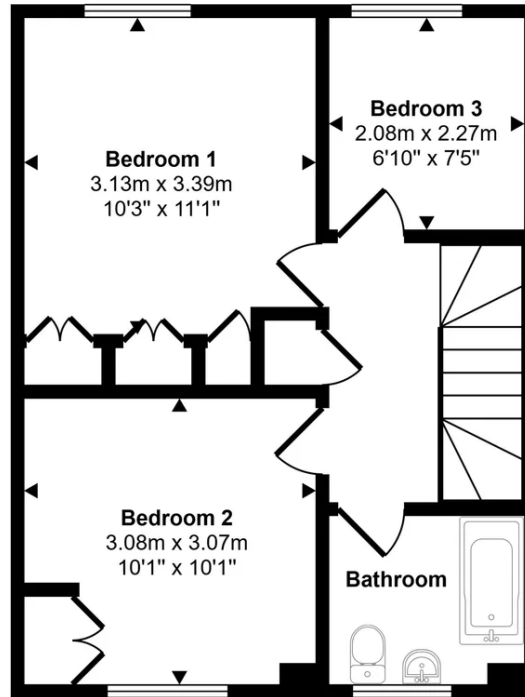

First Floor
Approx 38 sq m / 411 sq ft

This floorplan is only for illustrative purposes and is not to scale. Measurements of rooms, doors, windows, and any items are approximate and no responsibility is taken for any error, omission or mis-statement. Icons of items such as bathroom suites are representations only and may not look like the real items. Made with Made Snappy 360.

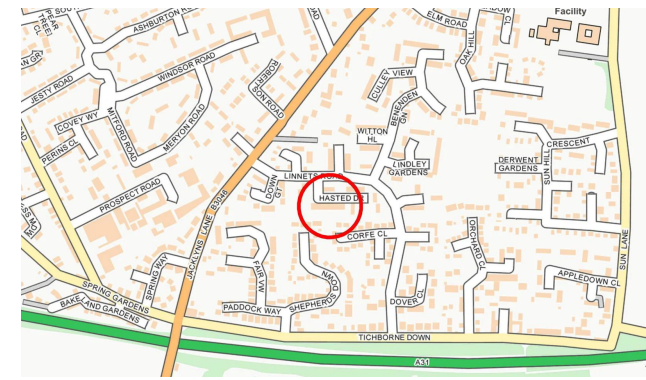

Energy Efficiency Rating		
	Current	Potential
Very energy efficient - lower running costs		
(92 plus) A		
(81-91) B		84
(69-80) C	72	
(55-68) D		
(39-54) E		
(21-38) F		
(1-20) G		
Not energy efficient - higher running costs		
England & Wales	EU Directive 2002/91/EC	

Hellards Estate Agents
11 Broad Street, Alresford, Hampshire

01962 736333
sales@hellards.co.uk

<https://www.hellards.co.uk/>



IMPORTANT: we would like to inform prospective purchasers that these sales particulars have been prepared as a general guide only. A detailed survey has NOT been carried out, nor the services, appliances and fittings tested. Room sizes should not be relied upon for furnishing purposes and are approximate. If floor plans are included, they are for guidance only and illustration purposes only and may not be to scale. If there are any important matters likely to affect your decision to buy, please contact us before viewing the property.