



Wheatsheaf Court, Deeping St. Nicholas Spalding  
Offers in Excess of £200,000 **Freehold**

**Sharman  
Quinney**

# Key Features



- Sold with No Upper Chain
- Two Bedrooms
- Semi Detached House
- 14ft Lounge/Diner
- Well Appointed Kitchen

Internally the home offers a large lounge dining room, with patio doors leading into the rear garden, a well-appointed kitchen as well as a cloakroom, Upstairs are two bedrooms and a family bathroom.

Accommodation Includes

Entrance Hall

Downstairs Cloakroom

Kitchen  
3.17m x 2.41m (10'5" x 7'11").

Lounge  
L-shaped room. 4.46m max x 3.54m max (14'8" max x 11'7" max),



## First Floor Landing

### Bedroom 1

3.53m x 3.26m (11'7" x 10'8"),

### Bedroom 2

3.53m x 2.16m (11'7" x 7'1").

## Bathroom

### Outside

Mainly laid to lawn. Block paved driveway to the side leading to detached single garage. Rear garden enclosed by wooden timber panelled fencing, mainly laid to lawn, patio area.



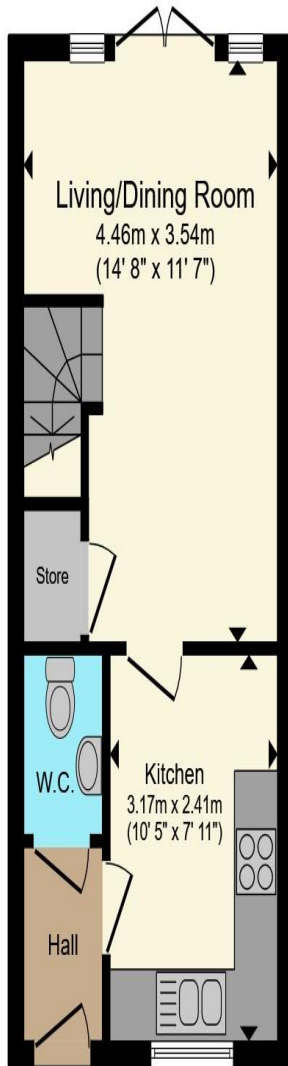

**Ground Floor**

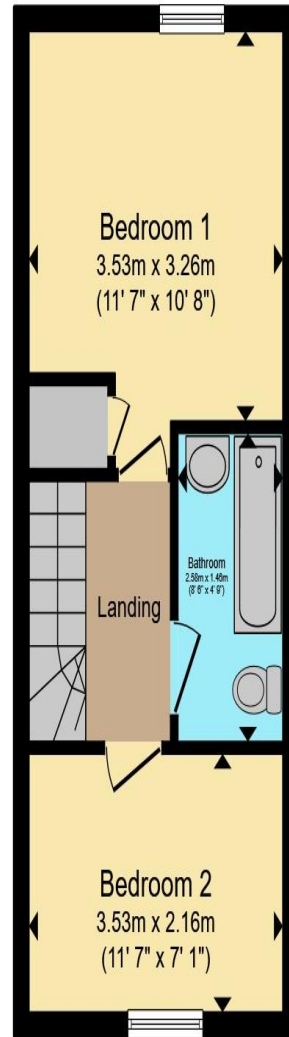

**First Floor**

Total floor area 57.9 m<sup>2</sup> (623 sq.ft.) approx

This floor plan is for illustrative purposes only. It is not drawn to scale. Any measurements, floor areas (including any total floor area), openings and orientation are approximate. No details are guaranteed, they cannot be relied upon for any purpose and they do not form part of any agreement. No liability is taken for any error, omission or misstatement. A party must rely upon its own inspection(s). Powered by [www.propertybox.io](http://www.propertybox.io)

**Sharman  
Quinney**

To view this property call Sharman Quinney on:  
**01778 343322**

# Selling your property?

Contact us to arrange a **FREE** home valuation.

 01778 343322

 25 Market Place, Market Deeping,  
PETERBOROUGH, Cambridgeshire, PE6 8EA

 marketdeeping@sharmanquinney.co.uk

 [www.sharmanquinney.co.uk](http://www.sharmanquinney.co.uk)



 SCAN ME



Sharman Quinney Holdings Limited is registered in England and Wales under company number 4174227, Registered Office is Cumbria House, 16-20 Hockliffe Street, Leighton Buzzard, Bedfordshire, LU7 1GN. VAT Registration Number is 500 2481 05.

1: These particulars do not constitute part or all of an offer or contract. 2: The measurements indicated are supplied for guidance only and as such must be considered incorrect. 3: Potential buyers are advised to recheck the measurements before committing to any expense. 4: Sharman Quinney has not tested any apparatus, equipment, fixtures, fittings or services and it is the buyers interests to check the working condition of any appliances. 5: Sharman Quinney has not sought to verify the legal title of the property and buyers must obtain verification from their legal representative. 6: Intending purchasers will be asked to produce identification documentation at a later stage and we would ask your co-operation in order that there will be no delay in agreeing the sale. Ref: MRD204544 - 0003

