



Corbins Lane, HA2

£250,000

A well presented one bedroom first floor flat featuring an open plan living space with double doors opening onto communal gardens, a fitted kitchen, a generously sized double bedroom and a modern bathroom with shower cubicle.

Meadow Gate is well located for transport links with South Harrow Station only 0.5 miles away making it ideal for commuters. Additionally there are many supermarkets and local amenities close by.

- First Floor • One Double Bedroom • Open Plan •
- Communal Gardens • Allocated Parking • Great Location •

Approx Gross Internal Area
44 sq m / 470 sq ft

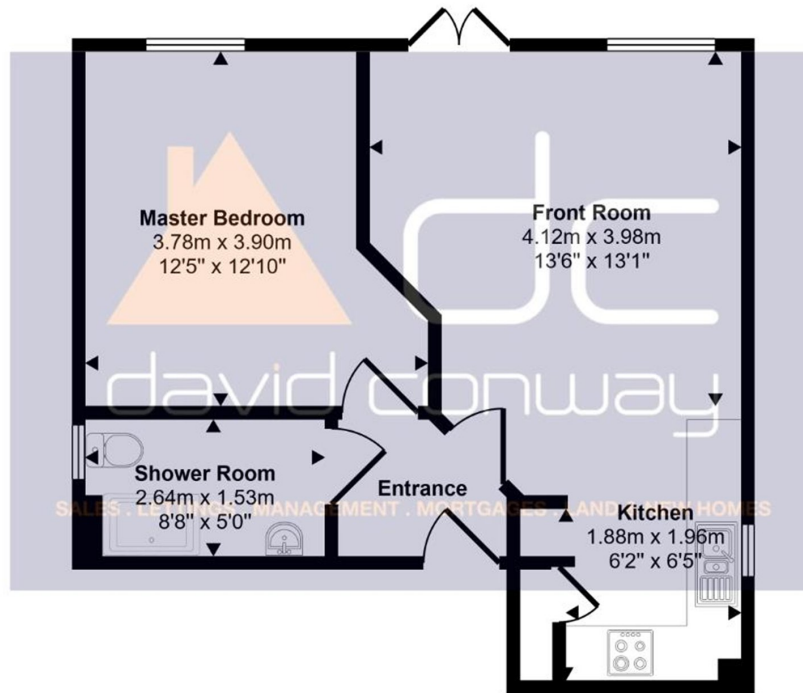

Floorplan

This floorplan is only for illustrative purposes and is not to scale. Measurements of rooms, doors, windows, and any items are approximate and no responsibility is taken for any error, omission or mis-statement. Icons of items such as bathroom suites are representations only and may not look like the real items. Made with Made Snappy 360.

David Conway
020 8422 5222

Energy Rating: C We aim to make our particulars both accurate and reliable. However they are not guaranteed; nor do they form part of an offer or contract. If you require clarification on any points then please contact us, especially if you're travelling some distance to view. Please note that appliances and heating systems have not been tested and therefore no warranties can be given as to their good working order.