



Cavan Way, Broughton, Milton Keynes, MK10 9LY

welcome to

Cavan Way, Broughton, Milton Keynes

Situated in the ever-popular residential area of Broughton, Milton Keynes, this well-presented two-bedroom maisonette on Cavan Way offers an ideal opportunity for first-time buyers, investors, or those seeking a stylish and low-maintenance home.

Entrance Porch

Stairs to the living area.

Lounge/Kitchen/Diner

Lounge/dining area: Storage cupboard, TV point, carpet and 3 radiators. Double-glazed windows to the front and rear.

Kitchen: Fitted with a mix of wall and base units with work top over, sink with mixer tap and drainer, integrated electric oven and a gas hob with extractor fan over. Space for a washing machine and a fridge/freezer. Double-glazed window to the side.

Inner Hallway

storage cupboard and radiator. Doors to the kitchen, both bedrooms and the bathroom.

Bedroom One

Built-in wardrobes with hanging space and storage, carpet, radiator and double-glazed window to the rear.

En-Suite

Partially tiled with a pedestal wash hand basin with mixer tap, low-level WC and a shower cubicle. Radiator and double-glazed obscured window to the rear.

Bedroom Two

Carpet, radiator and double-glazed window to the side.

Bathroom

Partially tiled with a pedestal wash hand basin with mixer tap, low-level WC and a bath with a shower screen and shower over. Radiator and double-glazed obscured window to the rear.

Outside

Garage & Parking

Garage with power and up & over door. Parking in front of the garage.

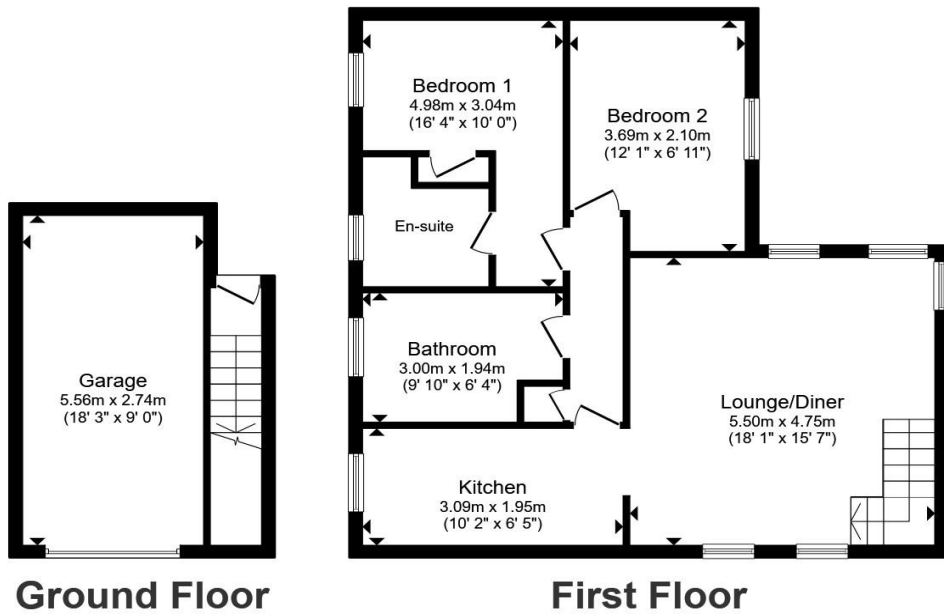

Total floor area 85.7 m² (922 sq.ft.) approx

This floor plan is for illustrative purposes only. It is not drawn to scale. Any measurements, floor areas (including any total floor area), openings and orientation are approximate. No details are guaranteed, they cannot be relied upon for any purpose and they do not form part of any agreement. No liability is taken for any error, omission or misstatement. A party must rely upon its own inspection(s). Powered by www.propertybox.io



welcome to
Cavan Way,
Broughton, Milton Keynes

- TWO-BEDROOM MAISONETTE
- PRIVATE ENTRANCE
- OPEN-PLAN LIVING/DINING
- CONTEMPORARY FAMILY BATHROOM
- ALLOCATED PARKING

Tenure: Leasehold EPC Rating: C
Council Tax Band: B Service Charge: 1120.00
Ground Rent: 800.00

This is a Leasehold property with details as follows; Term of Lease 150 years from 31 Mar 2005. Should you require further information please contact the branch. Please Note additional fees could be incurred for items such as Leasehold packs.

£250,000



view this property online [brownandmerry.co.uk/Property/NPL108202](https://www.brownandmerry.co.uk/Property/NPL108202)



Property Ref:
NPL108202 - 0003

1. MONEY LAUNDERING REGULATIONS Intending purchasers will be asked to produce identification documentation at a later stage and we would ask for your co-operation in order that there is no delay in agreeing the sale. 2. These particulars do not constitute part or all of an offer or contract. 3. The measurements indicated are supplied for guidance only and as such must be considered incorrect. Potential buyers are advised to recheck measurements before committing to any expense. 4. We have not tested any apparatus, equipment, fixtures or services and it is in the buyers interest to check the working condition of any appliances. 5. Where an EPC, or a Home Report (Scotland only) is held for this property, it is available for inspection at the branch by appointment. If you require a printed version of a Home Report, you will need to pay a reasonable production charge reflecting printing and other costs. 6. We are not able to offer an opinion either written or verbal on the content of these reports and this must be obtained from your legal representative. 7. Whilst we take care in preparing these reports, a buyer should ensure that his/her legal representative confirms as soon as possible all matters relating to title including the extent and boundaries of the property and other important matters before exchange of contracts.

Brown & Merry is a trading name of Sequence (UK) Limited which is registered in England and Wales under company number 4268443, Registered Office is Cumbria House, 16-20 Hockliffe Street, Leighton Buzzard, Bedfordshire, LU7 1GN. VAT Registration Number is 500 2481 05.

brown & merry



01908 611242



newportpagnell@brownandmerry.co.uk



74A High Street, Newport Pagnell, MILTON
KEYNES, Buckinghamshire, MK16 8AQ



[brownandmerry.co.uk](https://www.brownandmerry.co.uk)