



## Rutland Park, NW2

£2,300 Per Month

Situated in a charming Victorian corner building, this bright top-floor two-bedroom flat features a spacious reception/dining room, separate kitchen, fully tiled bathroom, additional storage, and off-street parking. Conveniently located on Rutland Park, close to the amenities of Walm Lane and excellent transport links via Willesden Green, Kilburn, and Brondesbury stations.

- Well-presented top-floor flat in an attractive Victorian corner building
- Spacious reception room
- Bright fitted kitchen
- Plenty of storage space
- Off street parking
- Transport: Willesden Green (Jubilee-Zone 2)
- COUNCIL: Brent (D)
- Deposit: £2,653



020 8450 9377 - 020 8459 1133  
rentals@cameronsstiff.co.uk



## Rutland Park, NW2

Approximate Area = 61 sq m / 656 sq ft

For Identification only - Not to Scale

EPC: C

Ref: 19753006

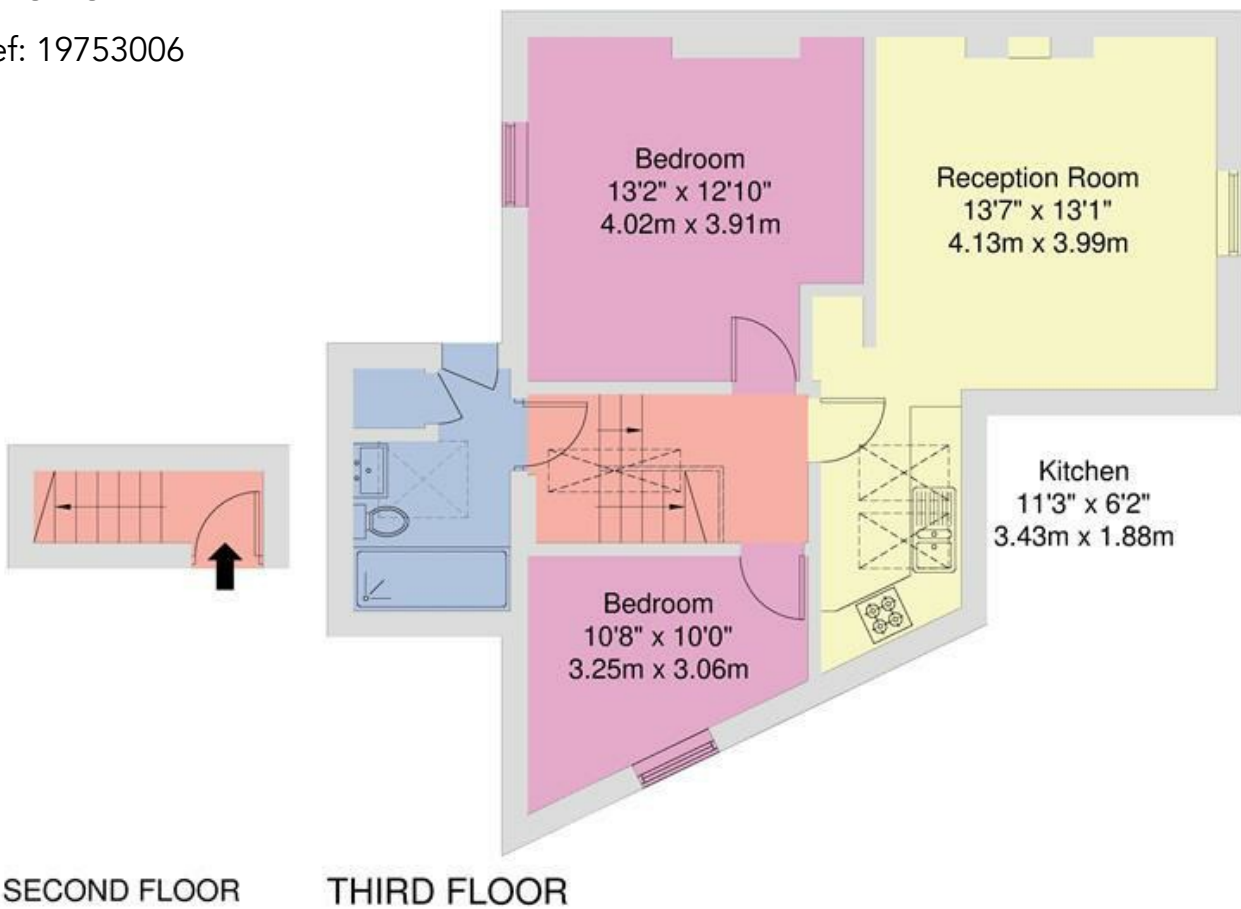

Disclaimer: Floorplan produced in accordance with RICS guidelines. While we do not doubt the floorplan accuracy and completeness, you or your advisors should conduct a careful, independent investigation of the property in respect of monetary valuation. Produced for Camerons Stiff & Co.

