



Knightswood, Manns Close, West End Southampton SO18 3DH

welcome to

Knightswood Manns Close, West End Southampton

* TWO BEDROOM COTTAGE * PRESENTED BEAUTIFULLY THROUGHOUT * MODERN KITCHEN * LOUNGE/DINER * DOWNSTAIRS BATHROOM * DRIVEWAY WITH PARKING FOR FOUR CARS * DESIRABLE LOCATION * CLOSE TO LOCAL AMENITIES & SCHOOLS *

Entrance Hall

Double glazed door to the front aspect, stairs to first floor landing, doors to;

Lounge/Diner

Double glazed window to the front aspect, TV point, 'L' shaped room which opens onto dining area, radiator.

Kitchen

Double glazed window to the front aspect, full high free-standing larder, work surfaces, mixer taps to butler sink, breakfast bar sitting area, range cooker, free standing fridge/freezer, radiator

Bathroom

Double glazed window to the front aspect, 'p' shaped bath with shower above, w/c, wash hand basin, radiator

Landing

Stairs from ground floor entrance hall, loft hatch, doors to;

Bedroom One

Double glazed window to the front aspect, radiator.

Bedroom Two

Double glazed window to the front aspect, radiator.





Situated in the highly sought-after West End, this beautifully presented two bedroom cottage offers a perfect blend of charm, comfort, and convenience. Ideally located within close proximity to local amenities and reputable schools, it makes an excellent choice for first-time buyers, families, or those looking to downsize.

Step inside to discover a welcoming lounge/diner, providing a versatile and cosy living space. The modern fitted kitchen features stylish units and a practical breakfast bar, perfect for casual dining. A contemporary downstairs bathroom completes the ground floor. Upstairs, the property offers two well-proportioned bedrooms, both tastefully decorated and filled with natural light.

Externally, the home continues to impress with attractive front and rear gardens, offering outdoor dining space with kitchen/grill sink & bar to enjoy all year round. A driveway provides convenient off-road parking for up to four vehicles.

Presented beautifully throughout, this delightful cottage is ready to move straight into and enjoy.



view this property online fox-and-sons.co.uk/Property/BIT113284



welcome to

Knightswood Manns Close, West End Southampton

- Two Bedroom Cottage
- Lounge/Diner
- Modern Kitchen with Breakfast Bar
- Downstairs Bathroom
- Driveway

Tenure: Freehold EPC Rating: D

Council Tax Band: C

£320,000

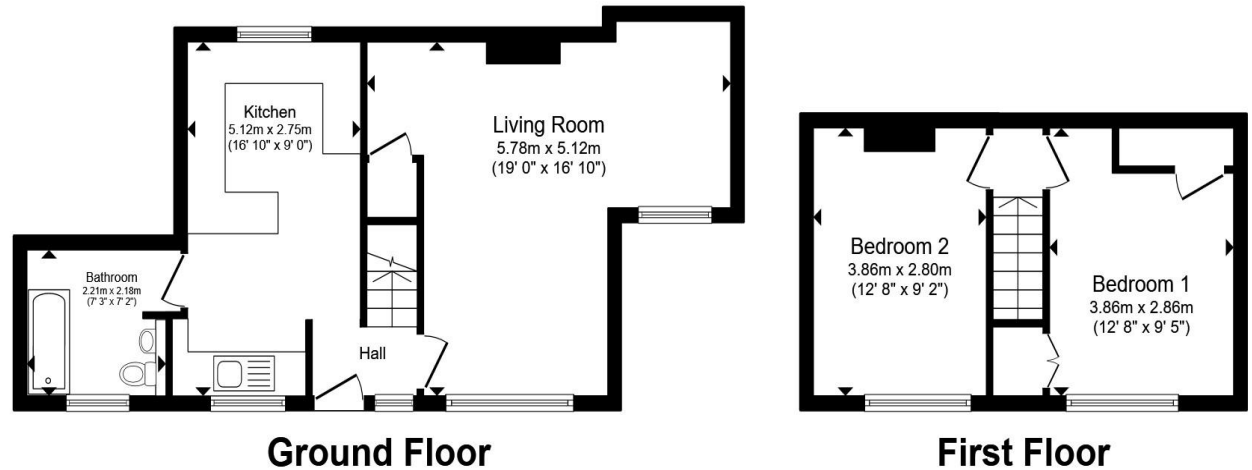

Total floor area 70.7 m² (761 sq.ft.) approx

This floor plan is for illustrative purposes only. It is not drawn to scale. Any measurements, floor areas (including any total floor area), openings and orientation are approximate. No details are guaranteed, they cannot be relied upon for any purpose and they do not form part of any agreement. No liability is taken for any error, omission or misstatement. A party must rely upon its own inspection(s). Powered by www.propertybox.io



view this property online fox-and-sons.co.uk/Property/BIT113284



Property Ref:
BIT113284 - 0007

1. MONEY LAUNDERING REGULATIONS Intending purchasers will be asked to produce identification documentation at a later stage and we would ask for your co-operation in order that there is no delay in agreeing the sale. 2. These particulars do not constitute part or all of an offer or contract. 3. The measurements indicated are supplied for guidance only and as such must be considered incorrect. Potential buyers are advised to recheck measurements before committing to any expense. 4. We have not tested any apparatus, equipment, fixtures or services and it is in the buyers interest to check the working condition of any appliances. 5. Where an EPC, or a Home Report (Scotland only) is held for this property, it is available for inspection at the branch by appointment. If you require a printed version of a Home Report, you will need to pay a reasonable production charge reflecting printing and other costs. 6. We are not able to offer an opinion either written or verbal on the content of these reports and this must be obtained from your legal representative. 7. Whilst we take care in preparing these reports, a buyer should ensure that his/her legal representative confirms as soon as possible all matters relating to title including the extent and boundaries of the property and other important matters before exchange of contracts.

Fox & Sons is a trading name of Sequence (UK) Limited which is registered in England and Wales under company number 4268443, Registered Office is Cumbria House, 16-20 Hockliffe Street, Leighton Buzzard, Bedfordshire, LU7 1GN. VAT Registration Number is 500 2481 05.



023 8044 6724



Bitterne@fox-and-sons.co.uk



390c Bitterne Road, Bitterne, SOUTHAMPTON,
Hampshire, SO18 5RS



fox-and-sons.co.uk