



**Greenfield Road, Newport Pagnell, MK16 8DB**

**welcome to**

## **Greenfield Road, Newport Pagnell**

Located on the popular Greenfield Road in Newport Pagnell, this well-presented two-bedroom terraced home offers comfortable and practical living, ideal for first-time buyers, investors or downsizers.

### **Dining Room**

Double-glazed door to the front, fireplace, stairs to the first floor, under stairs storage and radiator. Double-glazed window to the front.

### **Lounge**

Fireplace, carpet, radiator and double-glazed window to the rear.

### **Kitchen**

Fitted kitchen with a mix of wall and base units with work top over, 1.5 stainless steel sink with mixer tap and drainer, space for a range style cooker, chimney style extractor fan. Double-glazed window to the side and double-glazed door leading out to the garden. Open to the rear lobby area with space for a fridge/freezer, dishwasher and a washing machine. Double-glazed window to the side and door to the cloakroom.

### **Cloakroom**

Wall mounted wash hand basin and low-level WC. Radiator and double-glazed obscured window to the rear.

### **First Floor Landing**

Stairs from the ground floor and doors to both bedrooms.

### **Bedroom One**

Built-in storage, wood flooring and radiator. Double-glazed window to the front.

### **Bedroom Two**

Feature fireplace, radiator, wood flooring and access via a ladder to the boarded loft. Double-glazed window to the rear and door to the bathroom.

### **Bathroom**

Fully tiled with a pedestal wash hand basin, low-level WC and a corner bath with a shower screen and shower over. Wood flooring, radiator and double-glazed obscured window to the side.

### **Outside Rear Garden**

Enclosed by fencing the garden is mainly laid to lawn with mature shrub borders, a patio area, a decked area and 2 sheds.

### **Agents Note**

There is an easement on the title, please enquire with the branch.

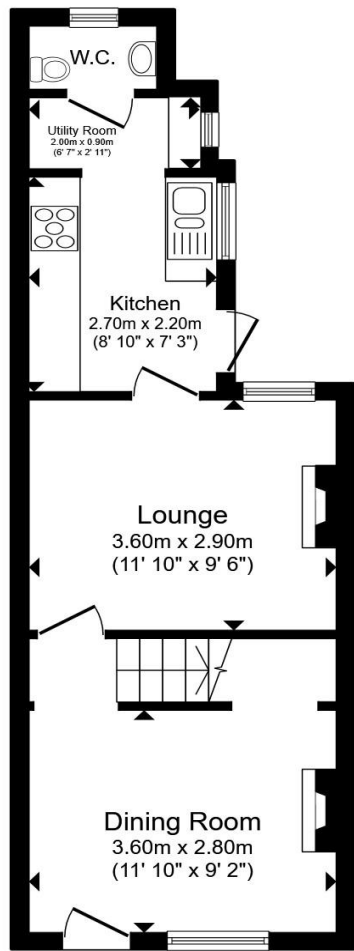

**Ground Floor**

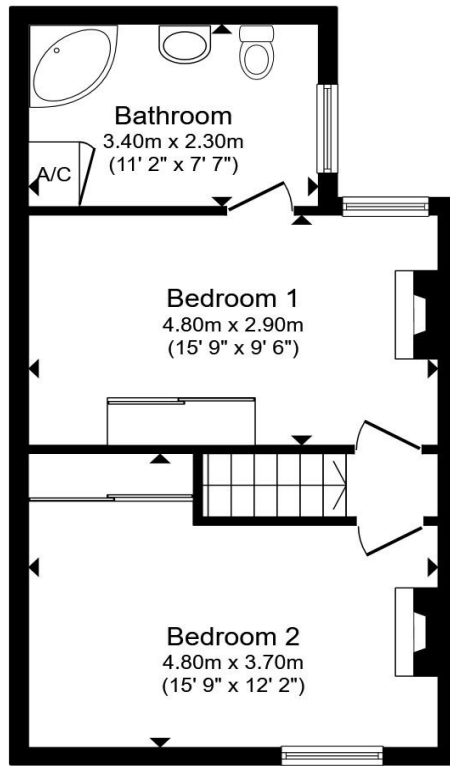

**First Floor**

Total floor area 73.9 m<sup>2</sup> (796 sq.ft.) approx

This floor plan is for illustrative purposes only. It is not drawn to scale. Any measurements, floor areas (including any total floor area), openings and orientation are approximate. No details are guaranteed, they cannot be relied upon for any purpose and they do not form part of any agreement. No liability is taken for any error, omission or misstatement. A party must rely upon its own inspection(s). Powered by [www.propertybox.io](http://www.propertybox.io)



**welcome to**  
**Greenfield Road,**  
**Newport Pagnell**

- TWO-BEDROOM TERRACE
- FAMILY BATHROOM
- PRIVATE REAR GARDEN
- CLOSE TO AMENITIES & SCHOOLS
- EXCELLENT TRANSPORT LINKS

Tenure: Freehold EPC Rating: D  
Council Tax Band: B

**£290,000**



**view this property online** [browndmerry.co.uk/Property/NPL108221](https://www.browndmerry.co.uk/Property/NPL108221)



Property Ref:  
NPL108221 - 0004

1. MONEY LAUNDERING REGULATIONS Intending purchasers will be asked to produce identification documentation at a later stage and we would ask for your co-operation in order that there is no delay in agreeing the sale. 2. These particulars do not constitute part or all of an offer or contract. 3. The measurements indicated are supplied for guidance only and as such must be considered incorrect. Potential buyers are advised to recheck measurements before committing to any expense. 4. We have not tested any apparatus, equipment, fixtures or services and it is in the buyers interest to check the working condition of any appliances. 5. Where an EPC, or a Home Report (Scotland only) is held for this property, it is available for inspection at the branch by appointment. If you require a printed version of a Home Report, you will need to pay a reasonable production charge reflecting printing and other costs. 6. We are not able to offer an opinion either written or verbal on the content of these reports and this must be obtained from your legal representative. 7. Whilst we take care in preparing these reports, a buyer should ensure that his/her legal representative confirms as soon as possible all matters relating to title including the extent and boundaries of the property and other important matters before exchange of contracts.

Brown & Merry is a trading name of Sequence (UK) Limited which is registered in England and Wales under company number 4268443, Registered Office is Cumbria House, 16-20 Hockliffe Street, Leighton Buzzard, Bedfordshire, LU7 1GN. VAT Registration Number is 500 2481 05.

  
brown & merry



**01908 611242**



[newportpagnell@browndmerry.co.uk](mailto:newportpagnell@browndmerry.co.uk)



74A High Street, Newport Pagnell, MILTON  
KEYNES, Buckinghamshire, MK16 8AQ



**[browndmerry.co.uk](https://www.browndmerry.co.uk)**