



West End House, West End Road, Southampton SO18 6PA

welcome to

West End House West End Road, Southampton

BOOK TO VIEW!

Ideally located close to local amenities and with good transport links, we're delighted to welcome to the market this one bedroom flat. Located on the ground floor, the flat features a separate w/c, access to communal gardens, intercom system and a parking space.

Entrance Hall

Door from communal hallway, two cupboards, wood laminate flooring, mobile entry system.

Lounge

16' 9" x 10' 5" (5.11m x 3.17m)

Carpet throughout, double glazed patio doors leading to communal garden, TV point, electric heater.

Kitchen

8' 5" x 10' 5" (2.57m x 3.17m)

Generous worktop space, wall and base cupboard units, built in dishwasher, space for white goods, electric oven and hob, overhead extractor.

Bedroom One

11' 3" x 10' 4" (3.43m x 3.15m)

Carpet throughout, electric heater, double glazed window to the side aspect.

Bathroom

Bath with overhead shower, wash hand basin, w/c, partially tiled walls, laminate flooring.

Separate W/C

W/c, wash hand basin.





Welcome to this fantastic one bedroom ground floor flat, ideally located close to local amenities and schools. As you step inside, you'll find a spacious entrance hall equipped with an intercom system for enhanced security, along with two convenient storage cupboards.

The modern fitted kitchen offers ample storage and worktop space, with room for essential white goods. The spacious lounge/diner is flooded with plenty of natural light, featuring patio doors that lead to the communal gardens. The bedroom is generously sized and provides direct access to the bathroom. Additionally, there is a separate w/c off the entrance hall for added convenience.



Outside, the property boasts well-maintained communal gardens, an allocated parking space, bin store and bike shed. Don't miss the opportunity to make this lovely flat your new home!

The vendor has advised of the following annual charges:

Service charge: £2338.36

Estate charge: £380.58

Ground rent: £85



view this property online fox-and-sons.co.uk/Property/BIT109348



welcome to

West End House West End Road, Southampton

- Ground Floor Flat
- One Bedroom
- Lounge/Diner
- Bathroom & Separate W/c
- Intercom System

Tenure: Leasehold EPC Rating: Awaiting

Council Tax Band: B Service Charge: 2338.36

Ground Rent: 85.00

This is a Leasehold property with details as follows; Term of Lease 155 years from 01 Nov 2004. Should you require further information please contact the branch. Please Note additional fees could be incurred for items such as Leasehold packs.

£150,000

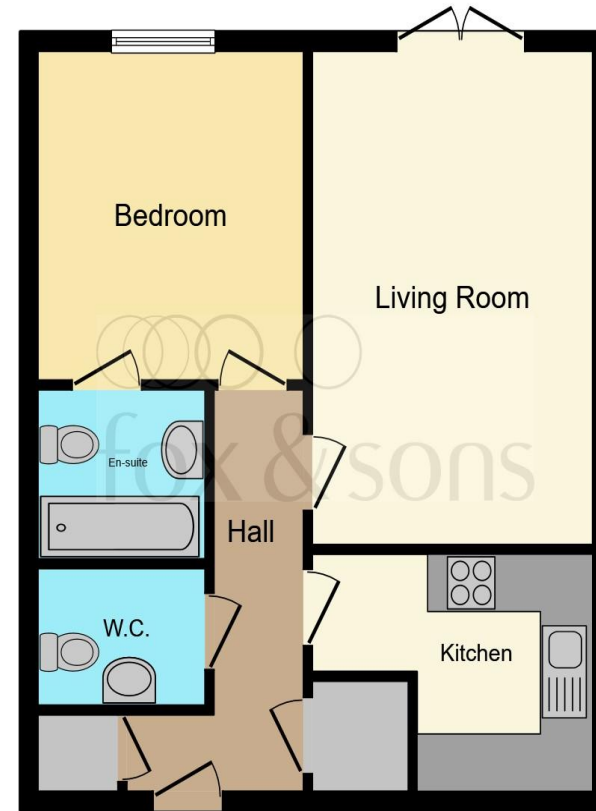

This floor plan is for illustrative purposes only. It is not drawn to scale. Any measurements, floor areas (including any total floor area), openings and orientation are approximate. No details are guaranteed, they cannot be relied upon for any purpose and they do not form part of any agreement. No liability is taken for any error, omission or misstatement. A party must rely upon its own inspection(s). Powered by www.focalagent.com

view this property online fox-and-sons.co.uk/Property/BIT109348



Property Ref:
BIT109348 - 0003

1. MONEY LAUNDERING REGULATIONS Intending purchasers will be asked to produce identification documentation at a later stage and we would ask for your co-operation in order that there is no delay in agreeing the sale. 2. These particulars do not constitute part or all of an offer or contract. 3. The measurements indicated are supplied for guidance only and as such must be considered incorrect. Potential buyers are advised to recheck measurements before committing to any expense. 4. We have not tested any apparatus, equipment, fixtures or services and it is in the buyers interest to check the working condition of any appliances. 5. Where an EPC, or a Home Report (Scotland only) is held for this property, it is available for inspection at the branch by appointment. If you require a printed version of a Home Report, you will need to pay a reasonable production charge reflecting printing and other costs. 6. We are not able to offer an opinion either written or verbal on the content of these reports and this must be obtained from your legal representative. 7. Whilst we take care in preparing these reports, a buyer should ensure that his/her legal representative confirms as soon as possible all matters relating to title including the extent and boundaries of the property and other important matters before exchange of contracts.

fox & sons



023 8044 6724



Bitterne@fox-and-sons.co.uk



390c Bitterne Road, Bitterne, SOUTHAMPTON,
Hampshire, SO18 5RS



fox-and-sons.co.uk